

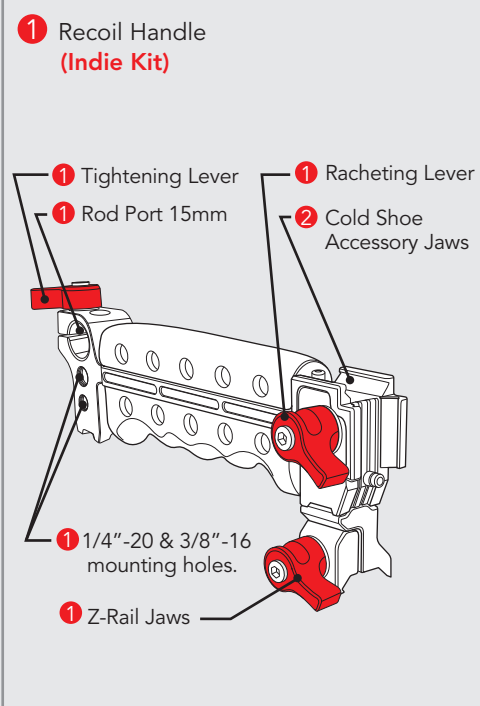

## DSLR Docu and Indie Recoil Kits

The DSLR Kit is a professional solution for operating your DSLR Camera no matter the brand or size. Centered around the Universal VCT Baseplate, this kit allows you to transfer your rig from tripod to shoulder in seconds. This quick releasable Recoil Handle gives you a secure grip and provides numerous options to mount a variety of accessories.

### Parts & Features

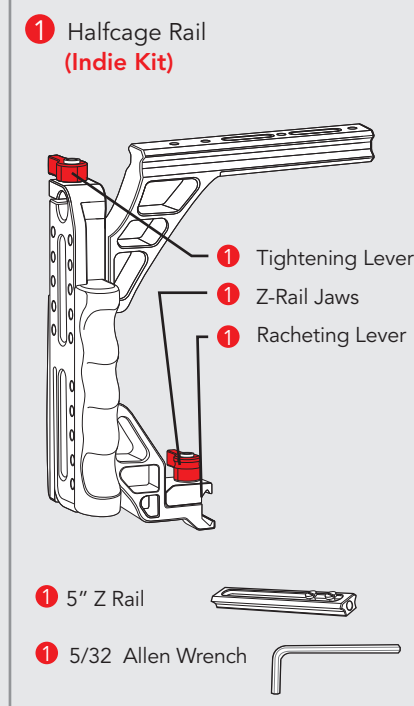
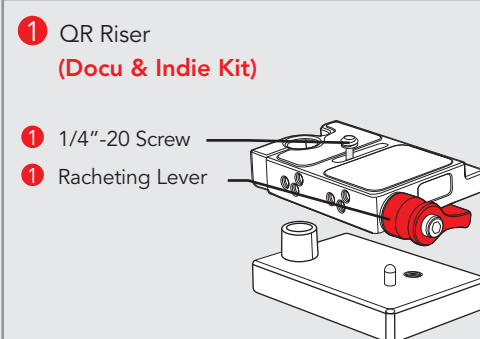
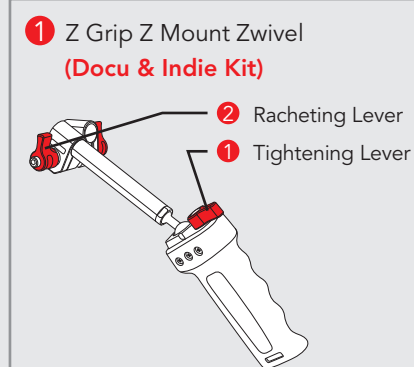
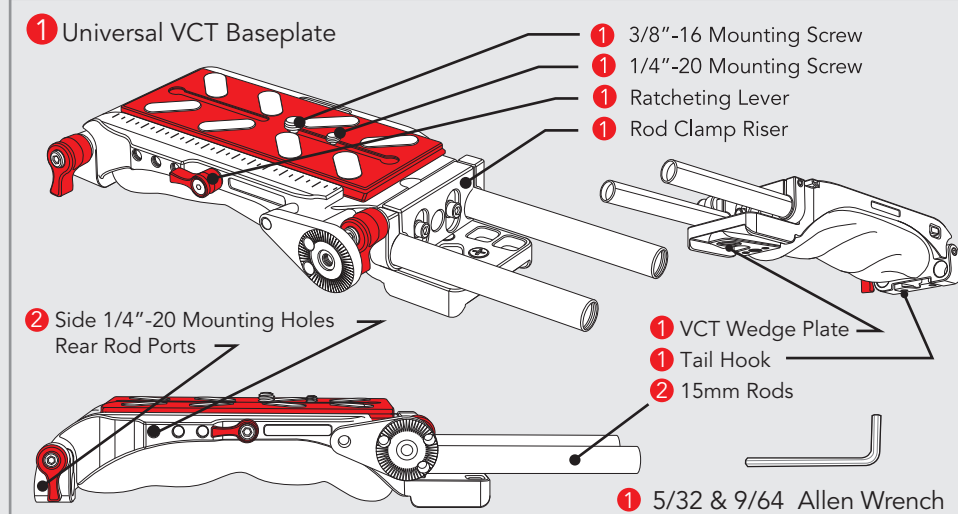

For additional assembly and individual component features, see numerical figures.

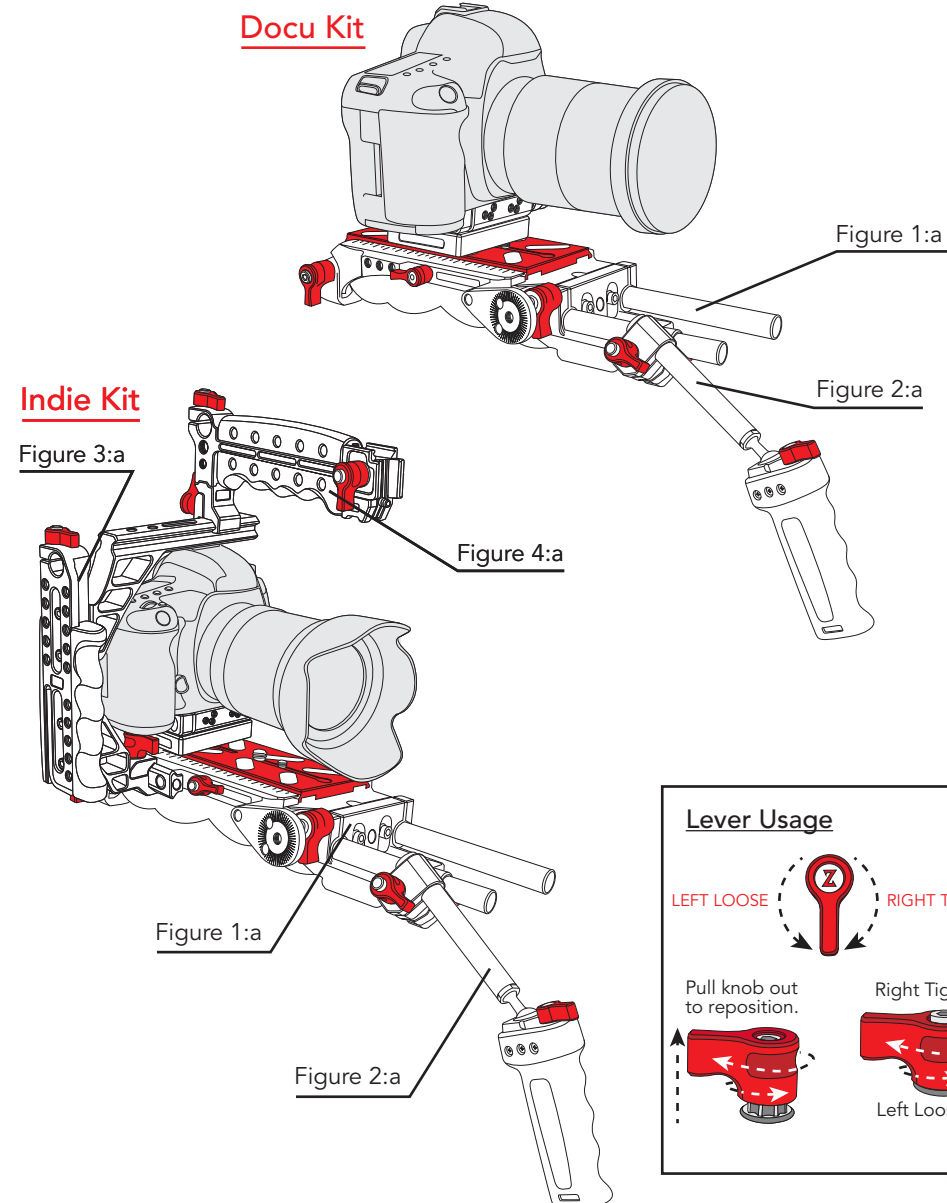

### Figure 1:a Mounting Camera

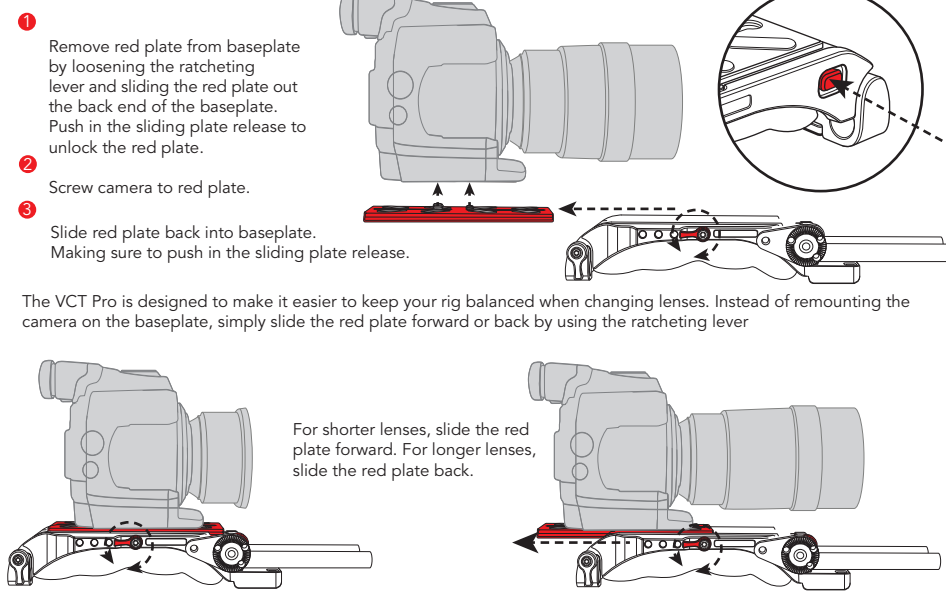

### Figure 1:b Adjusting Rods (Docu & Indie Kit)

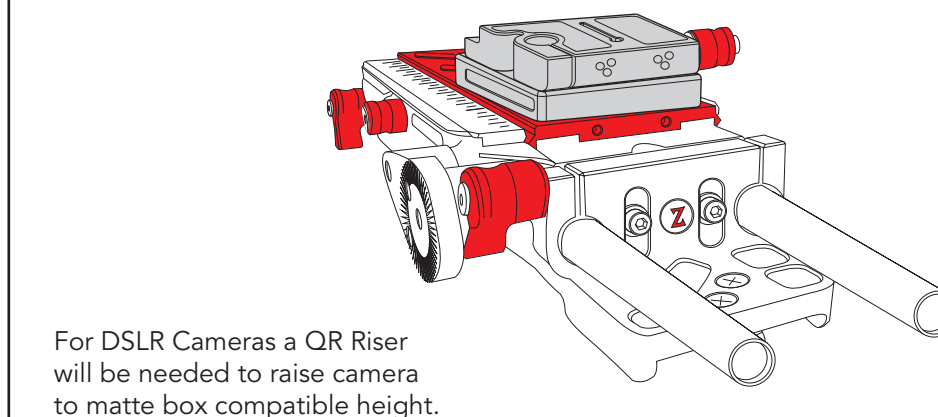

### Figure 1:b Adjusting Rods

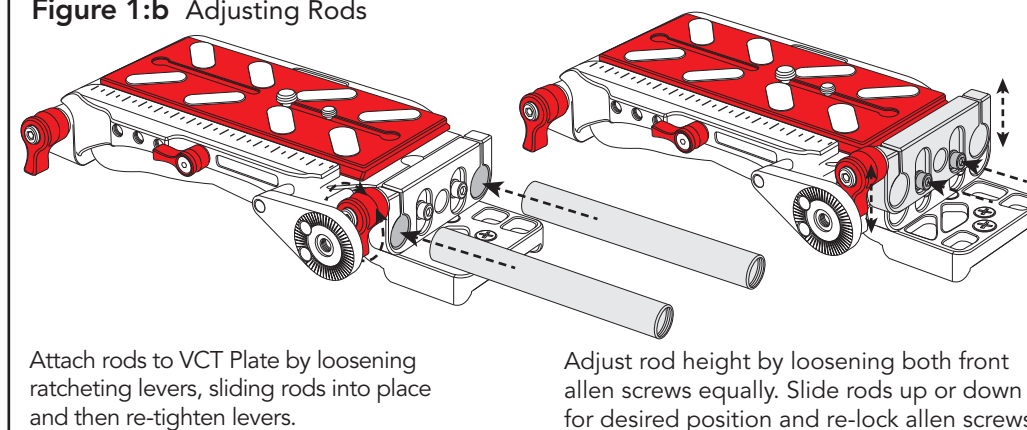

### Figure 1:c Mounting VCT Plate to VCT-14 Tripod Quick Release Plate (VCT-14 Sold Separately)

#### Mounting VCT Pro to VCT-14 (VCT-14 Sold Separately)

Mount VCT Plate to VCT-14 by sliding the front wedge into front slot of the VCT-14 and the tail hook around the rear knob of VCT-14. The VCT-14 will click when the VCT Plate is locked into place

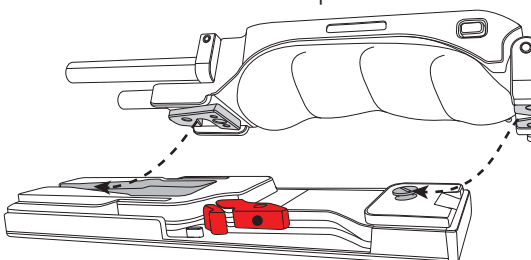

Pull red lever on VCT-14 to release your Universal VCT Plate.

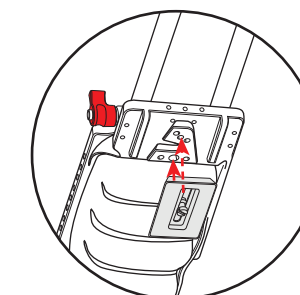

#### Tripod Quick Release Plate

An alternative mounting method when using a tripod without a VCT-14, is to mount your tripod's quick release wedge plate to the wedge on the bottom of the VCT Pro.

**Figure 2:a Operating Z-Grip Z-Mount Zwivel (Docu & Indie Kit)**

To change the angle of the Zwivel 2, loosen levers and rotate. To lock, tighten lever until pins lock into center wheel. Both halves can be independently rotated a full 365 degrees.

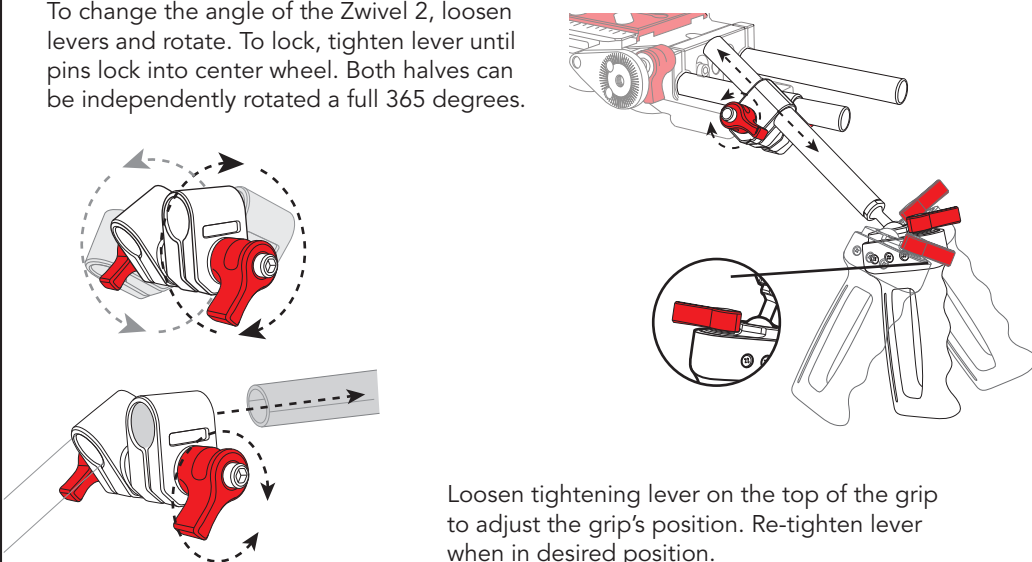

Loosen tightening lever on the top of the grip to adjust the grip's position. Re-tighten lever when in desired position.

**Figure 3:c Operating Half Cage (Indie Kit)**

The rod port on the side of the half cage can be used for Zamerican Arms.

- 1 Loosen top tightening lever and insert Zamerican arm into 15mm rod port.
- 2 Retighten lever when in place.

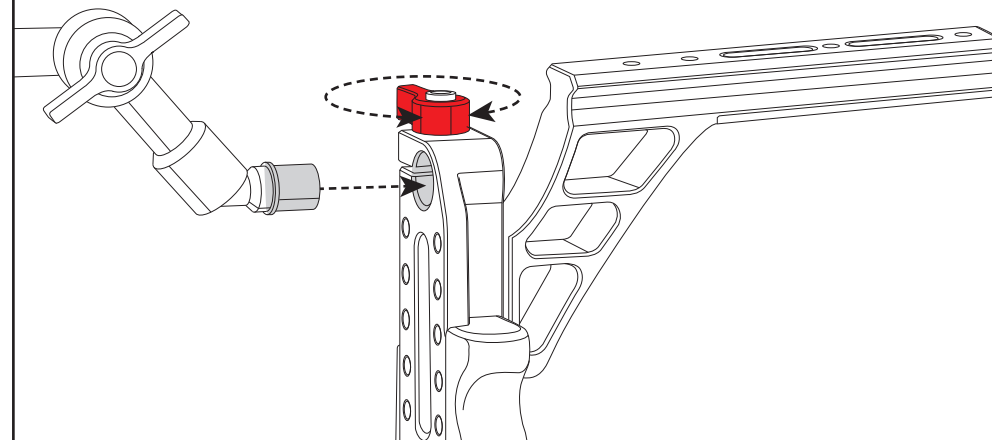

**Figure 4:b Operating your Recoil Handle (Indie Kit)**

Rod lock for Zamerican Arms, EVF Mounts, or 15 mm rods

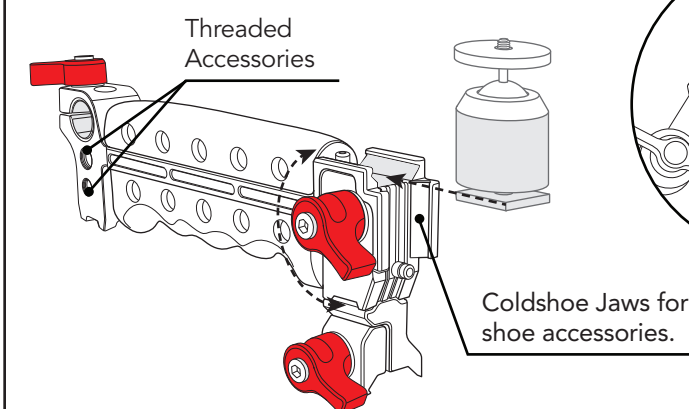

**Figure 3:a Adjusting your Half Cage (Indie Kit)**

Adjust the height of your Half Cage on the handle side with the 5/32 allen wrench.

- 1 Loosen allen screws and slide top rail or Z-Rail jaws to desired position and retighten allen screws.
- 2 For a more extended configuration the bottom allen screws will need to be removed and relocated. (See figure to the right labeled Tall.)

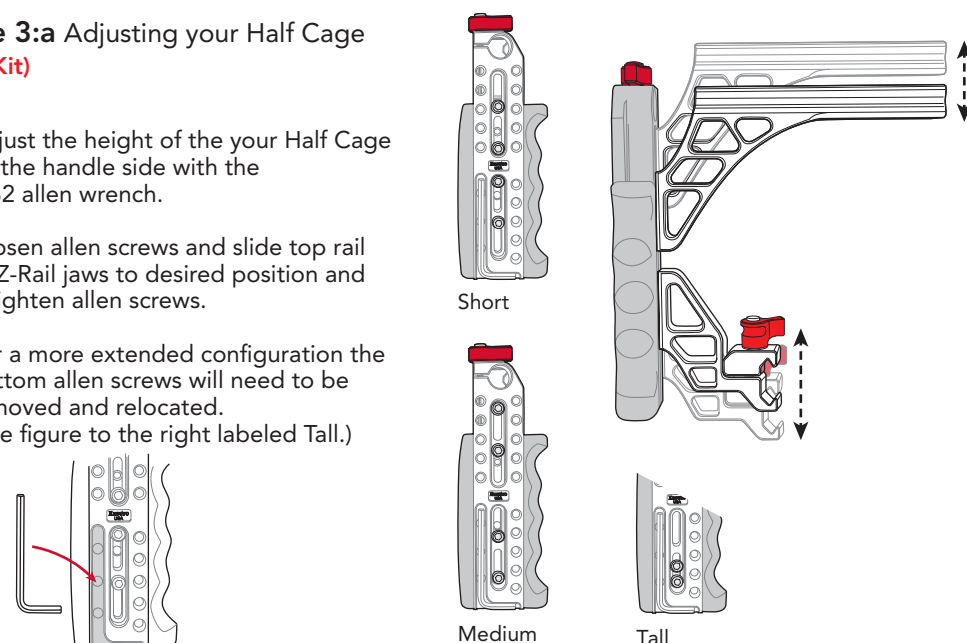

**Figure 4:a Mounting your Recoil Handle (Indie Kit)**

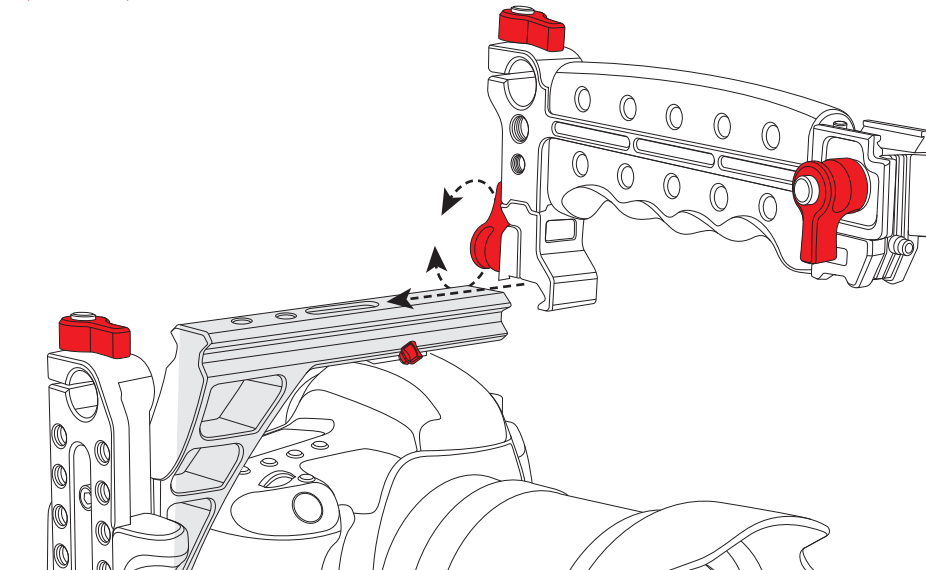

The jaws can be moved to either end of the handle or rotated 90 degrees to help position the handle and/or accessories in a balanced position.

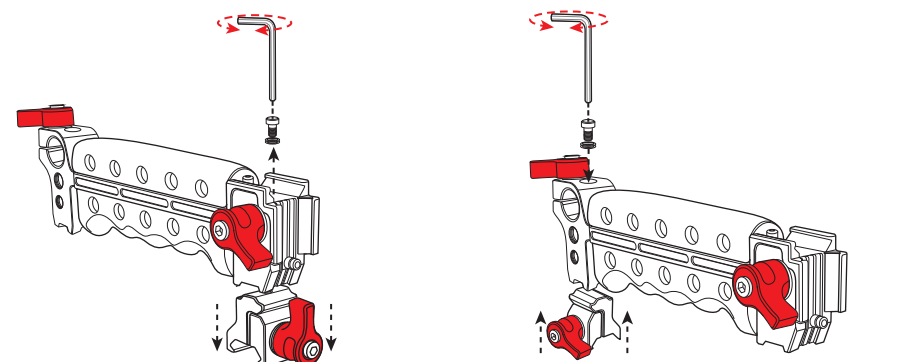

- 1 Remove allen screw and jaws connected to handle.
- 2 Align jaws with rear mount, and tighten allen screw in place.

**Figure 3:b Mounting Half Cage (Indie Kit)**

Mount the Half Cage to the side mounted Z-Rail on your VCT Universal Plate

- 1 Loosen Ratcheting Lever and slide Half Cage jaws onto Z-Rail.
- 2 Retighten ratcheting lever when in desired place.

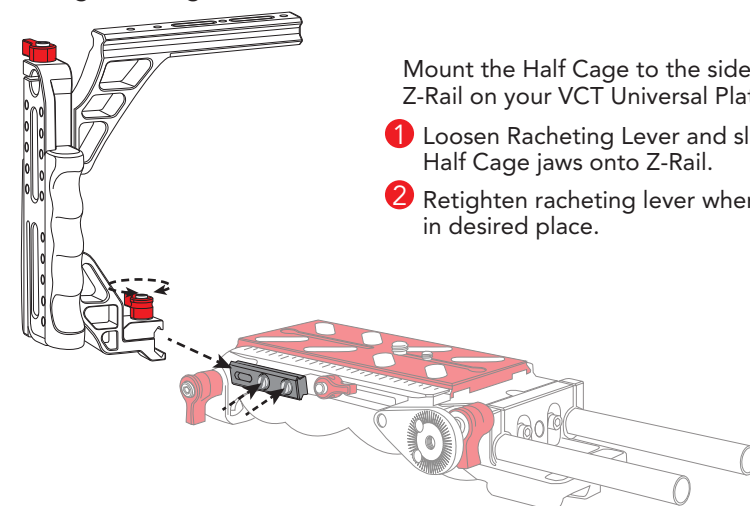

**Additional Recoil Options Sold Separately**

Mounting Axis Mini to Recoil Handle.

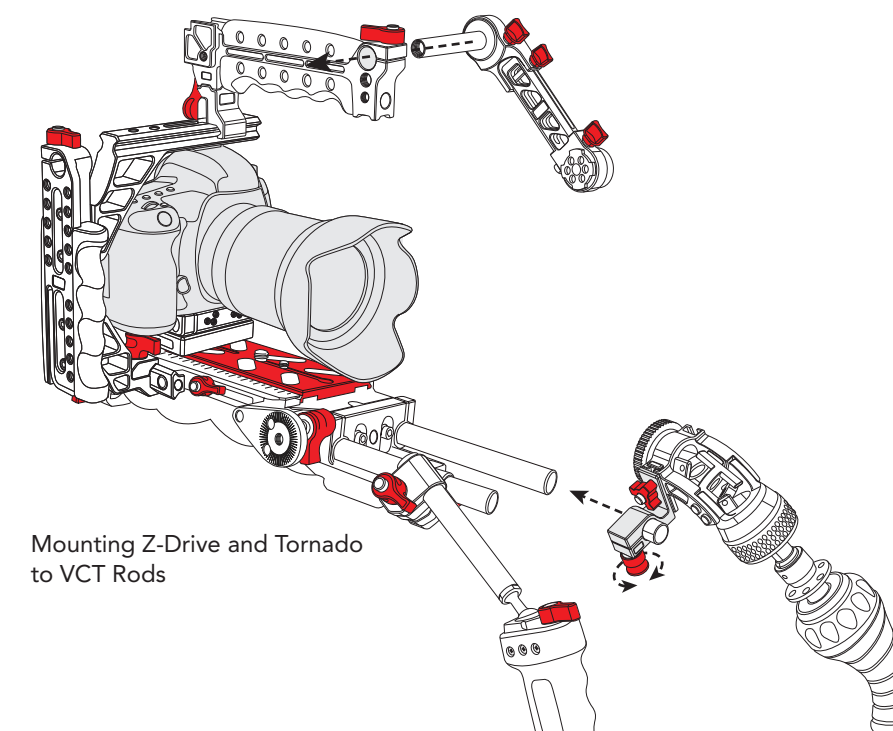

Mounting Z-Drive and Tornado to VCT Rods



See front figure for full correct Assembly  
Check out our tutorial videos at [zacuto.com](http://zacuto.com)  
For additional accessories visit [store.zacuto.com](http://store.zacuto.com)