

# **dji** OSMO ACTION 6

## User Manual

v1.0 2025.11

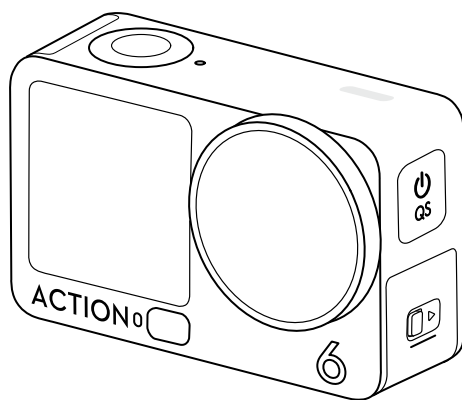



This document is copyrighted by DJI with all rights reserved. Unless otherwise authorized by DJI, you are not eligible to use or allow others to use the document or any part of the document by reproducing, transferring or selling the document. Only refer to this document and the content thereof as instructions to operate DJI products. The document should not be used for other purposes.

In the event of divergence among different versions, the English version shall prevail.

#### **Searching for Keywords**

Search for keywords such as “battery” and “install” to find a topic. If you are using Adobe Acrobat Reader to read this document, press Ctrl+F on Windows or Command+F on Mac to begin a search.

#### **Navigating to a Topic**

View a complete list of topics in the table of contents. Click on a topic to navigate to that section.

#### **Printing this Document**

This document supports high resolution printing.

# Using this Manual

## Legend

⚠ Important

💡 Hints and Tips

📖 Reference

## Read Before Use

DJI™ provides you with tutorial videos and the following documents:

1. *Safety Guidelines*
2. *Quick Start Guide*
3. *User Manual*

It is recommended to watch all the tutorial videos and read the *Safety Guidelines* before using for the first time. Make sure to review the *Quick Start Guide* before using for the first time and refer to this *User Manual* for more information.

## Video Tutorials

Go to the address below or scan the QR code to watch the tutorial videos, which demonstrate how to use the product safely:



<https://www.dji.com/osmo-action-6/video>

# Contents

<b>Using this Manual</b>	<b>3</b>
Legend	3
Read Before Use	3
Video Tutorials	3
<b>1 Product Profile</b>	<b>5</b>
1.1 Overview	6
1.2 Curved Adhesive Base	6
1.3 Osmo 1.5m Extension Rod	8
1.4 Battery Case	9
<b>2 Getting Started</b>	<b>11</b>
2.1 Attaching the Battery and Charging	11
2.2 Activation	12
2.3 Firmware Update	12
<b>3 Using the Product</b>	<b>14</b>
3.1 Button Features	14
3.2 Operating the Touchscreen	15
Setting the Shooting Mode	16
Setting the Shooting Parameters	16
Control Center	18
3.3 Super Slow-Motion	19
3.4 Footage Storage and Transmission	20
Storage Space	20
Transferring Files	21
Transferring Files to a Mobile Device	21
Transferring Files to a Computer	21
3.5 Webcam Mode	22
3.6 Removing/Installing Side Covers	22
3.7 Usage Notes	23
Underwater Usage	23
Battery	25
Cleaning	25
<b>4 Specifications</b>	<b>27</b>

# 1 Product Profile

Accessories may vary depending on the combo and can also be purchased separately. Visit [the official store](#) for a full list of compatible accessories.

Accessory	Osmo Action 6 Standard Com- bo	Osmo Action 6 Adventure Combo
Osmo Dual-Direction Quick-Release Adapter Mount (hereinafter referred to as "Quick-Release Adapter Mount")	✓	✓
Osmo Action Curved Adhesive Base (hereinafter referred to as "Curved Adhesive Base")	✓	✓
Osmo Multifunctional Battery Case 3 (hereinafter referred to as "Battery Case")	-	✓
Osmo 1.5m Extension Rod	-	✓

# 1.1 Overview

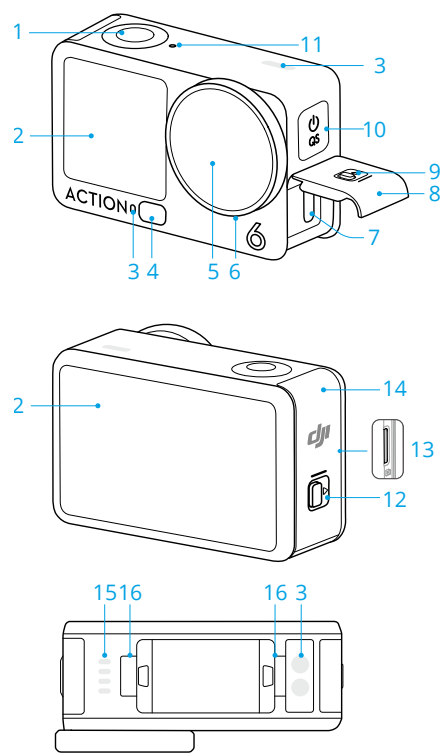

- 1. Shutter/Record Button
- 2. Touchscreen
- 3. Microphone
- 4. Color temperature sensor
- 5. Lens
- 6. Lens Protective Cover
- 7. USB-C Port
- 8. USB-C Port Cover
- 9. USB-C Port Cover Release Button
- 10. Power/Quick Switch Button
- 11. Pressure Sensor
- 12. Battery Compartment Cover Release Button
- 13. microSD Card Slot
- 14. Battery Compartment Cover
- 15. Speaker
- 16. Quick-Release Slot

# 1.2 Curved Adhesive Base

The camera can be securely mounted on smooth and clean curved surfaces using the Curved Adhesive Base.

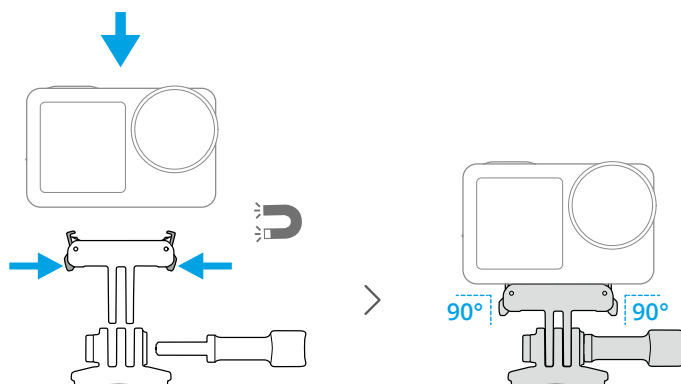

- ⚠ • Press down on the camera until the clips of the quick-release adapter mount are firmly inserted into the quick-release slots on the camera, and then tighten the locking screws. Press both clips of the quick-release adapter mount when removing the camera.
- Attach and press the adhesive base down firmly, and hold for at least 10 seconds. It is recommended to wait 30 minutes before attaching the camera.
- The adhesive base can only be applied to clean curved surfaces once. DO NOT attach the adhesive base to surfaces that are flat, rough, powdered, peeling, covered in dust or sand, or have oil, wax, or water stains. Otherwise, the adapter mount may not be attached firmly.
- The recommended application temperature for the adhesive base is -10° to 40° C (14° to 104° F). DO NOT attach the adhesive base to a surface with a higher or lower temperature.

## 1.3 Osmo 1.5m Extension Rod

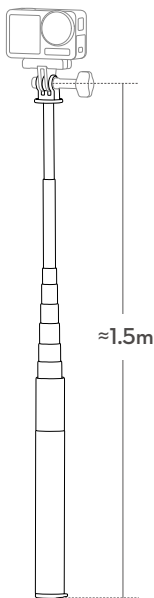

- 
- ⚠ • DO NOT drop or strike the extension rod in any way when in use to avoid damage.
- DO NOT shake the extension rod violently when installed with the camera to avoid damage.
  - Rinse with clean water to remove sand after underwater usage.
  - DO NOT use the extension rod during thunderstorms to avoid lightning strikes.
-



## 1.4 Battery Case

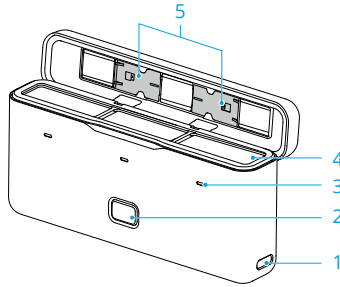

1. USB-C Port
2. Status Button

Press once to check the battery level.

3. Status LEDs

### Battery Level

Solid red	0-20%
Solid yellow	20%-80%
Solid green	80%-100%

### Charging and Discharging Status

Off	The battery in the corresponding battery port is fully charged or discharged.
Breathing	The corresponding battery is charging.
Blink green successively	No battery is inserted.
Blinks red	Abnormal battery is inserted into the corresponding battery port.

4. Battery Ports
5. microSD Card Slot



With batteries inserted, the battery case can charge the batteries or external devices such as smartphones.

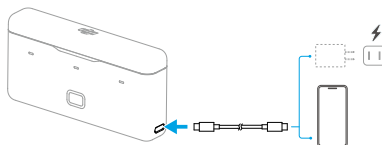

- When charging the batteries, it is recommended to use a USB-C charger that supports PD (Power Delivery) or PPS (Programmable Power Supply). The battery with the highest power level will be charged first.
- When charging external devices, the battery with the lowest power level will be discharged first.



- Place the battery case on a flat and stable surface when in use. Make sure the device is properly insulated to prevent fire hazards.
  - DO NOT touch the metal terminals on the battery ports.
  - Clean the metal terminals with a clean, dry cloth if there is any noticeable buildup.
  - The battery case is not waterproof. DO NOT place it in water or spill any liquid on the case.
-

## 2 Getting Started

### 2.1 Attaching the Battery and Charging

Insert the battery and completely close the cover.

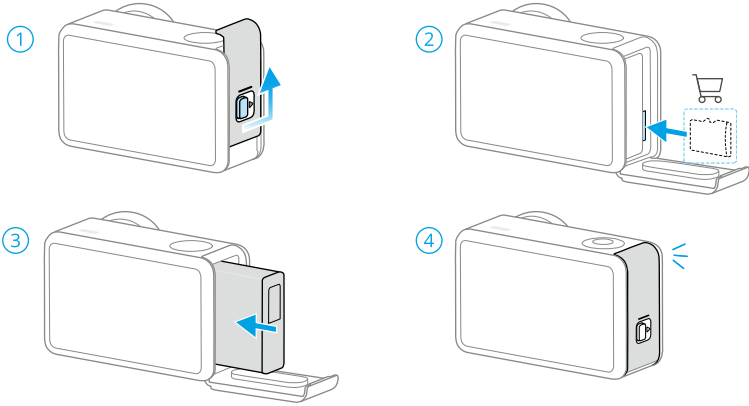

- The camera has 50GB of usable storage and supports microSD cards for storage expansion. Refer to [Specifications](#) for the recommended microSD cards.
- Both side covers on the camera can be removed. For details, see [Removing/Installing Side Covers](#).

It is recommended to use a USB-C charger that supports PD or PPS.

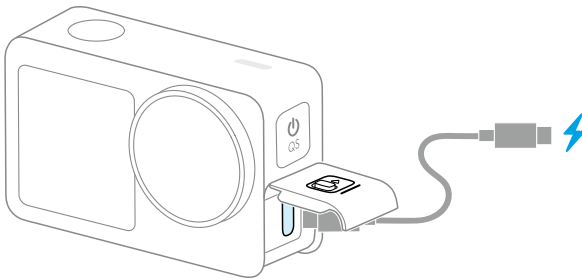

## 2.2 Activation

Make sure to activate the camera using DJI Mimo App before first use.

1. Press and hold the power button to power on the camera.

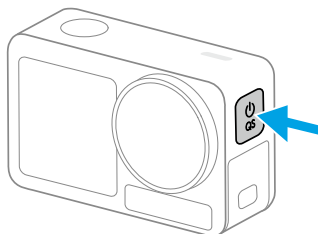

2. Scan the QR code on the screen to download the DJI Mimo App.
3. Enable Wi-Fi and Bluetooth on the mobile device.
4. Launch DJI Mimo App on the mobile device, tap the camera icon to connect to the camera, and then follow the instructions to activate the camera.

When the camera is used with the DJI Mimo App, you can monitor the current camera view, set the camera parameters, and control the camera with a mobile device.

- 
- To check the Android and iOS operating system versions supported by the app, visit <https://www.dji.com/downloads/djiapp/dji-mimo>.
  - The interface and functions of the app may vary as the software version is updated. Actual user experience is based on the software version used.
- 

⚙️ If there is a problem when connecting to DJI Mimo App, follow the steps below:

1. Make sure both Wi-Fi and Bluetooth are enabled on the mobile device.
  2. Make sure the DJI Mimo App has the latest firmware version.
  3. In the liveview on the camera, swipe down from the top of the screen and tap **⚙️ > Wireless Connection > Reset Connection**. The camera will reset all connections and Wi-Fi passwords.
- 

## 2.3 Firmware Update

A prompt will appear in DJI Mimo App when new firmware is available. Tap the prompt and follow the on-screen instructions to update the firmware.

---

⚙️ If the update fails, follow the steps for troubleshooting.

1. Restart the camera and DJI Mimo App.

2. Enable Wi-Fi and Bluetooth on the mobile device.
3. Connect the camera to DJI Mimo App and try the update again.

Contact DJI Support if the update fails again.

---

## 3 Using the Product

### 3.1 Button Features

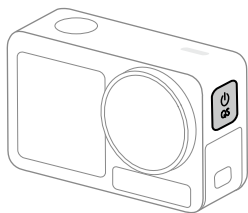

#### Power/Quick Switch Button

- Press and hold: Power on/off.
- In the liveview: Press once to enter the Quick Switch page. Press again to cycle through preset shooting modes\*.
- \* To modify the presets, tap **•••** in the upper right corner of the Quick Switch page.
- During video or slow motion video recording: Tap the icon to mark "highlights", helping to quickly locate specific moments during post-editing, reducing the time to find highlights.
- On other pages: Press once to return to the liveview.

#### Shutter/Record Button

##### When powered on

- Press once: Take a photo or start/stop recording.
- **Shutter/Record Button Protection** is enabled automatically when the camera dives to 14 m\* or deeper. In this mode, press the Quick Switch button once to take a photo or start/stop recording, and double-press to enter the Quick Switch page. After surfacing, follow the on-screen instructions to exit protection mode and restore normal button functions.

\* The depth may vary depending on water conditions and device status; 14 m is for reference only.

##### When powered off

Press once: Power on and start recording (SnapShot).

Press again to stop recording. After shooting, the camera will automatically power off if left idle for three seconds.

- \* SnapShot is the quickest way to start shooting and never miss a moment of the action. By default, SnapShot applies the last used shooting settings. To modify, enter the Control Center and tap **ⓘ** > SnapShot.

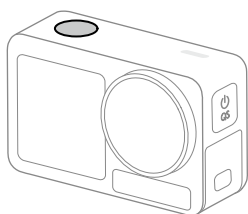

## 3.2 Operating the Touchscreen

After the camera powers on, the touchscreen shows the liveview.

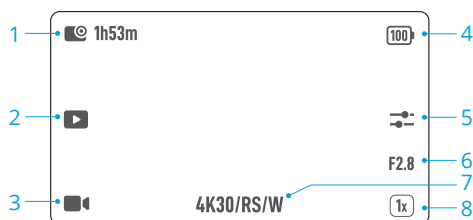

### 1. Storage Capacity/Remaining Recording Time

### 2. Playback

The touchscreen displays the last photo or video captured or played back.

During playback, you can tap the  icon to mark “highlights”, helping to quickly locate specific moments during post-editing, and reducing the time to find highlights. The marked “highlights” can be viewed during playback in DJI Mimo App.

-  • When playing back the video, long press any blank area on the screen to play at double speed.
- During playback, swipe left from the right edge of the screen to return to the liveview.

### 3. Shooting Mode

### 4. Camera Battery Level

### 5. Image/Audio Parameters

### 6. Aperture Value

### 7. Shooting Specifications

### 8. Zoom

Zoom adjustment is available in certain shooting modes.

-  • With Osmo Action 6 Macro Lens installed, Zoom is disabled. You can rotate the focus ring to manually focus on much closer subjects.

## Setting the Shooting Mode

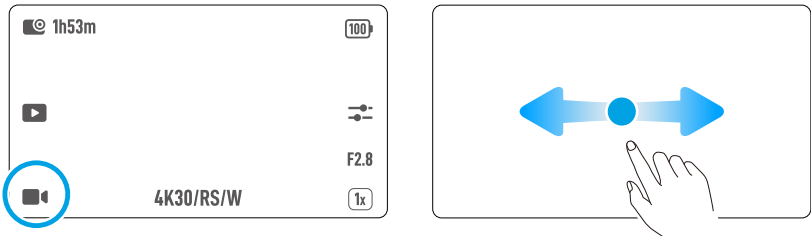

1. Tap the icon or swipe left or right on the screen to enter the mode switch page.
2. Swipe to select a shooting mode.

 Slow-motion videos do not include audio. The audio file is stored as a standalone file and has the same path as the video file, which can be transferred to your computer.

3. Tap the selected shooting mode or swipe up from the bottom of the screen to return to the liveview.

## Setting the Shooting Parameters

Various parameters can be set in different shooting modes. Refer to the actual interface.

1. Swipe up from the bottom of the screen to set the parameters for each shooting mode.

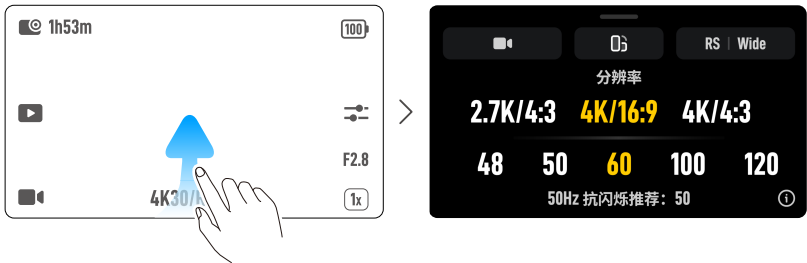

 In video mode, tap the upper left corner to enable Pre-Rec or Loop Recording. Tap the upper right corner to set the EIS mode and Field of view (FOV).

- **Pre-Rec:** When enabled, the camera will pre-record footage within the set time duration. Once the shutter/record button is pressed, the camera will save the latest pre-recorded footage before pressing the shutter/record button and keep recording, then save the footage as a whole video. This



function allows the camera to save the footage before pressing the shutter/record button to avoid taking up too much storage space, helping capture highlights (especially for fishing).

- **Loop Recording:** When enabled, the camera records a video by overwriting older footage with new footage at selected time intervals. This function allows the camera to save storage space, and is suitable for use in scenes where the user is waiting to capture unanticipated highlights (such as when driving).
- **Aspect Ratio:** The default setting is Auto, but it can also be set to Custom. This setting allows you to capture 4K videos and crop the videos to ratios like 16:9 or 9:16 in post-editing, fitting different media platforms.
- **EIS (Electronic Image Stabilization) mode:**
  - Off: Records the video with the largest FOV.
  - RockSteady: stabilizing footage while retaining the dynamics of movement, which is suitable for first-person perspective shooting.
  - RockSteady+: Compared with RockSteady, the edges of these images will be reduced slightly to obtain a stronger stabilization performance.
  - HorizonBalancing: This mode reduces the shaking of images within  $\pm 45^\circ$  horizontally, while preserving high-resolution image quality.
  - HorizonSteady: Eliminates roll axis jitters within  $360^\circ$ . It ensures that the image remains level and stable even in scenarios involving intense bumps or turns.



To record videos with Gyro data, disable EIS Mode and set the camera FOV to **Wide**.

---

Once you have set the parameters, swipe down from the top of the screen to return to the liveview.

2. In the liveview, tap  to adjust image and audio parameters. Tap **PRO** to adjust pro parameters.



- Tap **Variable Aperture** to select the appropriate aperture mode based on your shooting environment. Various aperture modes can be set in different shooting modes. Visit the official website for more information.
  - D-Log M is designed for professional color grading when post-editing. In high-contrast or multi-color scenarios (e.g., garden, field, etc.), it can enlarge the dynamic range for more color-grading in post-production.
-

## Control Center

Swipe down from the top of the screen to enter the control center. Swipe up from the bottom of the screen to return to the liveview.

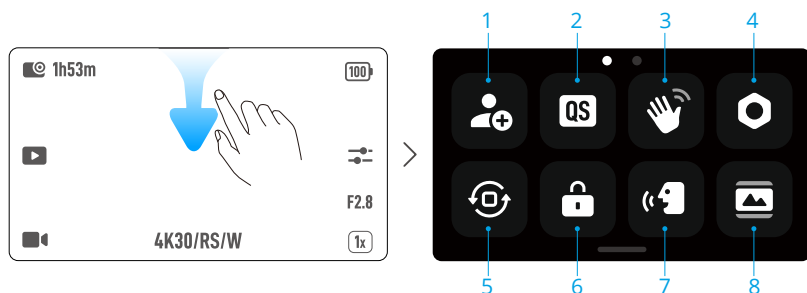

### 1. Custom Modes

Save the current shooting settings as a custom mode and select a scene. Custom modes can then be used directly to shoot similar scenes.

### 2. Quick Switch

Set the modes accessible with the Quick Switch button. When the function of the Quick Switch button is set mode switching, you can customize the quick switch modes in the Shooting Mode menu, and enable/disable Voice Prompt when switching modes.

 When Voice Prompt is enabled, the camera announces the current shooting mode each time you press the Quick Switch button. When the camera is installed on a helmet or other hard-to-see locations, users can accurately select the required mode with Voice Prompt.

### 3. Gesture Control

When enabled, you can use hand gestures to take photos or start/stop recording.

### 4. Settings

#### • Wireless Microphone

Follow the on-screen instructions for linking. Once linked, you can use the transmitter to control the camera to start recording, with the audio being captured by the transmitter. When the transmitter is linked to the camera, tap Wireless Microphone settings to adjust the audio parameters of the transmitter.

The camera can connect to two DJI wireless microphone transmitters simultaneously. Visit the DJI website and refer to the user manual of the mic product for more information.

#### • Wireless Earbuds

Make sure the earbuds are in pairing status. When the device name appears in the list, tap to connect. Once connected, the camera records videos using the audio captured by the earbuds.

\* The wireless earbuds only supports recording and cannot be used for audio playback.

- **Depth & Altitude**

When the related settings of depth or altitude are enabled, the recorded video will include depth or altitude information. The recorded data can also be added to the video footage in a visualized form using the dashboard feature on the DJI Mimo App app, which can better showcase exciting sports moments.

- **Built-in Mic Audio Backup**

When recording with wireless microphones, users can enable the Built-in Mic Audio Backup feature, which records simultaneously from the camera's microphone. This backup audio can be saved either as a separate .aac file or as an extra audio track embedded in the video file.

- **Timecode**

Either reset the timecode or sync with the system time. The camera timecode can be synchronized by a time code synchronizer using the USB-C port.

Tap **Timecode Display** to display the time code in the liveview.

5. **Orientation Lock**

6. **Screen Lock**

7. **Voice Control**

Enable Voice Control to control the camera with voice commands.

Simplified Chinese and English are supported. Refer to the on-screen interface for a full list of commands.

8. **Full Front Screen**

## 3.3 Super Slow-Motion

The super slow-motion feature enables frame-by-frame analysis of the footage and generate slow-motion videos. The feature is particularly suitable for showcasing stunning and exciting moments in high-speed sports scenes such as cycling and skiing.

When playing back a video, select a specific point and tap the  icon to generate a super slow-motion video clip. During the generating process, you can tap **Preview** to preview the slow-motion effect.

You can tap **Cancel** to stop the generation of the super slow-motion clip during the process. To delete a super slow-motion clip, tap the  icon in the upper right corner when playing back the video.

- 
-  The camera performs 4x frame interpolation, allowing the camera to generate slow-motion videos at up to 960fps.
  - Up to 6 super slow-motion clips can be added to a single video footage.
  - Super slow-motion is only supported for 4K/2.7K/1080p 16:9 video footage with a frame rate of no less than 100fps. The generated super slow-motion videos will all be in 1080p format.
  - The first 1.5 seconds and the last 2 seconds of the video do not support generating super slow-motion clips.
- 

### 3.4 Footage Storage and Transmission

#### Storage Space

Swipe down from the top of the screen, and then swipe left to check the storage information.

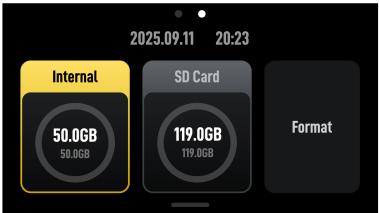

The camera has built-in storage and also supports expanding storage by installing a microSD card.



Tap **Storage** to format the internal storage or the microSD card.

- 
- ⚠ Formatting will permanently delete all data. Make sure to back up all required data before formatting.
-

## Transferring Files

- 
- When transferring files by cables, if the camera cannot automatically recognize the connected device, enter the control center, tap  > **USB mode**, and reconnect the camera.
- 

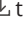
### Transferring Files to a Mobile Device

- Connect the camera to DJI Mimo App, tap the album icon to preview photos and videos. Click  to download photos and videos.
- For mobile devices that support OTG connection, the files can be transferred with USB mode. Use the provided cable to connect the camera to the mobile device. When connected, view and transfer photos and videos via the device album or file manager.
- For Android devices that support the Mutual Transfer Alliance (MTA) protocol, the files can be transferred using the Sharing feature. Ensure the phone supports the MTA protocol and the necessary permissions are enabled before use. Select your files in the album, tap , and follow the on-screen instructions.

The photos and videos can be shared directly from DJI Mimo App to social media platforms.

### Transferring Files to a Computer

Power on the camera and connect it to a computer using a USB-C cable. When connected to a computer, a pop-up will appear. Tap **Transfer File: USB** to download the files from the camera to the computer. When transferring a file, the camera cannot take photos or record videos.

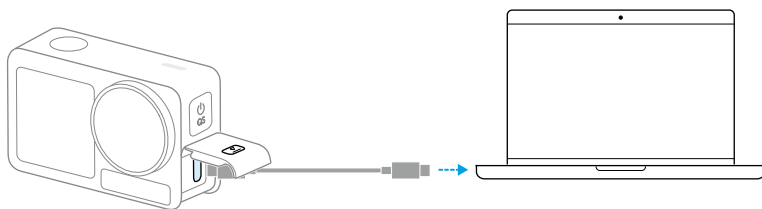

- 
- Reconnect the device to the computer if a file transfer is interrupted.
-

### 3.5 Webcam Mode

The product can work as a webcam on a computer. Power on the product and connect it to the computer using a USB cable. Tap **Webcam** on the camera to enter the Webcam mode, and the camera will function as a webcam input device. The bottom of the screen displays Webcam.

Press the Shutter/Record button to start recording. Users can preview recorded videos after exiting the Webcam mode.

### 3.6 Removing/Installing Side Covers

Both side covers on the camera can be removed. The battery compartment cover is used as an example in the illustrations.

#### Removing

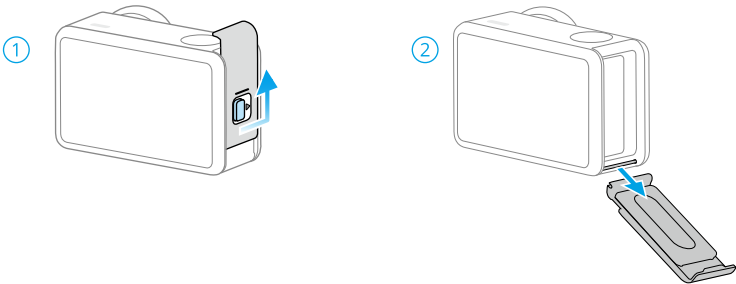

#### Installing

Make sure the cover is released and the red mark is exposed. Align the slot on the cover with the mounting post on the camera.

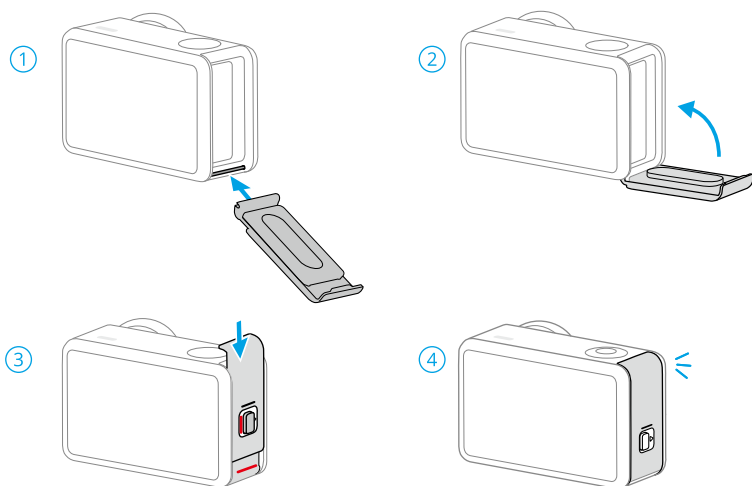

## 3.7 Usage Notes

### Underwater Usage

- ⚠ • The product can be used underwater at depths of up to 20 m.
- When used with the Osmo Action 6 Waterproof Case, the product can be operated underwater up to 60 m deep.

Observe the following precautions **before using the product in water**.

1. Make sure the battery and battery compartment are dry and clean before inserting the battery. Otherwise, it may affect the battery contact and waterproofing ability. Make sure the battery compartment cover is firmly fastened after the battery is inserted. Note that the red marks should not be visible after the cover is properly fastened.
2. Make sure the USB-C port cover, and lens protective cover are firmly mounted and fastened, and that the waterproof seal is clean. Otherwise, it will affect the device waterproofing ability. All the holes on the product use a built-in waterproof material. **DO NOT** poke the holes.
3. Check if the lens protective cover is in good condition. If damaged, replace it immediately. Make sure the lens protective cover and lens are dry and clean. Sharp or hard objects may damage the lens and affect the ability of the camera. Make sure that

the lens protective cover is firmly mounted and the rubber ring at the base of the lens is not detached.

4. The product is NOT waterproof when used with Osmo Action 6 Macro Lens.

Observe the following precautions **when using the product in water**.

1. Avoid jumping into water at high speed with the product. Otherwise, the impact may result in water seepage.
2. DO NOT use the product in hot springs, corrosive liquids, or extreme underwater environments.

Observe the following precautions **after using the product in water**.

1. Rinse the camera with tap water after using it underwater. Allow it to dry naturally before using again. Wipe the surface of the camera with a soft and dry cloth.
2. DO NOT dry the camera with hot air using a hair dryer, otherwise the microphone membrane and the built-in breathable membrane will rupture, and the camera will no longer be waterproof.
3. After using the camera in water, open the battery compartment cover facing downward to prevent water from entering the gaps in the battery compartment if you need to replace the battery. Wipe off any water droplets in the gaps of the battery compartment and clean the red waterproof rubber ring to prevent any foreign objects from remaining. Otherwise, it will affect the waterproof performance during subsequent use.
4. When changing the lens protective cover, make sure the camera is dry. After using the camera in water, let it dry before using it again. This will prevent water from seeping into the lens protective cover, allowing for the lens to fog up.

Observe the following precautions **when using the product with the waterproof case**:

1. Make sure the rubber seal is clean and firmly secured during use.
2. Make sure the waterproof case is dry (for best results, place an anti-fog fiber in the case during use) and that the latch is secure.
3. Before use, it is recommended to place the waterproof case underwater for approximately 5 minutes to ensure it is working properly.
4. Rinse the case with tap water to prevent corrosion after using it in the sea.



- The touchscreens can be used when the surface is wet.
- The touchscreens do not function when fully submerged underwater. Users can press the camera buttons to start recording. The Shutter/Record button is



disabled automatically when the camera is used without a waterproof case at a depth of more than 14 m.

## Battery

1. DO NOT use non-official batteries. DJI takes no responsibility for any damage caused by non-official batteries.
2. Use the battery within the temperature range specified at <https://www.dji.com/osmo-action-6/specs>. Use of the battery in a high-temperature environment can lead to a fire or explosion. Before using the battery in a low-temperature environment, it is recommended to charge the battery fully in a normal temperature environment. Charging the battery at the ideal temperature can prolong battery life.
3. Discharge and charge the battery completely once every three months to keep it in good condition.
4. The battery is designed to stop charging when it is fully charged. It is good practice to monitor the charging progress and disconnect the charger when battery is fully charged.
5. When the battery voltage is too low, the battery will enter low-power state. Charging the battery will exit low-power mode.
6. DO NOT store the battery for an extended period of time after fully discharging. Otherwise, the battery may over-discharge and cause irreparable damage to the battery cell.
7. Discharge the battery to 40-65% if it will not be used for 10 days or more. This can greatly extend the battery life.

## Cleaning

1. DO NOT spill any liquids containing alcohol or cleansing solution on the camera.
2. If the holes of the microphone, heat dissipation slots, or other parts of the camera are blocked by sand or other foreign matter, rinse with fresh water while the camera is in a sealed waterproof state.
3. Clean the lens protective cover with water or a lens cleaning pen, lens air blower, or lens cleaning cloth. DO NOT remove the lens protective cover frequently to avoid dust accumulating inside the lens cover, which can affect shooting quality.
4. Clean the lens with a lens cleaning pen, lens air blower, or lens cleaning cloth.
5. Clean the battery and battery compartment with a clean, dry cloth.

6. Make sure the quick-release slots on the camera are clear of dust and sand when attaching the Quick-Release Adapter Mount.

## 4 Specifications

Visit the following website for specifications.

<https://www.dji.com/osmo-action-6/specs>



Contact

DJI SUPPORT

This content is subject to change without notice.

Download the latest version from



<https://www.dji.com/osmo-action-6/downloads>

If you have any questions about this document, please contact DJI by sending a message to [DocSupport@dji.com](mailto:DocSupport@dji.com).

DJI and OSMO are trademarks of DJI.

Copyright © 2025 DJI All Rights Reserved.