

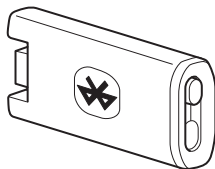

Manfrotto

Imagine More



INSTRUCTIONS

LYKOS BLUETOOTH DONGLE

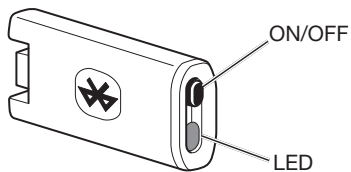

Manfrotto BT Dongle is battery free and mounts a low-battery consumption technology, which will preserve the duration of the batteries of the LED panel.

La Clé USB Bluetooth Manfrotto fonctionne sans batterie et utilise ainsi peu d'énergie, préservant ainsi la durée d'utilisation des batteries du panneaux à LEDs.

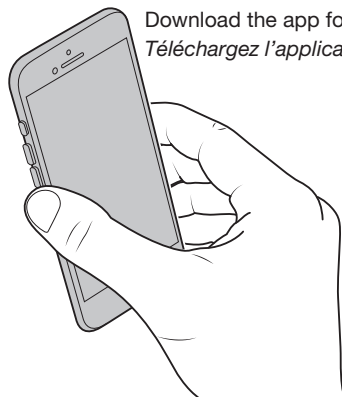

Download the app for iPhone.

Téléchargez l'application pour iPhone.

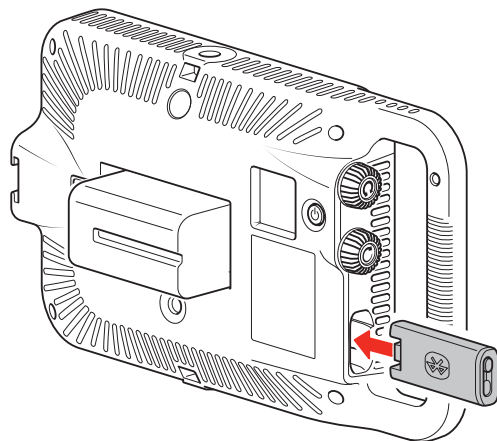

1

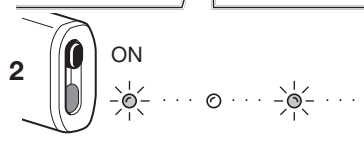
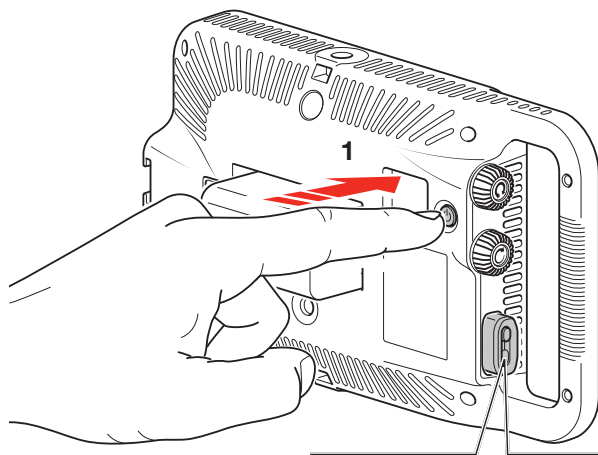

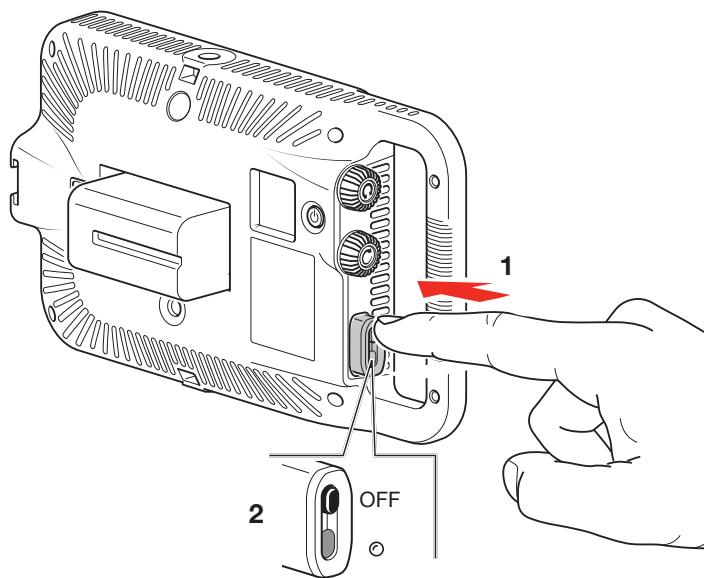

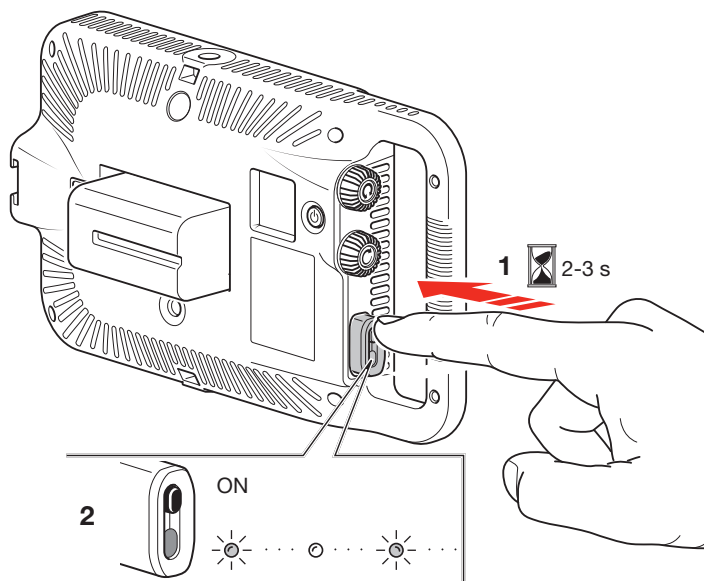

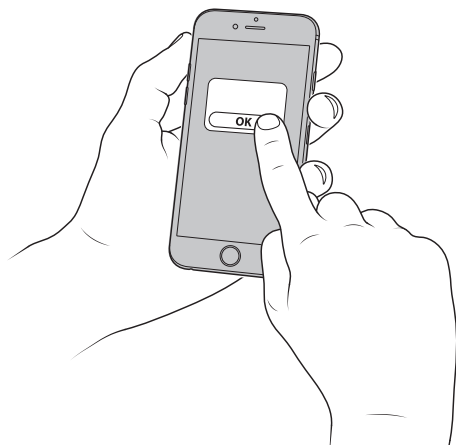



It is not possible to control the same LED panel through more than one iPhone at the same time.

Il n'est pas possible de contrôler une torche LED avec plusieurs iPhone en même temps.

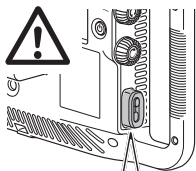

If the connection fails, the blue LED on the Bluetooth dongle will start blinking. Please, restart your iPhone App or turn the LYKOS LED panel off and on again.

Si la connexion s'interrompt, la LED bleue sur la Clé USB Bluetooth clignote. Redémarrez alors l'application iPhone, et éteignez / rallumez le panneaux LED LYKOS.

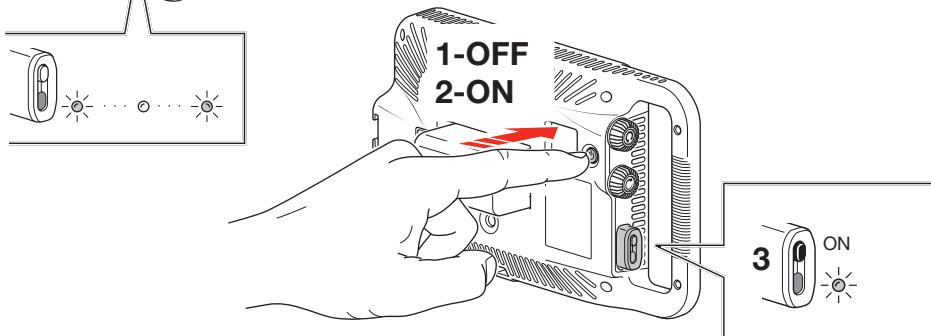

OPERATIONAL AND STORAGE RANGE
TEMPÉRATURE DE STOCKAGE ET DE
FONCTIONNEMENT

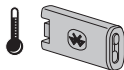
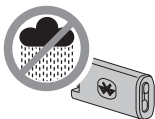

min -20°C (+4° F)
max +50°C (+122°F)

HUMIDITY OPERATIONAL RANGE
NIVEAU DE FONCTIONNEMENT EN
MILIEU HUMIDE



max 85%

PRECAUTIONS

Do not leave your product unattended when working where the general public could be endangered.

Keep out of the reach of children.

It is recommended that the equipment be removed from the support for transportation.

Do not clean the product with solvents, thinners, benzene or other corrosive products.

High temperature:

Avoid temperatures exceeding +70°C (158°F), and do not leave the controller exposed to direct strong sunlight for any extended period, e.g. in a car parked in sunny place.

Electrical precaution:

Never use any battery, power supply or accessory that is not specified by this manual. Never use any battery made or modified by yourself.

Do not insert metal objects or foreign bodies into the device, accessories, connecting cables and any mechanical and/or electrical and/or electronic part of this product.

Do not scratch, cut or excessively bend the cords and do not put heavy objects on them.

Do not use cables whose insulation is damaged.

To prevent compromising their insulation, do not leave cords close to any heating source.

Do not dismantle nor modify the equipment if not explicitly allowed by instructions.

Never touch the electrical contacts of the connecting cables, because they could deteriorate, thus compromising operation.

DISCLAIMER

The information contained in this document is subject to change without notice.

Manfrotto makes no warranty and shall not be liable for any errors on information contained in this document.

Any changes or modifications not expressly approved by Manfrotto could void the user's authority to operate this equipment.

INFORMATION FOR USERS



In accordance with Article 10 of Directive 2012/19/UE of the 04/07/2012 concerning Waste Electrical and Electronic Equipment (WEEE).

The above symbol, also present on equipment, indicates that, at such time as the user should decide to dispose of the equipment, it must NOT be disposed of as unsorted municipal waste, but must be collected separately. The same applies to all components of the equipment and any recharge or refill elements that the product may comprise.

For information on the waste collection systems suitable for this equipment, contact Lino Manfrotto + Co., S.p.A. (www.manfrotto.com) or any authorised member of the National Registers in EU countries. Household (or similar) waste may be disposed of via standard municipal differentiated waste collection schemes.

If this or similar equipment is purchased new, the old equipment it replaces may be returned to the vendor, who will contact the company or body responsible for the proper collection and treatment of the equipment.

Correct separate collection and specific treatment of WEEE are necessary to avoid potential damage to human health