

DJI RC Plus

User Manual

v2.0 2023.05

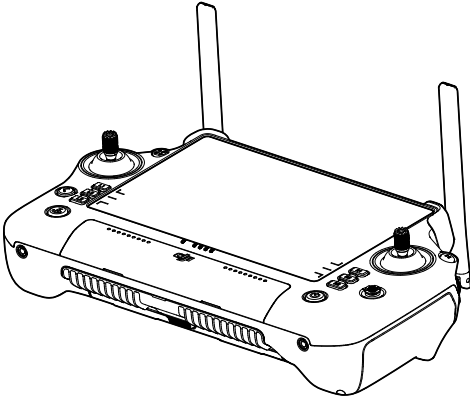



User Manuals, instructions and other material about product functions and specifics are DJI confidential Materials. Users are licensed to use these materials only for purposes of operating and using DJI Products. Unless otherwise authorized in this Terms, you are not eligible to use or allow others to use the Materials or any part of the Materials by reproducing, transferring or selling the Materials. Users should only refer to this document and the content thereof as instructions to operate DJI UAV. The document should not be used for other purposes.

Searching for Keywords

Search for keywords such as “battery” and “install” to find a topic. If you are using Adobe Acrobat Reader to read this document, press Ctrl+F on Windows or Command+F on Mac to begin a search.

Navigating to a Topic

View a complete list of topics in the table of contents. Click on a topic to navigate to that section.

Printing this Document

This document supports high resolution printing.

Revision Log

Version	Date	Revisions
v2.0	2023.5	Compatible with a variety of DJI aircraft.

Using this Manual

Legend

 Important

 Hints and Tips

 Reference

Read Before the First Use

Read the following documents before using DJI™ RC Plus.

1. Quick Start Guide
2. User Manual

It is recommended to watch all tutorial videos on the official DJI website and read Quick Start Guide before using for the first time. Refer to User Manual for more information.

Watch Tutorial Videos

Go to the address below or scan the QR code to watch the DJI RC Plus tutorial videos, which demonstrate how to use the DJI RC Plus safely.



<https://s.dji.com/guide14>

Contents

Revision Log	2
Using this Manual	3
Legend	3
Read Before the First Use	3
Watch Tutorial Videos	3
Product Profile	5
Introduction	5
Overview	6
Preparing the Remote Controller	9
Using Optional Accessories	9
Adjusting the Antennas	10
IP Rating	10
Remote Controller Operations	12
Charging the Battery	12
Checking the Battery Level	12
Powering On/Off	13
Activating the Remote Controller	13
Linking the Remote Controller	13
Control Stick Mode	15
Flight Mode Switch	17
RTH Button	17
Controlling the Camera	18
Controlling the Gimbal	18
L1/L2/L3/R1/R2/R3 Buttons	18
Customizable Buttons	19
Remote Controller LEDs	19
Remote Controller Alert	20
Touchscreen Operations	21
Home Screen	21

Screen Gestures	22
Shortcut Settings	23
Combination Buttons	24
DJI Pilot 2	24
Advanced Features	25
Calibrating the Compass	25
HDMI Settings	25
Maintenance	25
Firmware Update	25
Safety Precautions for Handling Batteries	26
Specifications	27

Product Profile

Introduction

The DJI RC Plus remote controller features DJI's signature OCUSYNC™ video transmission technology, which can match the user's aircraft model to the proper OcuSync firmware and transmit live HD videos from the camera of the aircraft for viewing on the touchscreen. The remote controller comes with a wide range of functional buttons for easy control of the aircraft and camera. The remote controller supports dual transmission, switching between 5.8G and 2.4G depending on the environmental interference for a stable and reliable link. The remote controller has a maximum operating time of 3 hours 18 minutes with the internal battery and up to 6 hours when used with an external WB37 intelligent battery.

High-Bright Screen: The remote controller has a high-performance 8-core CPU and 7.02-inch high brightness 1200 cd/m² touchscreen with a resolution of 1920×1200 pixels.

Multiple Connection Options: The Android operating system comes with a variety of functions, such as Bluetooth and GNSS. Users can connect to the internet via Wi-Fi.

Audio and Video: The remote controller has built-in speakers and supports H.264 4K/120fps and H.265 4K/120fps videos as well as video output via the HDMI port.

Extended Storage Capability: The internal storage of the remote controller is 64 GB and supports the use of a microSD card to store photos and videos, making it easier to export to the other device, such as a computer.

Reliable in More Environments: The remote controller can operate normally within a wide temperature range from -20 to 50° C (-4 to 122° F).

Used with matched DJI aircraft models: There are various versions of the DJI RC Plus. Make sure to use the DJI RC Plus version that matches the aircraft model.

Ingress Protection Rating: The remote controller is IP54 rated in accordance with the global IEC 60529 standard.

Overview

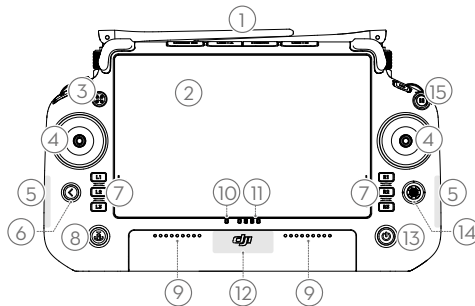

1. **External RC Antennas**
Transmit control and video wireless signals between the remote controller and the aircraft.
2. **Touchscreen**
Displays system and app views and supports up to 10 touch points. Make sure the touchscreen is clean, and completely dry before use. Otherwise, viewing and touch effects may be affected.
3. **Indicator Button**
Functions may vary with different aircraft models. Refer to the user manual for the compatible aircraft. Refer to Guide on the home screen for more information.
4. **Control Sticks**
Flight control mode can be set in DJI Pilot 2.
5. **Internal Wi-Fi Antennas**
DO NOT block the internal Wi-Fi antennas during usage. Otherwise, the signal may be affected.
6. **Back/Function Button**
Press once to return to the previous screen. Press twice to return to the home screen. Use the back button and another button to activate combination buttons. Refer to the Combination Buttons section for more information.
7. **L1/L2/L3/R1/R2/R3 Buttons**
Functions may vary with different aircraft models. Go to camera view in DJI Pilot 2 to view the specific functions of these buttons.
8. **Return to Home (RTH) Button**
Press and hold to initiate RTH. Press again to cancel RTH.
9. **Microphone**
DO NOT block the microphones during usage.
10. **Status LED**
Indicates the remote controller status. Refer to Guide on the home screen for more information.
11. **Battery Level LEDs**
Displays the current battery level of the remote controller.
12. **Internal GNSS Antennas**
DO NOT block internal GNSS antennas during usage. Otherwise, the positioning accuracy may be affected.
13. **Power Button**
Press once to check the current battery level. Press once, then press again and hold for two seconds to power the remote controller on or off. When the remote controller is powered on, press once to turn the touchscreen on or off.
14. **5D Button**
View the default 5D button functions in DJI Pilot 2. Refer to Guide on the home screen for more information.
15. **Flight Pause Button**
Press once to have the aircraft brake and hover in place (only when GNSS or Vision Systems are available).

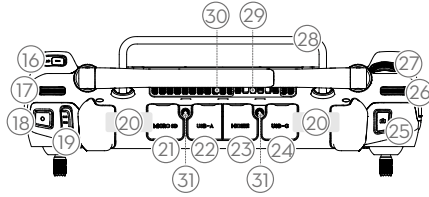

- 16. C3 Button**
Customize functions in DJI Pilot 2.
- 17. Left Dial**
Controls the tilt of the gimbal.
- 18. Record Button**
Press once to start or stop recording.
- 19. Flight Mode Switch**
Switch between different modes. Functions may vary with different aircraft models. Refer to the user manual for the compatible aircraft.
- 20. Internal RC Antennas**
Transmit aircraft control and video wireless signals. DO NOT block the internal RC antennas during usage. Otherwise, the signal may be affected.
- 21. microSD Card Slot**
For inserting a microSD card.
- 22. USB-A Port**
Functions may vary with different aircraft models. Refer to the user manual for the compatible aircraft. Users can also insert third-party devices, such as a USB flash drive or a memory card.
- 23. HDMI Port**
For outputting HDMI signal to an external monitor.
- 24. USB-C Port**
For charging the remote controller.
- 25. Focus/Shutter Button**
Press the button halfway down for autofocus and all the way down to take a photo.
- 26. Right Dial**
Controls the pan of the gimbal.
- 27. Scroll Wheel**
Functions may vary with different aircraft models.
- 28. Handle**
- 29. Speaker**
- 30. Air Vent**
For heat dissipation. DO NOT block the air vent during usage.

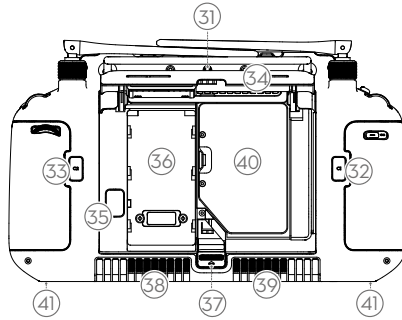

- | | |
|---|--|
| <p>31. Reserved Mounting Holes
For mounting external devices.</p> <p>32. C1 Button
Customize functions in DJI Pilot 2.</p> <p>33. C2 Button
Customize functions in DJI Pilot 2.</p> <p>34. Rear Cover</p> <p>35. Battery Release Button</p> <p>36. Battery Compartment
For installing the WB37 intelligent battery.</p> | <p>37. Rear Cover Release Button</p> <p>38. Alarm</p> <p>39. Air Intake
For heat dissipation. Do not block the air intake during usage.</p> <p>40. Dongle Compartment
For inserting the dongle to the USB-C connector.</p> <p>41. M4 Screw Hole
For mounting the strap bracket.</p> |
|---|--|

Preparing the Remote Controller

Using Optional Accessories

Mounting the WB37 Intelligent Battery

A WB37 battery (excluded) can be mounted onto the remote controller in the following steps.

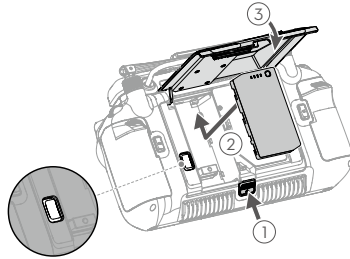

1. Push the rear cover release button to the end to open the rear cover.
2. Insert the WB37 battery into the battery compartment and push it to the top. There will be a clicking sound to indicate the battery is installed firmly.
3. Close the rear cover.

 • To remove the WB37 battery, press and hold the battery release button and push the battery downward.

Mounting the Dongle

The USB-C connector in the dongle compartment can be used to connect a USB-C dongle (excluded) in the following steps.

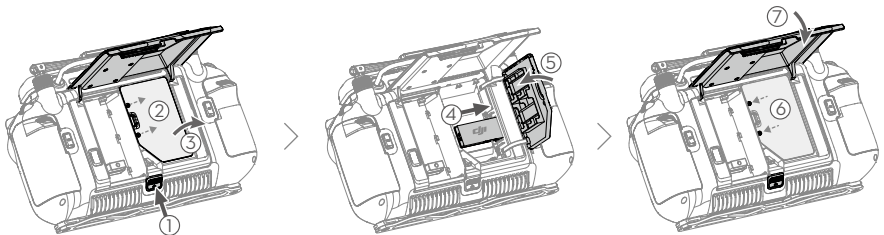

1. Push the rear cover release button to the end to open the rear cover. Remove the screws to open the dongle compartment.
2. Insert the dongle into the USB-C connector. Close the dongle compartment.
3. Attach the dongle compartment with the screws. Close the rear cover.

Remote Controller Strap

Strap brackets may vary with different aircraft models. Refer to the user manual for the compatible aircraft model if a strap bracket is used.

Adjusting the Antennas

Lift and adjust the antennas. The strength of the remote controller signal is affected by the position of the antennas.

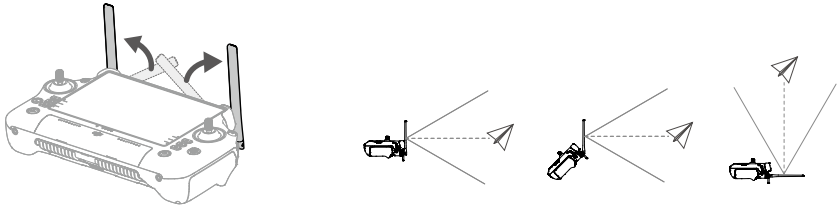

Adjust the direction of the external RC antennas and make sure their flat side is facing the aircraft, so that the controller and aircraft are within the optimal transmission zone.



- DO NOT push the antennas beyond their limit. Otherwise, they may be damaged. Contact DJI Support to repair or replace the antennas if they are damaged. Damaged antennas greatly decrease performance.
- During the flight, DO NOT use other 2.4 GHz or 5.8 GHz communication devices in the same frequency band at the same time, so as not to interfere with the communication signal of the remote controller. Such as enable the mobile phone Wi-Fi.
- A prompt will appear in DJI Pilot 2 if the transmission signal is weak during flight. Adjust the antennas to make sure that the aircraft is in the optimal transmission range.

IP Rating

1. The DJI RC Plus remote controller has been tested in a lab environment and rated IP54 in accordance with the global IEC 60529 standard. The protection rating is not permanent, however, and may lower over an extended period.
 - a. DO NOT use the remote controller when the precipitation exceeds 50mm in 24 hours.
 - b. DO NOT open any cover in the rain, including the external port cover, remote controller rear cover, dongle compartment cover, or air vent and air intake covers. DO NOT mount or remove control sticks or antennas in the rain. Before opening any cover or removing the control sticks or antennas, move the remote controller indoors and make sure it is clean and completely dry.
 - c. When using the remote controller in the rain, make sure all covers are attached firmly and control sticks are screwed in place securely.
 - d. It is normal to have water stains around the port when opening the port cover after use. Wipe off water stains before using the external port.
 - e. The product warranty does not cover water damage.

2. The remote controller is not qualified for an IP54 rating in the following circumstances:
 - a. The cover of the external port is not attached firmly.
 - b. The remote controller rear cover is not attached firmly.
 - c. The air vent and air intake covers are not installed firmly.
 - d. The dongle compartment cover is not attached firmly.
 - e. The control sticks are not screwed in place securely.
 - f. Antennas are not screwed in place securely.
 - g. The remote controller has suffered other damage such as a cracked shell or compromised waterproof adhesive.

Remote Controller Operations

Charging the Battery

The internal battery will be placed in hibernation mode before delivery. It must be charged before first-time use. The battery level LEDs will start to flash to indicate that the internal battery is activated.

It takes approximately 2 hours to fully charge the remote controller internal battery using a recommended charging device.

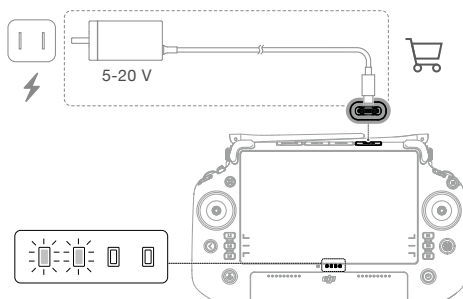

- ⚡ • Charging time for a WB37 battery (if installed) with 0% power:
 - When it is mounted on the remote controller and the internal battery power is 0%: approximately 2 hours (the internal battery will be fully charged simultaneously)
 - When it is mounted on the remote controller and the internal battery power is 100%: approximately 1 hour and 10 minutes

- ⚠ • For optimal charging, it is recommended to use the charging device from the compatible aircraft or a certified USB-C charger with a maximum rated power of 65W and a maximum voltage of 20V, such as the DJI 65W Portable Charger.
- Fully discharge and charge the remote controller every three months. The battery depletes when stored for an extended period.

Checking the Battery Level

Press the power button once to check the current battery level.

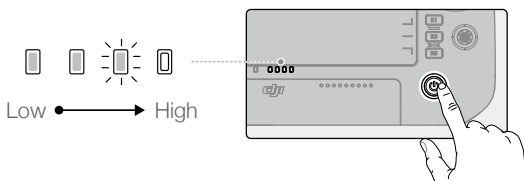

Powering On/Off

Press once and then press again and hold for two seconds to power the remote controller on or off.

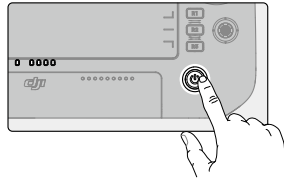

Activating the Remote Controller



The remote controller needs to be activated before first use. Make sure the remote controller can connect to the internet during activation.

Follow the steps below to activate the remote controller:

1. Power on the remote controller. Select a language option and tap Next. Read the Terms of Use and Privacy Policy carefully and tap Agree.
2. Connect to a Wi-Fi network to access the internet. Then set the time zone, date, and time.
3. If you have a DJI account, log in with your password. If you are a new user, create a DJI account and log in.
4. After logging in, tap Activate on the activation interface.
5. A prompt will appear on the screen, indicating that the remote controller is activated.
6. After activating the remote controller, choose if you would like to join the DJI Product Improvement Project. Join this project to help DJI better understand your needs.



• Check the internet connection if the activation fails. Make sure internet access is available and try activating the remote controller again. Contact DJI Support if the activation fails multiple times.

Linking the Remote Controller

The remote controller is already linked to the aircraft when it is purchased together as part of a combo. Otherwise, follow the steps below to link the remote controller and the aircraft after activation.

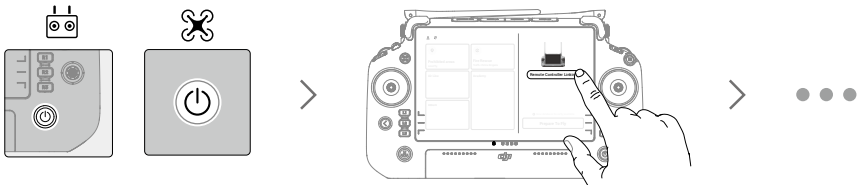

1. Power on the aircraft and the remote controller.

2. Run DJI Pilot 2 and tap Link Remote Controller to link. The status LED of the remote controller will blink blue, and the remote controller will beep during linking.
3. Press and hold the power button on the aircraft for at least five seconds. The aircraft power indicator will blink and will beep twice to indicate linking has started. When linking is successful, the aircraft rear indicators will blink green while the remote controller will beep twice, and the remote controller status LEDs will turn solid green.



- Make sure the remote controller is within 50cm (1.6ft) of the aircraft during linking.
 - Make sure the remote controller is connected to the internet when logging in using a DJI account.
-

Control Stick Mode

There are three pre-programmed modes as well as custom modes that can be configured in DJI Pilot 2. The modes are Mode 1, Mode 2, and Mode 3.

Mode 1

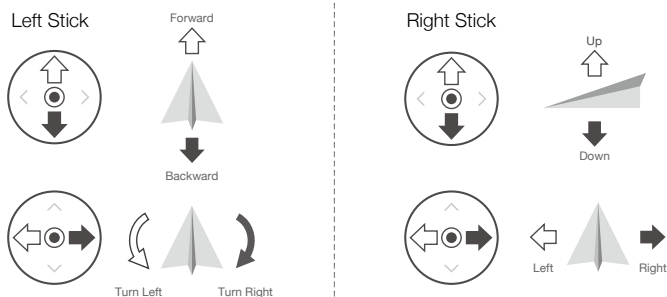

Mode 2

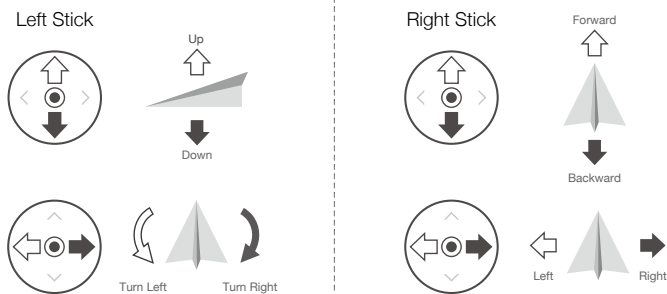



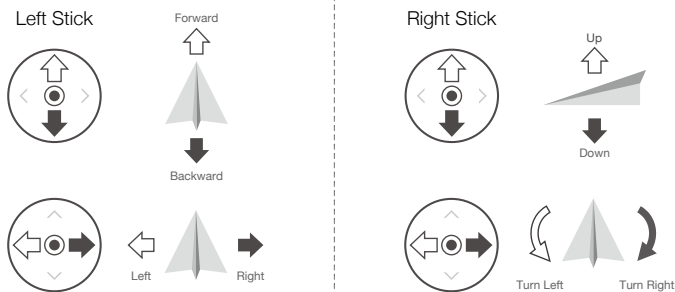



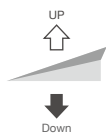

Mode 3

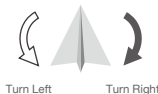

The default mode is Mode 2. See the figures below to check the function of each control stick in the three pre-programmed modes.

-  Center position: control sticks are centered.
 Moving the control stick: control sticks are pushed away from the center.

Remote Controller (Mode 2)	Aircraft	Remarks
Left Stick 		Moving the left stick up or down changes the aircraft's altitude. Push the stick up to ascend and down to descend. The more the stick is pushed away from the center position, the faster the aircraft will change altitude. Push the stick gently to prevent sudden and unexpected changes in altitude.
Left Stick 		Moving the left stick to the left or right controls the orientation of the aircraft. Push the stick left to rotate the aircraft counter-clockwise and right to rotate the aircraft clockwise. The more the stick is pushed away from the center position, the faster the aircraft will rotate.
Right Stick 		Moving the right stick up and down changes the aircraft's pitch. Push the stick up to fly forward and down to fly backward. The more the stick is pushed away from the center position, the faster the aircraft will move.
Right Stick 		Moving the right stick to the left or right changes the aircraft's roll. Push the stick left to fly left and right to fly right. The more the stick is pushed away from the center position, the faster the aircraft will move.

-  • Keep the remote controller away from magnetic materials such as magnets and loudspeaker boxes to avoid magnetic interference.
- To avoid damage to the control sticks, it is recommended that the remote controller be stored in the carrying case when being carried or transported.

Flight Mode Switch

Toggle the switch to select the flight mode.

Position	Flight Mode
F	F-mode (Function)
S	S-mode (Sport)
N	N-mode (Normal)

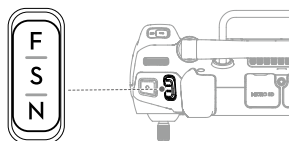

The description below is an example using Matrice 30T.

N-mode (Normal): The aircraft utilizes the GNSS and downward vision system to automatically stabilize itself. The vision and Infrared sensing system works properly and the aircraft can actively brake and avoid obstacles.

S-mode (Sport): The aircraft utilizes the GNSS and downward vision system to automatically stabilize itself. The flight speed and attitude of the aircraft are increased in order to enhance the maneuverability of the aircraft. The maximum flight speed of the aircraft is increased in this mode. The aircraft cannot actively brake and avoid obstacles in S-mode.

F-mode (Function): F-mode can be set to T-mode (Tripod mode) or A-mode (Attitude mode) in DJI Pilot 2. T-mode is based on N-mode. The flight speed is limited to allow easier control of the aircraft. Attitude mode must be used with caution.



- Refer to the flight modes section in the user manual of the corresponding aircraft model for a more detailed description of aircraft operation in different flight modes.

RTH Button

Press and hold the RTH button until the remote controller beeps twice to start RTH. The aircraft will fly to the last updated Home Point. Press the button again to cancel RTH and regain control of the aircraft.

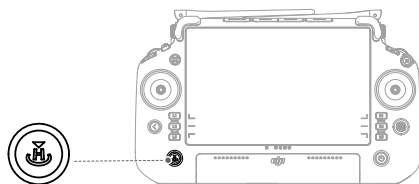

Controlling the Camera

The buttons on the remote controller can be used to control the camera remotely.

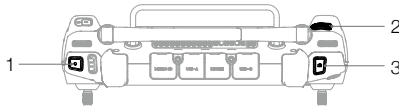

1. Record Button

Press once to start or stop recording.

2. Scroll Wheel

Functions may vary with different aircraft models. Refer to the user manual for the compatible aircraft.

3. Focus/Shutter Button

Press halfway down to autofocus and press all the way down to take a photo. The photo mode can be set in DJI Pilot 2.

Controlling the Gimbal

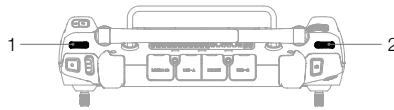

1. Left Dial

The left dial controls the gimbal tilt. Dial left, the gimbal will tilt downwards. Dial right, the gimbal will tilt upwards.

2. Right Dial

The right dial controls the gimbal pan. Dial left, the gimbal pan will rotate to the left. Dial right, the gimbal pan will rotate to the right.

L1/L2/L3/R1/R2/R3 Buttons

Functions may vary with different aircraft models. Refer to the user manual for the compatible aircraft. Find the descriptions of these button functions next to the L1/L2/L3/R1/R2/R3 buttons after running DJI Pilot 2.

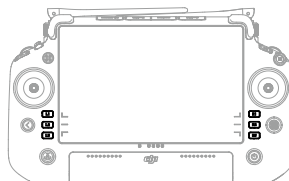

Customizable Buttons

The C1, C2, C3, and 5D buttons are customizable. Open DJI Pilot 2 and enter camera view. Tap ●●● and tap  to configure the functions of these buttons. In addition, combination buttons can be customized using the C1, C2, and C3 buttons with the 5D button.

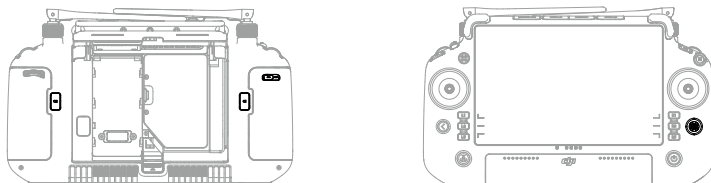

Remote Controller LEDs

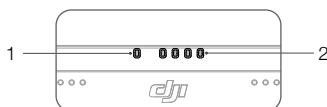













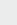

1. Status LED

The status LED indicates the status of the remote controller, the aircraft, and the link between them.

Blinking Patterns	Descriptions
Solid red	Disconnected with aircraft
Blinking red	Low aircraft battery level
Solid green	Connected with aircraft
Blinks blue	The remote controller is linking to an aircraft
Solid yellow	Firmware update failed
Blinking yellow	Low remote controller battery level
Blinks cyan	Control sticks not centered

2. Battery Level LEDs

The battery level LEDs indicate the battery level of the remote controller.

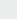
Blinking Pattern				Battery Level
				75%~100%
				50%~75%
				25%~50%
				0%~25%

Remote Controller Alert

The remote controller vibrates or beeps twice to indicate an error or warning. For detailed information, see the real-time prompts on the touchscreen or in DJI Pilot 2. Swipe down from the top of the screen to open Shortcut Settings and turn on Mute mode to disable all voice alerts.

Any voice prompts and alerts will be disabled in Mute mode, including alerts during RTH and low battery alerts for the remote controller or aircraft. Fly with caution.

Touchscreen Operations

Home Screen

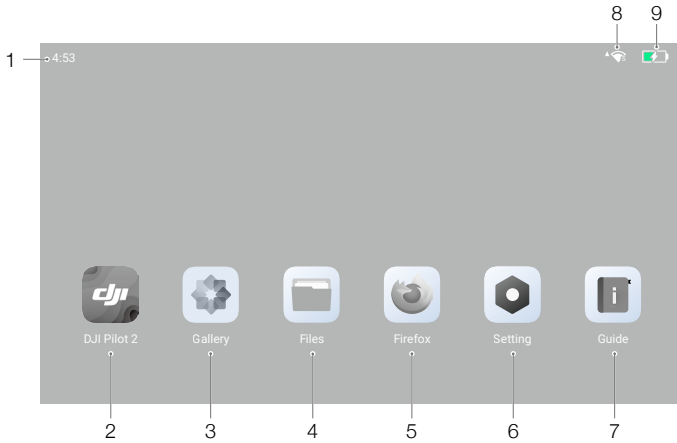

- 1. Time**
Displays local time.
- 2. DJI Pilot 2**
Tap to open DJI Pilot 2.
- 3. Gallery**
Tap to view stored images and videos.
- 4. Files**
Tap to view stored files.
- 5. Browser**
Tap to open the browser.
- 6. Settings**
Tap to open system settings.
- 7. Guide**
Tap to read the guide with concise information on the remote controller buttons and LEDs.
- 8. Wi-Fi Signal**
Displays Wi-Fi signal strength when connected to a Wi-Fi network. Wi-Fi can be enabled or disabled in the shortcut settings or in the system settings.
- 9. Battery Level**
Displays the battery level of the internal battery of the remote controller. The battery level of the external WB37 intelligent battery will also be displayed when installed. The icon  indicates that the battery is charging.

Screen Gestures

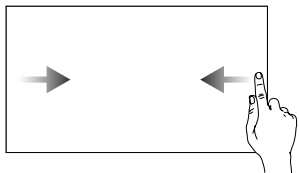

Slide from the left or right to the center of the screen to return to the previous screen.

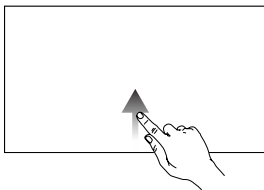

Slide up from the bottom of the screen to return to the home screen.

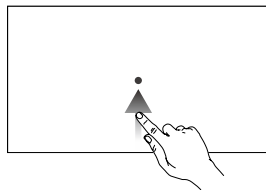

Slide up from the bottom of the screen and hold to access recently opened apps.

Shortcut Settings

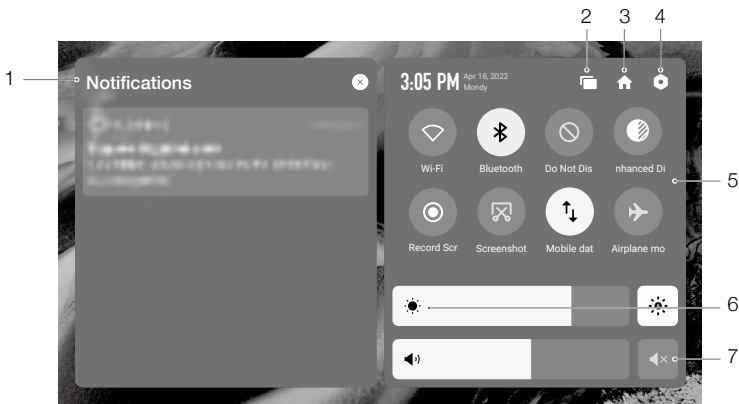

1. Notifications

View system or app notifications.

2. Recent

Tap to view and switch to recently opened apps.

3. Home

Tap to return to the home screen.

4. System Settings

Tap to access system settings.

5. Shortcuts

Wi-Fi : Tap to enable or disable Wi-Fi. Hold to enter settings and connect to or add a Wi-Fi network.

Bluetooth : Tap to enable or disable Bluetooth. Tap and hold to open settings and connect with nearby Bluetooth devices.

Do Not Disturb : Tap to enable Do Not Disturb mode. In this mode, system prompts will be disabled.

Display enhancement : Once enabled, the display brightness is enhanced to assist in shooting. However, there are differences between the source and display effect, while the source photo or video taken by the aircraft is not affected.

Record Scr : Tap to start screen recording.

Screenshot : Tap to screenshot the screen.

Mobile dat : Tap to turn mobile data on or off; long press to set mobile data and diagnose network connection status.

Airplane mo : Tap to enable Airplane mode. Wi-Fi, Bluetooth, and mobile data will be disabled.

6. Adjust Brightness

Slide the bar to adjust the brightness. Tap the icon to auto-brightness mode. Tap the icon and slide the bar to switch to manual brightness mode.

7. Adjust Volume

Slide the bar to adjust the volume and tap to mute. Note that after muting, all sounds of the remote controller will be completely disabled, including related alarm sounds. Please turn on the mute with caution.

Combination Buttons

Users can use combination buttons for certain frequently-used features. Use the back button with other buttons to form these combinations.

Checking Available Combination Buttons

Power on the remote controller, enter the home screen, and tap Guide to check combination buttons.



Using Combination Buttons

The default functions of the combination buttons cannot be changed. The following table displays the default function of each button combination. Use the back button and the other button at the same time to execute a specific function.

Combination Operation	Function
Back Button + Left Dial	Adjust Brightness
Back Button + Right Dial	Adjust Volume
Back Button + Record Button	Record Screen
Back Button + Shutter Button	Screenshot
Back Button + 5D Button	Toggle up - Home; Toggle down - Shortcut settings; Toggle left - Recently opened apps

DJI Pilot 2

Tap DJI Pilot 2 on the home screen to check the flight status and set flight and camera parameters. Since the DJI RC Plus is compatible with multiple aircraft models, the interface of different aircraft models in DJI Pilot 2 may vary. Refer to the DJI Pilot 2 App section in the user manual of the relevant aircraft for more information.

Advanced Features

Calibrating the Compass

The compass may need to be calibrated after the remote controller is used in areas with electromagnetic interference. A warning prompt will appear if the compass of the remote controller requires calibration. Tap the warning prompt to start calibration. In other cases, follow the steps below to calibrate your remote controller.

1. Enter the home screen.
2. Open Settings, swipe up, and select Compass.
3. Follow the diagram on the screen to calibrate your remote controller.
4. The user will receive a prompt when the calibration is successful.



- If the remote controller compass is working normally, "Calibration Success" will be prompted after entering the calibration view. It is not necessary to perform the calibration.
-

HDMI Settings

The touchscreen can be shared with a display screen via an HDMI cable. The resolution can be set in Settings, Display, Advanced, and then HDMI.

Maintenance

Firmware Update

Using DJI Pilot 2

1. Power on the remote controller and make sure it is connected to the internet.
2. Run DJI Pilot 2. A prompt will appear when a new firmware version is available. Tap the prompt to enter the update screen.
3. Update will start automatically after the latest firmware is downloaded.
4. The remote controller automatically restarts when the update is complete.



- Make sure the remote controller is charged over 25% before updating.
 - The update takes approximately 15 minutes. The time it takes to download the update varies depending on the internet speed. Make sure the remote controller has access to the internet during the update.
-

Safety Precautions for Handling Batteries

1. DO NOT allow the batteries to come into contact with any kind of liquid. If the inside of a battery comes into contact with water, chemical decomposition may occur, potentially resulting in the battery catching on fire and possibly leading to an explosion.
2. The battery should be used in an environment of -20 to 50° C (-4 to 122° F) while the ideal environment is 15 to 35° C (59 to 95° F). Using the battery in an ambient temperature above 35°C (95° F) or below 15°C (59° F) can cause battery wear and shorten battery life.
3. The battery life may be reduced if it is charged at a high temperature. After each flight, allow the battery to cool down to approximately room temperature before charging. Charging the battery at a temperature of 15 to 35° C (59 to 95° F) can extend the battery life significantly.
4. DO NOT leave the batteries near heat sources such as a furnace or heater, under direct sunlight, or inside a vehicle in hot weather.

Specifications

OcuSync	
Operating Frequency ^[1]	2.4000-2.4835 GHz; 5.725-5.850 GHz
Max Transmission Distance ^[2] (unobstructed, free of interference)	15 km (FCC); 8 km (CE/SRRC/MIC)
Max Transmission Distance ^[2] (with interference)	Strong Interference (urban landscape, limited line of sight, many competing signals): 1.5-3 km (FCC/CE/SRRC/MIC) Medium Interference (suburban landscape, open line of sight, some competing signals): 3-9 km (FCC); 3-6 km (CE/SRRC/MIC) Weak Interference (open landscape abundant line of sight, few competing signals): 9-15 km (FCC); 6-8 km (CE/SRRC/MIC)
Transmitter Power (EIRP)	2.4 GHz: <33 dBm (FCC); <20 dBm (CE/SRRC/MIC) 5.8 GHz: <33 dBm (FCC); <14 dBm (CE); <23 dBm (SRRC)
Wi-Fi	
Protocol	Wi-Fi 6
Operating Frequency ^[1]	2.4000-2.4835 GHz; 5.150-5.250 GHz; 5.725-5.850 GHz
Transmitter Power (EIRP)	2.4 GHz: <26 dBm (FCC); <20 dBm (CE/SRRC/MIC) 5.1 GHz: <26 dBm (FCC); <23 dBm (CE/SRRC/MIC) 5.8 GHz: <26 dBm (FCC/SRRC); <14 dBm (CE)
Bluetooth	
Protocol	Bluetooth 5.1
Operating Frequency	2.4000-2.4835 GHz
Transmitter Power (EIRP)	<10 dBm
General	
Model	RM700B
Screen	7.02-in LCD touchscreen, with a resolution of 1920×1200 pixels, and high brightness of 1200 cd/m ²
Dimensions (antennas folded)	268×162.7×94.3 mm (L×W×H)
Weight	Approx. 1.25 kg (excl. WB37 battery) Approx. 1.42 kg (incl. WB37 battery)
Internal Battery	Li-ion (6500 mAh @ 7.2 V), Chemical System: LiNiCoAlO ₂
Charging Type	It is recommended to use USB-C chargers with maximum rated power of 65W and maximum voltage of 20V
Rated Power	12.5 W
Storage Capacity	64GB + expandable storage via microSD card
Charging Time	2 hours (using a USB-C chargers with maximum rated power of 65W and maximum voltage of 20V)
Operating Time	Internal Battery: Approx. 3 hours and 18 min; Internal Battery + External Battery: Approx. 6 hours
Ingress Protection Rating	IP54
GNSS	GPS+Galileo+BeiDou

Video Output Port	HDMI Type-A
Operating Temperature	-20° to 50° C (-4° to 122° F)
Storage Temperature Range	Less than one month: -30° to 45° C (-22° to 113° F); One to three months: -30° to 35° C (-22° to 95° F); Three months to one year: -30° to 30° C (-22° to 86° F)
Charging Temperature	5° to 40° C (41° to 104° F)

[1] 5.8 and 5.1GHz frequencies are prohibited in some countries. In some countries, the 5.1GHz frequency is only allowed for use in indoor.

[2] Parameters may vary with different aircraft models. Refer to the user manual for the compatible aircraft.



CONTACT
DJI SUPPORT

This content is subject to change.

If you have any questions about this document, please contact DJI by sending a message to DocSupport@dji.com.