

Going Wireless

with a D5 Digital SLR Camera and WT-6 Wireless Transmitter

This guide outlines two of the many ways you can use the WT-6 wireless transmitter to connect your D5 digital camera to a network.

Printed in Japan
SB5L01(11)
6MWA4611-01

Method 1: Image Transfer Mode

Use image transfer mode to upload to a computer photographs and movies stored on the camera memory cards or to save photos to a computer as they are taken. This guide describes how to connect to a network in infrastructure mode and upload pictures.

Method 2: HTTP Server Mode (See Reverse)

In HTTP server mode, you can use a web browser to access the camera from a computer or iPhone and remotely view or take pictures or edit image comments or copyright or IPTC information stored on the camera. This guide describes how to use an iPhone to log in to the camera in *access point* mode.

Lack of space prevents a complete description of network settings and options. For more information on these topics and on system requirements, see the WT-6 manual or the *Network Guide*.

Infrastructure and Access Point Modes
When used with the D5, the WT-6 can connect in infrastructure and *access point* modes.

Infrastructure mode: Connection via a wireless LAN access point.

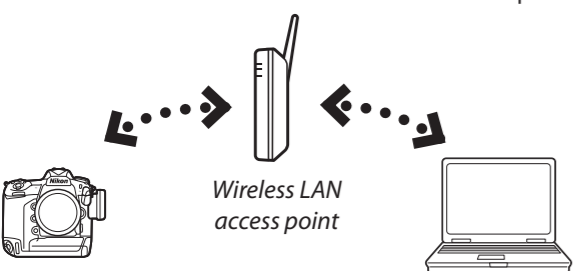

Access point mode: Connect to a computer or smartphone using the camera as a wireless access point.

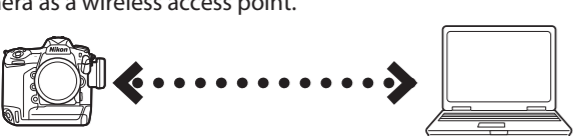

Uploading Pictures in Image Transfer Mode

What You'll Need

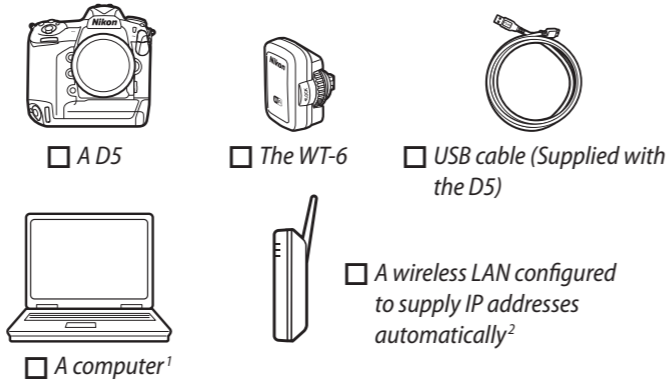

- Before proceeding, confirm that the computer is connected to a wireless network and that the Wireless Transmitter Utility is installed. If you are using a firewall, you will also need to add a port exception to the firewall exceptions list. The Wireless Transmitter Utility can be downloaded from the following website; be sure to check the system requirements prior to installation.
<http://downloadcenter.nikonimglib.com/>
- For information on setting up a wireless LAN, see the documentation provided with the wireless LAN adapter.

Connecting to an Existing Network

This section describes how to create a network profile and connect to an existing network.

1 Connect the WT-6 to the camera.

Turn the camera off, connect the WT-6, and then turn the camera on.

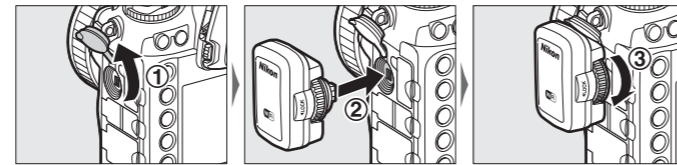

2 Select Wireless LAN.

In the camera setup menu, select **Network > Choose hardware** and highlight **Wireless LAN**.

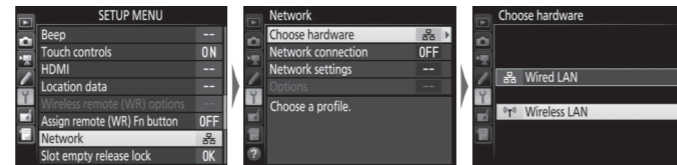

Press **OK** to select the highlighted option and return to the network menu.

3 Start the connection wizard.

Select **Network settings > Create profile > Connection wizard**.

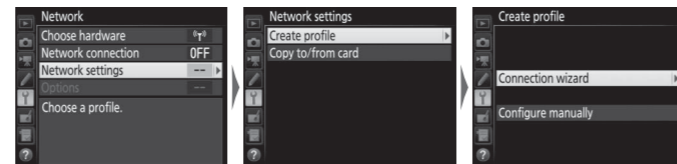

4 Select Image transfer mode.

Select **Image transfer**.

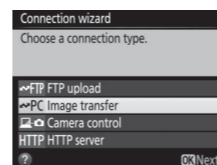

5 Enter a profile name.

A default profile name will be displayed; to change the name as described in the WT-6 manual, press the center of the multi selector. Press **OK** to proceed to the next step when entry is complete.

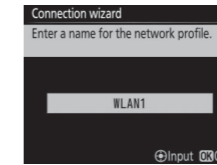

6 Select Search for wireless network.

The WT-6 will search for wireless networks.

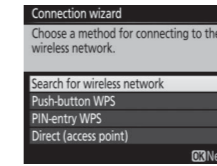

7 Choose a network.

A list of network SSIDs will be displayed. Select the SSID used by your network.

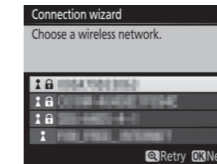

Hidden SSIDs

Hidden SSIDs do not appear in the list of available networks. To connect to a network with a hidden SSID, select a blank SSID. When prompted, press the center of the multi selector, enter the SSID, and press **OK** to complete entry, then press **OK** again to proceed to the next step.

8 Enter the encryption key.

Enter an encryption key if prompted (if the network uses open authentication, this dialog will not be displayed; proceed to Step 9).



When a connection is established, the message at right will be displayed, followed by the dialog shown in Step 9.

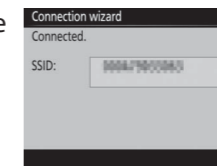

9 Select Obtain automatically.

Press **OK** when the camera IP address is displayed.

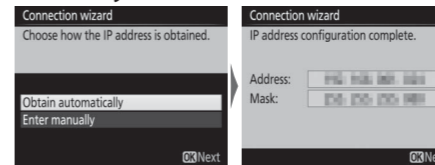

10 Connect the camera to the computer.

When prompted, connect the camera to the computer via USB.



11 Start the Wireless Transmitter Utility.

Pairing starts automatically.



12 Disconnect the camera.

Disconnect the camera from the computer when prompted.

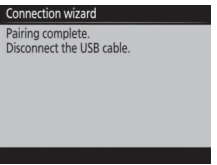

13 Select Connect and exit wizard.

The wizard will end and network status will be displayed.

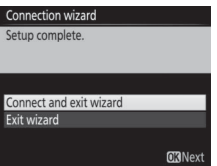

Uploading Pictures

After connecting to the network, follow the steps below to upload pictures from the camera memory cards.

1 Display pictures.

Press the camera **INFO** button.



2 Choose a picture.

Display a picture full frame or highlight it in thumbnail playback.



3 Upload the picture.

Press **OK** and the center of the multi selector. A white transfer icon will appear on the picture and upload will begin immediately. The transfer icon turns green during upload, and turns blue when upload is complete.

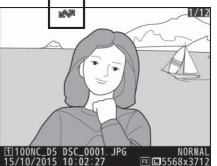

To upload a picture that has already been uploaded once, press **OK** and the center of the multi selector once to remove the blue transfer icon, and then press **OK** and the center of the multi selector again to mark it with a white transfer icon.

During Upload

Do not remove the memory card during upload.

Auto Upload

To upload photographs as they are taken, select **On** for **Network > Options > Auto send** in the camera setup menu.

Destination Folders

By default, images are uploaded to the following folders:

- **Windows:** \Users*(user name)*\Pictures\Wireless Transmitter Utility
- **Mac:** /Users/*(user name)*/Pictures/Wireless Transmitter Utility

The destination folder can be selected using the Wireless Transmitter Utility.

Controlling the Camera from an iPhone in HTTP Server Mode

What You'll Need



Creating a Network Profile

This section describes how to create a new network profile for use when controlling the camera from an iPhone.

1 Connect the WT-6 to the camera.

Turn the camera off, connect the WT-6, and then turn the camera on.

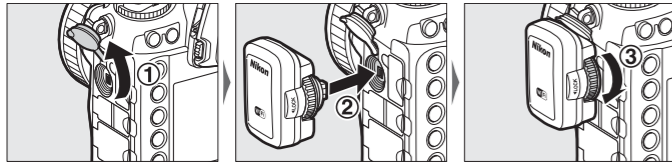

2 Select Wireless LAN.

In the camera setup menu, select **Network > Choose hardware** and highlight **Wireless LAN**.

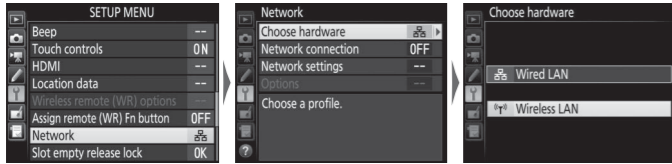

Press **OK** to select the highlighted option and return to the network menu.

3 Start the connection wizard.

Select **Network settings > Create profile > Connection wizard**.

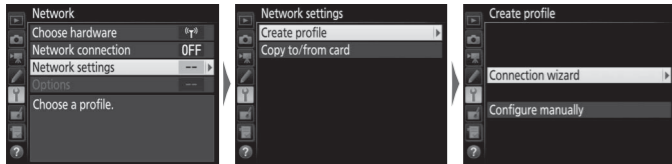

4 Select HTTP server mode.

Select **HTTP server**.

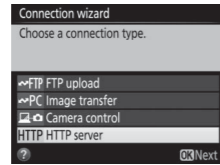

5 Enter a profile name.

A default profile name will be displayed; to change the name as described in the WT-6 manual, press the center of the multi selector. Press **OK** to proceed to the next step when entry is complete.

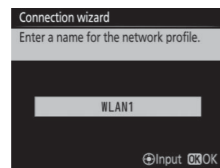

6 Select access point mode.

Select **Direct (access point)**. The camera SSID and encryption key will be displayed in the camera monitor.

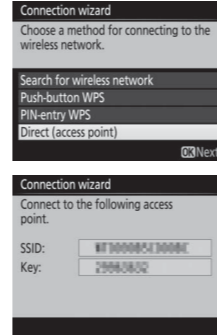

Connecting to the Camera

This section describes how to access the camera from the iPhone web browser.

1 Enable Wi-Fi on the iPhone.

On the iPhone, select **Settings > Wi-Fi** and enable Wi-Fi.

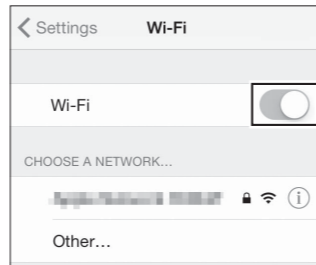

2 Choose the camera network.

The iPhone will display a list of available networks. Tap the SSID that was displayed in the camera monitor in Step **6** of "Creating a Network Profile".

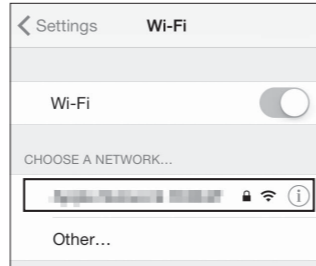

3 Enter the password.

Enter the network encryption key that was displayed in the monitor in Step **6** and tap **Join**.

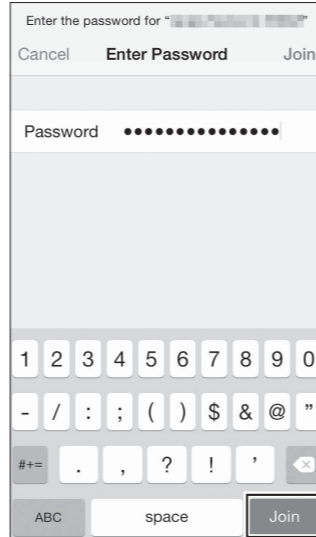

4 Enter the camera IP address.

Start the iPhone web browser and enter the camera URL ("http://" followed by the IP address as shown in the camera network status display).

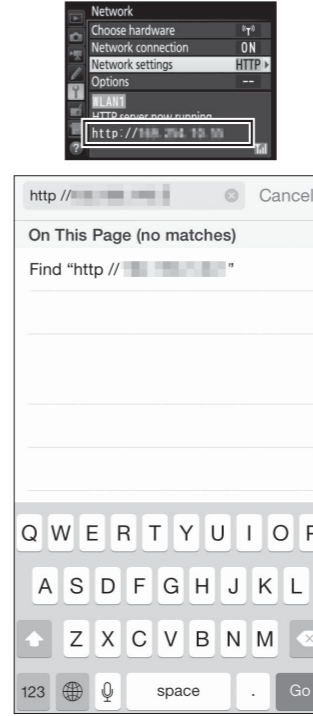

5 Enter your user name and password.

If you are using the default user name and password, enter "nikon" for the user name and leave the password field blank.

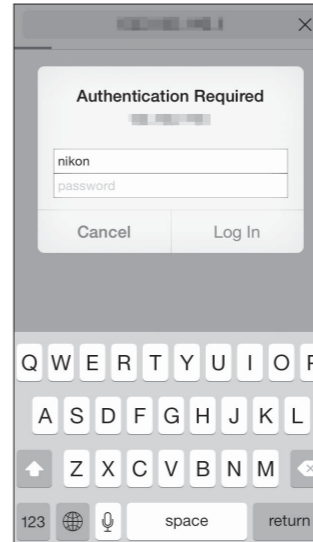

6 Choose a language.

Tap **Language** and choose the desired language.

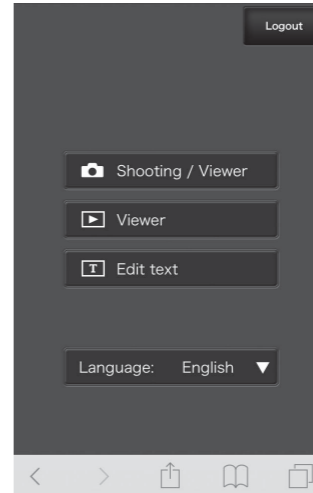

7 Select an operating mode.

Tap **Shooting/Viewer** to take and view pictures, **Viewer** to view existing pictures, or **Edit text** to edit image comments or copyright or IPTC information stored on the camera. Only one user at a time can connect using **Shooting/Viewer** or **Edit text**.



Shooting display

Live view button

The Live View Button
Use the live view button to start live view photography (camera icon) or movie live view (movie icon). The view through the camera lens will be displayed in the viewfinder area. To exit live view, use the live view button to turn live view off.

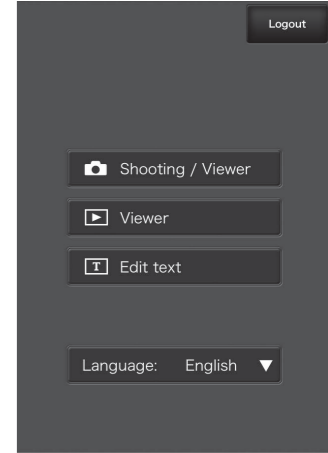

Viewer

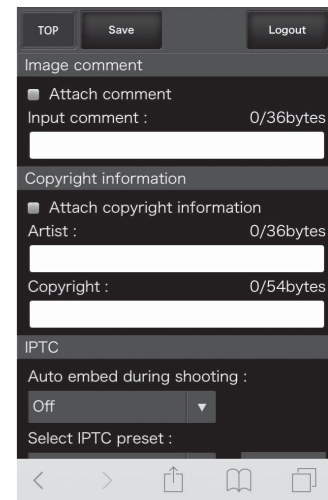

Edit text

For more information on HTTP server mode, see the *Network Guide*.