

SONY®



Table of
contents

Operation
Search

Settings
Search

Index

Handbook

Digital HD Video Camera Recorder

HDR-AS15/AS10

How to use this handbook

Click on a button on the right to jump to the corresponding page.
This is convenient when searching for a function you want to view.



← Search for information by function.

← Search for information by operation.

← Search for information in a listing of Settings items.

← Search for information by keyword.

Table of contents

Operation Search

Settings Search

Index

Marks and notations used in this handbook

Recording Mode

Setting display: [SETUP] → [VIDEO]

You can set the image size and frame rate while recording.
To make the setting, select [SETUP] first.

- 1 Press the NEXT button to display [SETUP], then press the ENTER button.
- 2 While [VIDEO] (Video) is displayed, press the ENTER button.
If the camera turns off by the Auto Power Off function while setting, perform the procedure again from step 1.
- 3 Press the NEXT button to select the Recording Mode, then press the ENTER button.

Display	Resolution	Imaging frame rate	Playback frame rate	Recording time*1
	1280x1080	30p		Approx. 15 minutes
	1280x720	30p		Approx. 45 minutes
	1280x720	60p	30p	Approx. 20 minutes

GMT+0 Sets the region in which you use the camera. (Regions are defined by time difference from Greenwich Mean Time (GMT)).

Note Summer time setting is not available on this camera.

Setting the region
You can set the clock to the local time of a country you visit by selecting the region. Regions are defined by time difference from Greenwich Mean Time (GMT). Refer also to "World time difference" (page 48).

→ The default setting is indicated by ✓.

← Indicates cautions and limitations relevant to the correct operation of the camera.

💡 Indicates information that is useful to know.

Notes on using the camera

About the displayed language

The display panel displays only English. Other languages are not available.

Notes on recording/playback and connection

- Before you start recording, make a trial recording to make sure that the camera is working correctly.
- To play back images, connect the camera to another device with a micro HDMI cable (sold separately).
- The camera is neither dust-proof, nor splash-proof, nor water-proof. Read “Precautions” (page 55) before operating the camera.
- Avoid exposing the camera to water. If water enters inside the camera, a malfunction may occur. In some cases, the camera cannot be repaired.
- Do not aim the camera at the sun or other bright light. It may cause malfunctions.
- Do not use the camera near a location that generates strong radio waves or emits radiation. Otherwise, the camera may not properly record or play back images.
- Using the camera in sandy or dusty locations may cause malfunctions.
- If moisture condensation occurs, remove it before using the camera (page 55).
- Do not shake or strike the camera. It may cause a malfunction and you may not be able to record images. Furthermore, a memory card may become unusable or image data may be damaged.
- When connecting the camera to another device with a cable, be sure to insert the connector plug in the correct way. Pushing the plug forcibly into the terminal will damage the terminal and may result in a malfunction of the camera.
- Playback of movies other than those shot, edited or composed on this camera is not guaranteed.

On camera's temperature

The camera may get warm due to continuous use, but it is not a malfunction.

On the overheat protection

Depending on the camera and battery temperature, you may be unable to record movies or the power may turn off automatically to protect the camera. A message will be displayed on the display panel before the power turns off or you can no longer record movies.

Notes on the battery pack

- Charge the battery pack before using for the first time.
- You can charge the battery pack even if it is not completely discharged. In addition, even if the battery pack is not fully charged, you can use the partially charged capacity of the battery pack as is.
- For details on the battery packs, see page 53.

Notes on the display panel and lens

- Exposing the display panel or the lens to direct sunlight for long periods may cause malfunctions. Be careful when placing the camera near a window or outdoors.
- Do not press against the display panel. It may cause a malfunction.

On image data compatibility

- This camera supports "MP4 format" as movie file format. However, it is not guaranteed that all MP4 compliant devices can play back images recorded with this camera.
- The camera conforms with DCF (Design rule for Camera File system) universal standard established by JEITA (Japan Electronics and Information Technology Industries Association).

Warning on copyright

Television programs, films, videotapes, and other materials may be copyrighted. Unauthorized recording of such materials may be contrary to the provisions of the copyright laws.

No compensation for damaged content or recording failure

Sony cannot compensate for failure to record or loss or damage of recorded content due to a malfunction of the camera or memory card, etc.

The illustrations and images used in this handbook

- The images used as examples in this handbook are reproduced images, and are not actual images shot using the camera.
- In this manual, “Memory Stick Micro” media and microSD memory card are referred to as “memory card.”
- Design and specifications are subject to change without notice.

Notes on playing back on other devices

- The camera is compatible with MPEG-4 AVC/H.264 Main Profile for HD (high definition) image quality recording. Therefore, you cannot play back images recorded with HD (high definition) image quality on the camera with the devices which are not compatible with the MPEG-4 AVC/H.264.
- Movies recorded using this camera may not play back normally on devices other than this camera. Also, movies recorded on other devices may not play back properly on this camera.

On wireless network function

- Only the HDR-AS15 is equipped with the Wi-Fi function.
- The wireless network function built into this camera has been confirmed to conform with Wi-Fi specifications set forth by the Wi-Fi Alliance (WFA).
- Depending on the region, access to a wireless LAN may not be available, may require a separate service charge, or communications may be blocked or suffer from intermittent outages. For details, check your wireless LAN administrator and/or service provider.
- Sony makes no guarantees whatsoever in the provision of a network service. Sony bears absolutely no responsibility for damages that may arise from the use of a network service even in the case of claims made by a third-party.

About the security on using Wireless LAN products

It is important to set security when using the wireless network function. Sony makes no guarantees and is not responsible for any damage resulting from having inadequate security or using the wireless network function.

Carl Zeiss lens

The camera is equipped with a Carl Zeiss lens which is capable of reproducing sharp images with excellent contrast. The lens for the camera has been produced under a quality assurance system certified by Carl Zeiss in accordance with the quality standards of Carl Zeiss in Germany.

How to enjoy the camera

Enjoy more using the accessories

Movies are recorded at a maximum of 1920×1080 30p full high definition.

Waterproof Head Mount Kit & Waterproof Case



Adhesive Mount & Waterproof Case



Headband Mount



Table of
contents

Operation
Search

Settings
Search

Index

Share your life



Upload captured moments

You can directly upload images and share them by using the wireless network function of this camera (page 39).

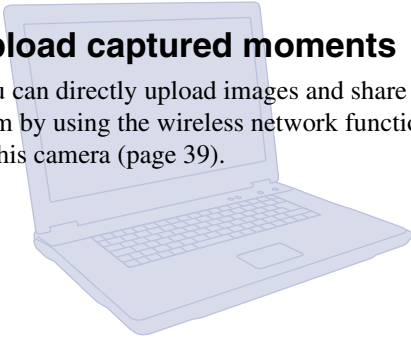

Connect to TV

Connect the camera to a TV with a micro HDMI cable (sold separately), and enjoy images on the big screen (page 38).

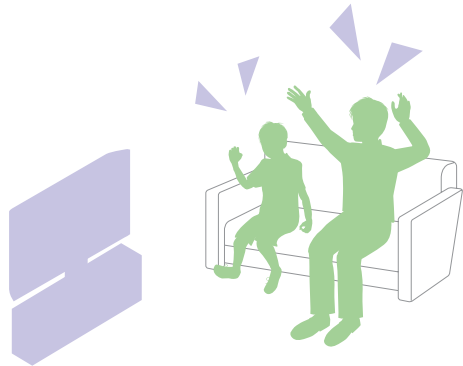
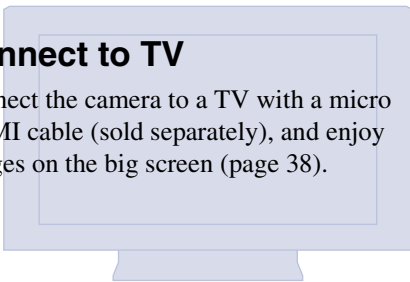

Table of contents

Operation Search

Settings Search

Index

Table of contents

Notes on using the camera

How to use this handbook	2
Notes on using the camera	3
How to enjoy the camera	5
Operation Search	9
Settings Search	10
Identifying parts	11

Getting started

Checking the bundled items	12
Inserting the battery pack	13
Inserting a memory card	16
Recording Mode	18
SteadyShot	19
Field Angle	20
Interval Photo Recording	21
Smart Remote Control (HDR-AS15 only)	22
Auto Power Off	23
Date & Time Setting	24
USB Power Supply	25
Resetting the Settings	26
Format	27
Using Accessories	28

Shooting

Shooting	37
----------------	----

Viewing

Viewing images on a TV	38
------------------------------	----

Wireless Network (Wi-Fi)

Setting Wi-Fi (HDR-AS15 only)	39
Copying data to a smartphone (HDR-AS15 only)	41

Computer

Useful functions when connecting the camera to your computer	42
Preparing a computer (Windows)	43
Starting the “PlayMemories Home” software	45

Troubleshooting

Troubleshooting	46
Warning indicators and messages	50

Others

Recordable time	51
Battery pack	53
Using the camera abroad	54
Precautions	55
Specifications	57

Index

Index	60
-------------	----

Operation Search

Shooting movies and photos	Shooting	37
Changing the movie file size	Recording Mode	18
Deleting images	Format	27
Changing the date, time and region	Date & Time Setting.....	24
Initializing settings	Resetting the Settings.....	26
Viewing on TVs	Viewing images on a TV.....	38
Operating using a smartphone or tablet	Smart Remote Control (HDR-AS15 only).....	22
Uploading images to a network service	Setting Wi-Fi (HDR-AS15 only).....	39

Table of contents

Operation Search

Settings Search

Index

Settings Search

Setting items

Click each item to jump to the corresponding page.

Items	Display	Default setting
Recording Mode	VIDEO	HQ (1920×1080/30P)
SteadyShot	STEDY	ON
Field Angle	ANGLE	120°
Interval Photo Recording	LAPSE	5sec
Smart Remote Control (HDR-AS15 only)	RMOTE	OFF
Auto Power Off	A.OFF	10sec
Date & Time Setting	DATE	2012/1/1 00:00 GMT+0
USB Power Supply	USBPw	ON
Resetting the Settings	RESET	—
Format	FORMT	—

Note

- The display panel displays only English. Other languages are not available.

How to set items

You can set items using the following 3 buttons on the camera.

NEXT*: Goes to the next menu

PREV*: Goes to the previous menu

ENTER: Executes the menu

- * Both NEXT and PREV buttons are used to change the menu. In this manual, we usually use the NEXT button for description. When using only the PREV button, we describe it as the PREV button.

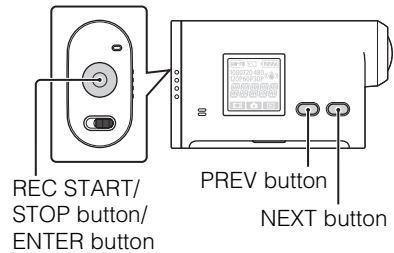

- 1 Press the NEXT or PREV button to turn on the power.
To power off, select [PwOFF] and press the ENTER button.
- 2 Press the NEXT button to display [SETUP], then press the ENTER button.
- 3 Press the NEXT button to display the setting item, then press the ENTER button.
To return to the [SETUP] menu, select [BACK] and press the ENTER button.

Identifying parts

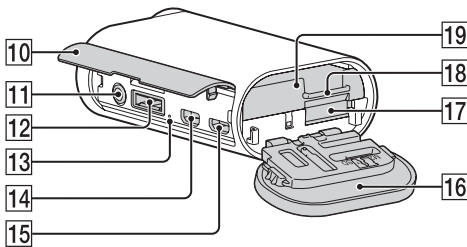
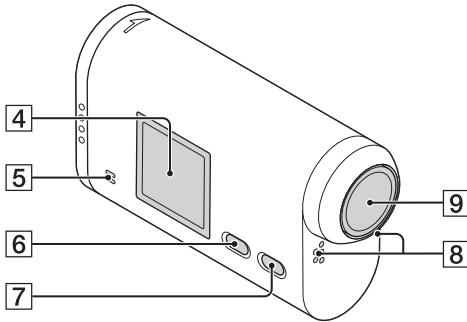
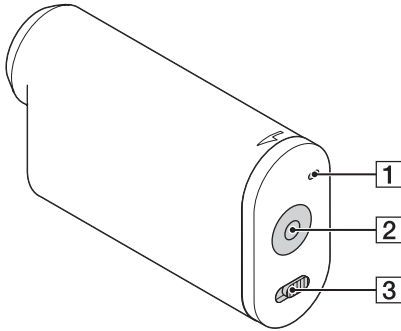

- 1 REC/access lamp
- 2 REC START/STOP button
ENTER (Menu execute) button
- 3 ◀ HOLD switch*¹
- 4 Display panel
- 5 Speaker
- 6 PREV button
- 7 NEXT button
- 8 Microphones
- 9 Lens
- 10 Connector cover
- 11 (Mic) jack*²
- 12 Expansion connector*³
- 13 CHG (Charge) lamp
- 14 HDMI OUT jack
- 15 (USB) jack
- 16 Battery pack/memory card cover
- 17 Memory card insertion slot
- 18 Battery tray lever
- 19 Battery tray

*¹ Used to prevent accidental operation. Slide in the direction of ◀ to lock. Slide in the opposite direction to release.

*² When an external microphone (sold separately) is connected, audio cannot be recorded through the built-in microphone.

*³ Used to connect accessories.

Checking the bundled items

Make sure that you have following bundled items.

The number in parentheses indicates the quantity of that item bundled.

- Camera (1)
- Micro USB cable (1)

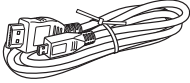

- Rechargeable battery pack (NP-BX1) (1)



- Battery tray, type X (only for NP-BX1) (1)
Attached to the camera.



- Battery tray, type G (only for NP-BG1/FG1) (1)



- Waterproof Case (SPK-AS1) (1)

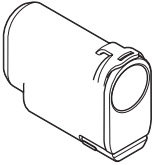

- Adhesive Mount (VCT-AM1)
Attachment Buckle (1)

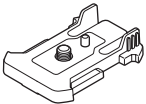

Flat Adhesive Mount (1)

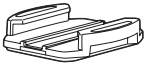

Curved Adhesive Mount (1)



- Handbook (this manual)
Included in the internal memory of this camera.
- Set of printed documentation

Inserting the battery pack

1 Slide the Battery pack/memory card cover in the direction of the arrow, then open the cover.

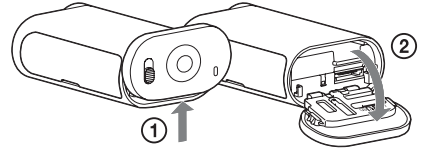

2 Pull out the battery tray from the camera, set the battery pack on the tray, then return it into the camera.

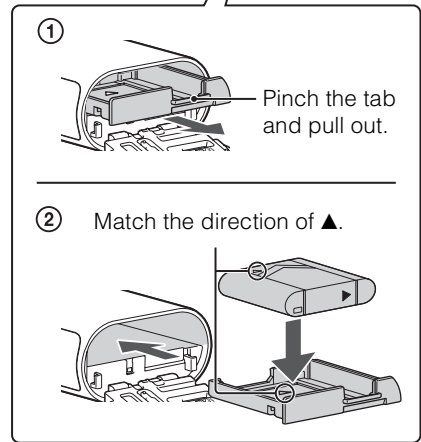
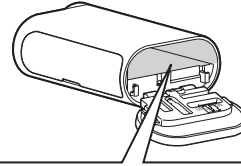

3 Close the cover.

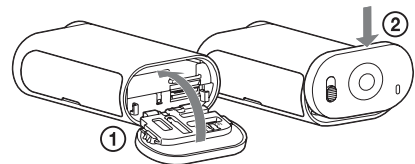

To set Auto Power Off function

Select [A.OFF] from the [SETUP] screen, then set the Auto Power Off function. The default setting is [10sec]. Change the setting as necessary.

For detail, see “Auto Power Off” (page 23).

Charging the battery pack

- 1 Turn off the power of the camera.
Charging is not possible when the camera is turned on.
- 2 Connect the camera to the computer that is turned on with the micro USB cable (supplied).
The CHG (Charge) lamp lights up.

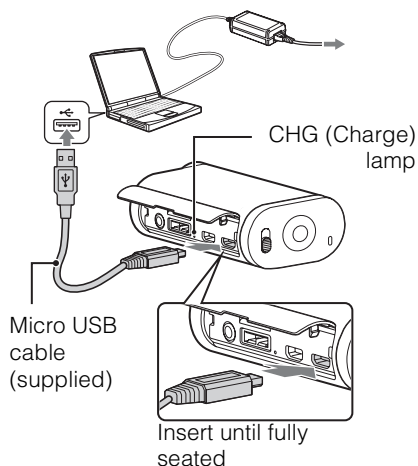

- 3 When charging is finished, delete the USB connection between the camera and the computer (page 44).
Charging is complete when the CHG (Charge) lamp turns off (full charge) (page 53).

Notes

- You can use only type X or G battery with this camera.
- Turn off the camera while charging the battery.
- Do not apply force to the camera, when you connect the camera to a computer. This may cause damage to the camera or the computer.
- When you connect the camera to a notebook computer that is not connected to an AC power source, the battery of the notebook computer may be depleted rapidly. Do not leave the camera connected to the computer for a long time.
- Charging the battery pack or the connection with customized or hand-built computers is not guaranteed. Depending on the type of USB device used, charging may not function properly.
- Operation with all computers is not assured.
- If you do not intend to use the camera for an extended period, charge the camera once every 6 to 12 months to maintain battery performance.

💡 How long does it take to charge the camera?

Charging time

Battery pack	Via a computer	Via AC-UD20* (sold separately)
NP-BX1 (supplied)	Approx. 245 min.	Approx. 175 min.
NP-BG1/FG1	Approx. 185 min.	Approx. 140 min.

- Time required to charge a fully depleted battery pack at a temperature of 25°C (77°F). Charging may take longer under certain circumstances or conditions.
- * Rapid charging is possible by using the USB charger AC-UD20 (sold separately). To connect to the charger, use the micro USB cable (supplied).



Checking the remaining battery charge

A remaining charge indicator appears on the upper right of the display panel.

High      Low



- The displayed remaining charge indicator may not be correct under certain circumstances.
- It takes about one minute until the correct remaining charge indicator appears.

Inserting a memory card

1 Slide the Battery pack/memory card cover in the direction of the arrow, then open the cover.

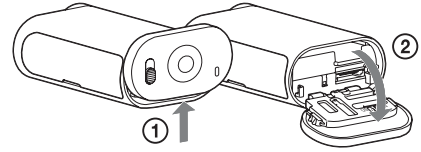

2 Insert the memory card until it clicks.

microSD card: Insert in the direction of **A**.
 “Memory Stick Micro (M2)” media: Insert in the direction of **B**.

- When [WAIT] appears on the display panel, wait until the message disappears.
- Insert a memory card directly in the correct orientation; otherwise, the camera will not recognize it.

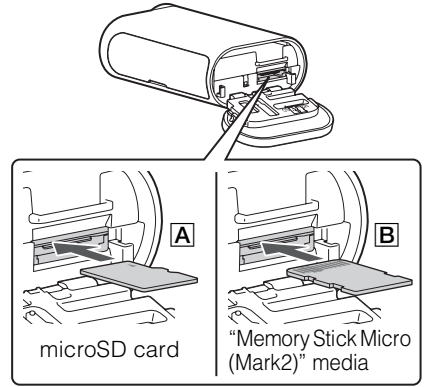

3 Close the cover.

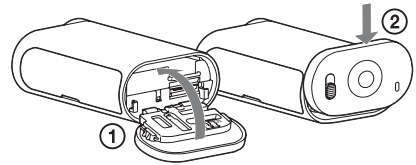

To eject the memory card

Open the cover, then lightly push the memory card once.

What types of memory cards you can use with this camera?

Types of memory cards	SD Speed Class	Phrase in this book
“Memory Stick Micro (Mark2)” media	—	“Memory Stick Micro” media
microSD memory card	Class 4 or faster	microSD card
microSDHC memory card		

- Operation with all memory cards is not assured.

Notes

- In order to stabilize memory card operation, it is recommended that you format the memory card when you use it with the camera for the first time (page 27).
All data recorded on the memory card will be erased by formatting, and cannot be recovered.
- Save important data on the memory card on other media such as a computer, before formatting the memory card.
- If you insert a memory card into the slot in the wrong direction, the memory card, the memory card slot, or image data may be damaged.
- Do not insert anything other than the compliant size of memory card into the memory card slot. Doing so may cause a malfunction.
- When inserting or ejecting the memory card, be careful to prevent the memory card from popping out and dropping.
- Guaranteed operating temperature of the camera is between 0°C to 40°C (32°F to 104°F). However, depending on the types of memory cards, guaranteed operating temperature varies.
For details, refer to the operating instructions supplied with the memory card.

Recording Mode

Setting display

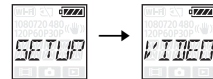

You can set the image resolution and frame rate for shooting movies.
To make the setting, select [SETUP] first.

- 1 Press the NEXT button to display [SETUP], then press the ENTER button.
- 2 While [VIDEO] (Video) is displayed, press the ENTER button.
If the camera turns off by the Auto Power Off function while setting, perform the procedure again from step 1.
- 3 Press the NEXT button to select the Recording Mode, then press the ENTER button.

	Display	Recorded image	Resolution	Imaging frame rate	Playback frame rate
✓		Highest resolution	1920×1080	30p	30p
		High resolution	1280×720	30p	
		Slow motion image recorded at 2× frame rate	1280×720	60p	
		Super slow motion image recorded at 4× frame rate	1280×720	120p	
		Standard resolution	640×480	30p	
		Returns to the [VIDEO] menu.			

Notes

- Continuous movie shooting time is approximately 13 hours.
In [SLOW] mode, it is approximately 6.5 hours.
In [SSLOW] mode, it is approximately 3 hours.
- If you select [SSLOW], SteadyShot will not be effective even if SteadyShot is set to [ON].
- Audio is not recorded during shooting in the following situation:
 - [SSLOW] (720 120P), [SLOW] (720 60P) is set.
- When the recording mode is set to [VGA], the angle of view becomes narrower compared to other recording modes.

Table of contents

Operation Search

Settings Search

Index

SteadyShot

Setting
display

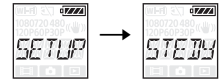

You can activate the camera-shake reduction when shooting.
To make the setting, select [SETUP] first.

- 1 Press the NEXT button to display [SETUP], then press the ENTER button.
- 2 Press the NEXT button to display [STEDY] (SteadyShot), then press the ENTER button.
- 3 Press the NEXT button to select the setting, then press the ENTER button.

✓	The LCD screen shows the SteadyShot menu with 'ON' selected and a checkmark next to it.	Uses SteadyShot.
	The LCD screen shows the SteadyShot menu with 'OFF' selected.	Does not use SteadyShot.
	The LCD screen shows the SteadyShot menu with 'BACK' selected.	Returns to the [STEDY] menu.

Notes

- When SteadyShot is set to [ON], the field angle will be set to [120°].
- When the field angle is set to [170°], SteadyShot will be set to [OFF].
- When the recording mode is set to [SSLOW], SteadyShot will not be effective.

Table of
contents

Operation
Search

Settings
Search

Index



Field Angle

Setting display



You can change the field angle for recording.
To make the setting, select [SETUP] first.

- 1 Press the NEXT button to display [SETUP], then press the ENTER button.
- 2 Press the NEXT button to display [ANGLE] (Angle), then press the ENTER button.
- 3 Press the NEXT button to select the setting, then press the ENTER button.

		Records with a field angle of 170°.
✓		Records with a field angle of 120°.
		Returns to the [ANGLE] menu.

Notes

- When SteadyShot is set to [ON], the field angle will be set to [120°].
- When the field angle is set to [170°], SteadyShot will be set to [OFF].
- When the recording mode is set to [VGA], the angle of view becomes narrower compared to other recording modes.

Table of contents

Operation Search

Settings Search

Index



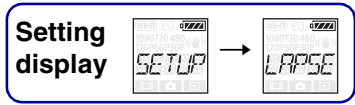

Interval Photo Recording



Once recording is started, the camera records photos continuously at regular intervals until recording is stopped.

To make the setting, select [SETUP] first.

- 1 Press the NEXT button to display [SETUP], then press the ENTER button.
- 2 Press the NEXT button to display [LAPSE] (Interval), then press the ENTER button.
- 3 Press the NEXT button to select the setting, then press the ENTER button.

✓		Continues to record photos at about 5-second intervals.
		Continues to record photos at about 10-second intervals.
		Continues to record photos at about 30-second intervals.
		Continues to record photos at about 60-second intervals.
		Returns to the [LAPSE] menu.

Notes

- The first photo is recorded immediately after recording is started, without waiting for the completion of the set interval. From the second photo, photos will be recorded at the set intervals.
- If it is not possible to record photos at the set intervals, the recording will be delayed.
- The maximum number of recordable files is 40,000 in total, including movie (MP4) files.

Smart Remote Control (HDR-AS15 only)

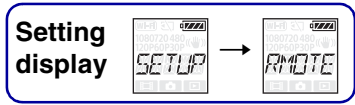

By connecting the camera and a smartphone through Wi-Fi, you can operate the camera by the smartphone.

To make the setting, select [SETUP] first.

- 1 Press the NEXT button to display [SETUP], then press the ENTER button.
- 2 Press the NEXT button to display [RMOTE] (Remote), then press the ENTER button.
- 3 Press the NEXT button to select the setting, then press the ENTER button.

		Operates by the smartphone.
✓		Does not operate by the smartphone.
		Returns to the [RMOTE] menu.

- 4 Select movie mode or interval photo recording mode.
- 5 Activate a suitable application on the smartphone, and connect to the camera through Wi-Fi. For details on the smartphone setting, see “Setting Wi-Fi (HDR-AS15 only)” on page 39.

Notes

- The smart remote control function allows you to perform the following using a smartphone:
 - Checking the field angle
 - Recording start/stop
 - Changing the shooting mode (movie mode/interval photo recording mode)
 - Changing the recording mode setting (in movie mode only)
 - Changing the SteadyShot setting
 - Changing the field angle setting
- To use the smart remote control function, a compatible application is necessary on your smartphone. See page 39 for details on downloading applications.
- The camera battery charge may be consumed quickly if the camera is operated by a smartphone.
- If a Wi-Fi Direct connection request from a Wi-Fi device appears on the shooting screen, press the ENTER button on the acceptance [ACPT?] screen. You can then operate the camera using the smart remote control function via the Wi-Fi Direct connection.

Auto Power Off

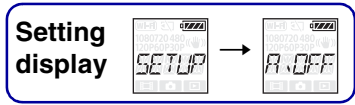

You can change the setting of the Auto Power Off function.
To make the setting, select [SETUP] first.

- 1 Press the NEXT button to display [SETUP], then press the ENTER button.
- 2 Press the NEXT button to display [A.OFF] (Auto Power Off), then press the ENTER button.
- 3 Press the NEXT button to select the setting, then press the ENTER button.

✓		Turns the power off after about 10 seconds.
		Turns the power off after about 60 seconds.
		Does not turn off automatically.
		Returns to the [A.OFF] menu.

Notes

- This function is not available in the following situations.
 - Recording data to media
 - Shooting movies, or shooting in interval photo recording mode
 - During movie playback, or a slideshow
 - Wi-Fi connection is in process, smart remote control is being connected, or an image is being uploaded to a smartphone
 - HDMI connection is being made
 - Supplying power from a connected USB device
 - Connecting a mass storage device
- In the following cases, even if you have selected [10sec] in the Auto Power Off function, the time that elapses before the power turns off will be extended.
 - while adjusting [SETUP] settings
 - while playing back photos
 - when [RMOTE] is set to [ON] and the Wi-Fi icon is displayed.

Date & Time Setting



You can set the year/month/day and region.
To make the setting, select [SETUP] first.

- 1 Press the NEXT button to display [SETUP], then press the ENTER button.
- 2 Press the NEXT button to display [DATE] (Date Time), then press the ENTER button.
- 3 Press the NEXT button to select the desired date, time and region, then press the ENTER button to confirm.
Select 00:00 for midnight, 12:00 for noon.

Display	Default setting	
	2012	Sets the year.
	01	Sets the month.
	01	Sets the day.
	00	Sets the hour.
	00	Sets the minutes.
	GMT+0	Sets the region in which you use the camera. (Regions are defined by time difference from Greenwich Mean Time (GMT)).

Note

- Summer time setting is not available on this camera.

Setting the region

You can set the clock to the local time of a country you visit by selecting the region. Regions are defined by time difference from Greenwich Mean Time (GMT). Refer also to “World time difference” (page 54).

- Table of contents
- Operation Search
- Settings Search
- Index

USB Power Supply

Setting display



When connecting the camera to a computer or USB device with the micro USB cable (supplied), the camera can be set so the connected device supplies power to it. To make the setting, select [SETUP] first.

- 1 Press the NEXT button to display [SETUP], then press the ENTER button.
- 2 Press the NEXT button to display [USBPw] (USB Power), then press the ENTER button.
- 3 Press the NEXT button to select the setting, then press the ENTER button.

✓	The LCD screen shows the [USBPw] menu with [ON] highlighted. The menu options are [ON], [OFF], and [BACK].	Supplies power from a connected device, through the micro USB cable.
	The LCD screen shows the [USBPw] menu with [OFF] highlighted. The menu options are [ON], [OFF], and [BACK].	Does not supply power from a connected device, through the micro USB cable.
	The LCD screen shows the [USBPw] menu with [BACK] highlighted. The menu options are [ON], [OFF], and [BACK].	Returns to the [USBPw] menu.

Notes

- If you change the setting while the micro USB cable is connected, disconnect the cable, then reconnect.
- Power may not be supplied properly from a USB device with a power supply capacity of less than 1.5 A.

Resetting the Settings

Setting
display

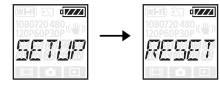

You can reset the settings to their defaults.
If you activate [RESET], movies are not deleted.

- 1 Press the NEXT button to display [SETUP], then press the ENTER button.
- 2 Press the NEXT button to display [RESET] (Reset), then press the ENTER button.
- 3 Press the ENTER button to display [SURE?] while [OK] is displayed, then press the ENTER button again.

The camera automatically restarts when resetting is complete.

To cancel resetting, press the NEXT button to select [CANCL] while [SURE?] or [OK] is displayed, then press the ENTER button.

Table of
contents

Operation
Search

Settings
Search

Index

Format



Formatting is the process of deleting all movies in the memory card, and restoring the memory card to its initial state.

To make the setting, select [SETUP] first.

- 1 Press the NEXT button to display [SETUP], then press the ENTER button.
- 2 Press the NEXT button to display [FORMT] (Format), then press the ENTER button.
- 3 Press the ENTER button to display [SURE?] while [OK] is displayed, then press the ENTER button again.

Formatting starts and [DONE] appears when formatting finishes.

To cancel formatting, press the NEXT button to select [CANCL] while [SURE?] or [OK] is displayed, then press the ENTER button.

Notes

- Save important images before formatting.
- Do not perform any of the following operations while formatting.
 - Press a button.
 - Eject the memory card.
 - Connect/disconnect a cable.
 - Insert/remove the battery pack.

Using Accessories

The following explains how to use accessories that can be attached to this camera.

Waterproof Case (SPK-AS1)

By inserting the camera in the Waterproof Case, you can shoot movies in the rain or at a beach.

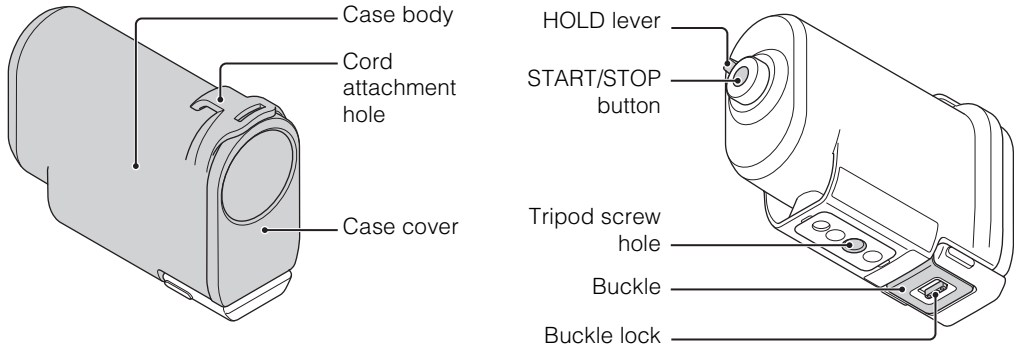

Attachment method

- 1 Slide the buckle lock in the direction of ① and hold it, then hold the circled parts and swing out the buckle in the direction of ②.

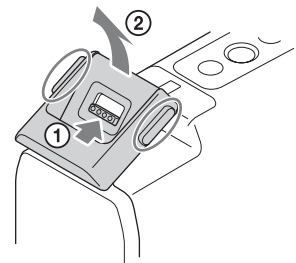

- 2 Open the case cover.

- If the cord detaches from the case cover, attach it again.

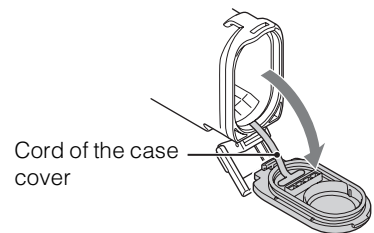

- 3 Insert the camera in the case body.

- Set [A.OFF] to [10sec] or [60sec] to prevent battery drain.
- You cannot change settings after inserting the camera in the Waterproof Case.
- Release the ◀HOLD switch on the camera.

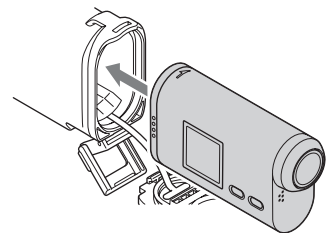

4 Insert the tab of the case cover into the slot of the case body.

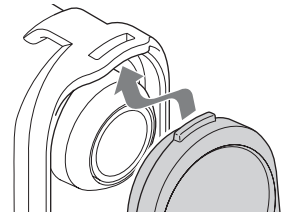

5 Hook the buckle over the tab on the lower part of the case cover ①, then close the buckle in the direction of ②, until it clicks into place.

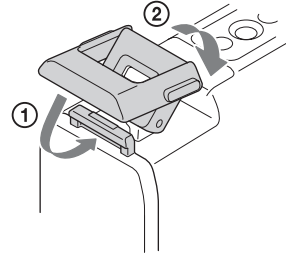

Notes

- You cannot operate the START/STOP button when the HOLD lever is set to the lock position. Release the lock before operation.
- When recording images underwater with the camera in the Waterproof Case, recorded images appear less clear than those of normal recording. This is not a malfunction.
- You can record audio while the camera is in the Waterproof Case, but the sound level is reduced.
- Thread a suitable cord through the attachment hole of the Waterproof Case, then attach the cord to an item you intend to use with the camera.

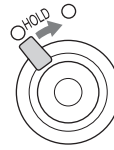

Notes on use

- Do not throw the Waterproof Case into the water.
- Avoid using the Waterproof Case under the following situations:
 - in a very hot or humid place.
 - in water hotter than 40°C (104°F).
 - at temperatures lower than 0°C (32°F).In these situations moisture condensation or water leakage may occur and damage the camera.
- Do not leave the Waterproof Case under direct sunlight in a very hot and humid place for a long period of time. If you cannot avoid leaving the Waterproof Case under direct sunlight, be sure to cover the Waterproof Case with a towel or other protection.
- When the camera overheats, it may automatically turn off or recording may malfunction. To use the camera again, leave it in the cool place for a while to cool down.
- If sun oil is on the Waterproof Case, be sure to wash it off thoroughly using lukewarm water. If the Waterproof Case is left with sun oil on its body, the surface of the Waterproof Case may become discolored or damaged (such as cracks on the surface).

Water leakage

If water happens to leak in, stop exposing the Waterproof Case to water immediately.

- If the camera gets wet, take it to the nearest Sony dealer immediately. Repair costs must be borne by the customer.
- In the unlikely event that a malfunction of the Waterproof Case causes damage due to water leakage, Sony does not guarantee against damages to the equipment contained in it (camera, battery pack, etc.) and the recorded contents, nor expenses entailed in the photography.

O-ring

The Waterproof Case uses an O-ring to maintain its water resistance.

O-ring maintenance is very important. Failure to do O-ring maintenance according to the instructions may lead to water leaks and cause the Waterproof Case to sink.

Inspect the O-ring

- Carefully check that there is any dirt, sand, hair, dust, salt, threads, etc. on the O-ring. If found, be sure to wipe off with a soft cloth or tissue paper.
- Lightly run your fingertip around the O-ring to check for any invisible dirt.
- Be careful not to leave any cloth or tissue paper fibers on the O-ring after wiping it.
- Check the O-ring for cracks, skewing, distortion, fine splitting, scratches, embedded sand, etc. Replace the O-ring if you find any of these.
- Inspect the O-ring contact surface on the case body in the same way.

How to check for water leaks

Before installing the camera, always close the Waterproof Case and immerse it in water to make sure no water leaks in.

O-ring serviceable life

The serviceable life of the O-ring varies with frequency of use of the Waterproof Case and conditions. Generally, it is about one year.

Maintenance

- After recording in a location with a sea breeze, wash this unit thoroughly in fresh water with the buckle fastened to remove salt and sand, then wipe with a soft dry cloth. It is recommended that you submerge the Waterproof Case in fresh water for about 30 minutes. If it is left with salt on it, metal portions may be damaged or rust may form and cause water leakage.
- If sun oil is on the Waterproof Case, be sure to wash it off thoroughly using lukewarm water.
- Wipe the inside of the Waterproof Case with a soft dry cloth. Do not wash it with water.

Be sure to perform the above maintenance each time you use the Waterproof Case.

Do not use any type of solvent such as alcohol, benzine or thinner for cleaning, as this might damage the surface finish of the Waterproof Case.

When storing the Waterproof Case

- To prevent deterioration of the O-ring, store the Waterproof Case in a cool, well-ventilated location. Do not fasten the buckle.
- Prevent dust from collecting on the O-ring.
- Avoid storing the Waterproof Case in a cold, very hot or humid place, or together with naphthalene or camphor, as these conditions might damage the Waterproof Case.

Adhesive Mount (VCT-AM1)

The Adhesive Mount is used for fixing the Waterproof Case to an item you intend to use. The Adhesive Mount is a general term for the Attachment Buckle, Flat Adhesive Mount, and Curved Adhesive Mount. Insert the camera in the Waterproof Case before attaching.

Attachment Buckle

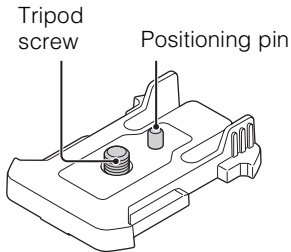

Flat Adhesive Mount

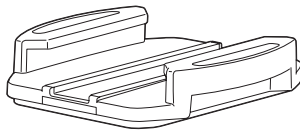

Curved Adhesive Mount

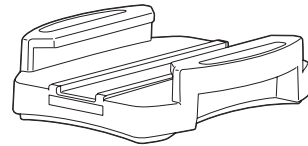

Attachment method

- 1 Align the tripod screw hole in the bottom of the Waterproof Case with the tripod screw hole of the Attachment Buckle, and fix firmly with the tripod screw.

- Confirm that the assembly is fixed securely.

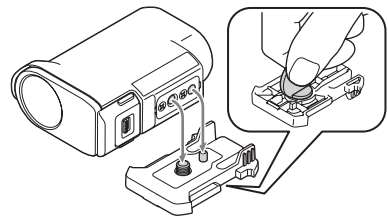

- 2 Attach the Attachment Buckle (with the Waterproof Case set in step 1) to the Flat Adhesive Mount or Curved Adhesive Mount by sliding it until it clicks into place.

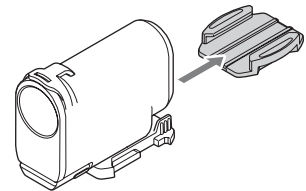

- 3 Remove dust, moisture and oily substances completely from the surface where the adhesive mount is to be attached.

- 4 Peel off the release paper on the back, and fix the Adhesive Mount in the desired location.

- Adhesive power reaches its maximum strength 24 hours after the Adhesive Mount is attached to the desired location.

To attach to or detach from the Attachment Buckle

Press and hold the circled part to unlock, then slide it in the opposite direction of step 2.

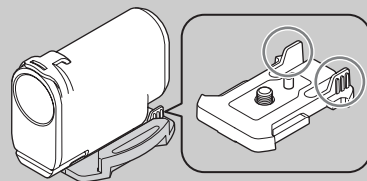

Notes

- The Flat Adhesive Mount and Curved Adhesive Mount cannot be used again once they are detached from the location surface.
- When detaching, peel off slowly. If peeled off forcibly, the surface on which the mount is fixed might be damaged.
- Before attaching, check the surface of the item to be used. If it is dirty, or dust, moisture or oily substances are attached, adhesive strength may be impaired and the item could detach with slight impact.
- Use the appropriate Adhesive Mount (flat or curved) for the surface where the camera will be located. If the mount is not suitable for the surface, it may detach by slight impact.
- Thread a suitable cord through the attachment hole of the Waterproof Case, then attach the cord to an item you intend to use with the camera.
- Before use, confirm that the screw hole on the attachment buckle is not loose, and the flat or curved adhesive mount is securely attached to the surface.

Table of
contents

Operation
Search

Settings
Search

Index

Handlebar Mount (VCT-HM1) (sold separately)

The Handlebar Mount is used for fixing the Waterproof Case on the handlebar of a bicycle. Insert the camera in the Waterproof Case before attaching. For details, refer to the instruction manual of the Handlebar Mount (VCT-HM1) (sold separately).

How to attach

Align the tripod screw hole of the Waterproof Case with the camera mounting screw of the cradle, then secure the Waterproof Case by turning the camera mounting knob.

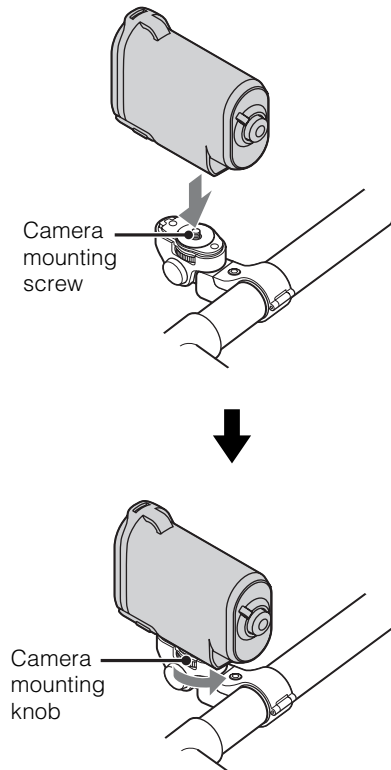

To adjust the angle of the mounting plate

Press and hold the button on the left side of the cradle, and adjust the angle.

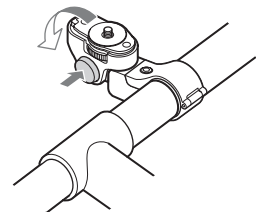

Waterproof Head Mount Kit (VCT-GM1) (sold separately)

The Waterproof Head Mount Kit is used for fixing the Waterproof Case to an item you intend to use. The Kit comprises of a Goggle Mount and a Headband. Insert the camera in the Waterproof Case beforehand.

Goggle Mount

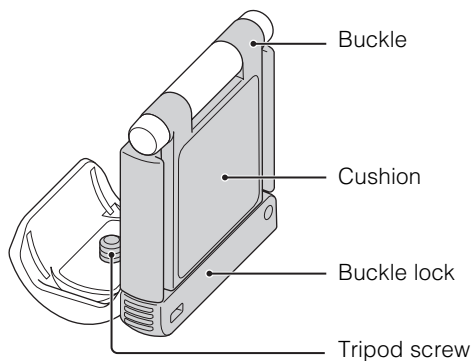

Headband

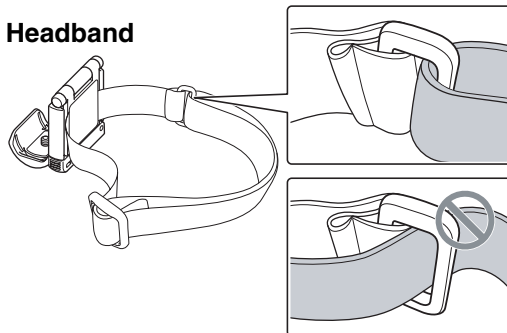

Attachment method

1 Rotate the buckle lock in the direction of ①, then, open the buckle in the direction of ②.

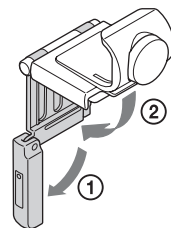

2 Insert your strap of the goggle, then return the buckle ① and the buckle lock ② to its closed position.

The Headband of this kit can also be attached in the same way. The length of the Headband is adjustable.

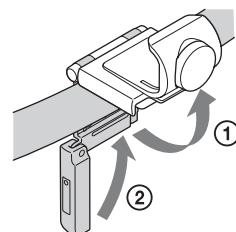

3 Align the tripod screw hole in the bottom of the Waterproof Case with the tripod screw hole of the Goggle Mount, and fix firmly with the tripod screw.

- Confirm that the assembly is fixed securely.
- You can attach the camera in either direction.

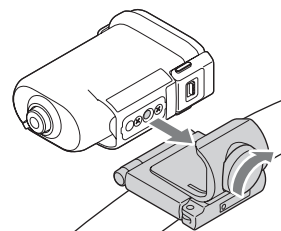

Notes

- When using your own strap, use one of 40 mm or narrower width. Depending on the shape of the strap, the camera may be subjected to vibration. To prevent this, use the Headband of this kit.
- Thread a suitable cord through the attachment hole of the Waterproof Case, then attach the cord to an item you intend to use with the camera.
- Depending on where the camera is used, it may be subject to strong vibration.
- Depending on how the strap is fastened or the conditions of use, the camera may be subjected to vibration.

Headband Mount (BLT-HB1) (sold separately)

You can fasten the camera to your head using the Headband Mount.

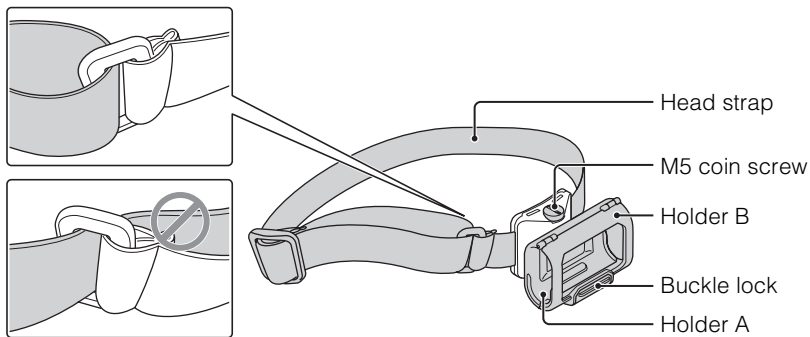

Attachment method

1 Release the buckle lock ① and open Holder B in the direction of ②.

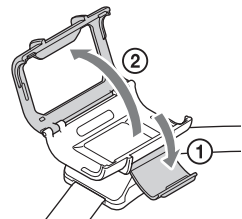

2 Attach the camera to the Holder A ①, then close Holder B ②.

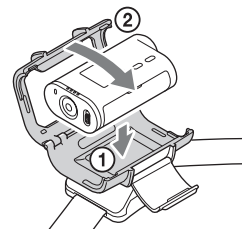

3 Close the buckle lock.

- The tilt of the holder can be adjusted by loosening the M5 coin screw. After loosening the screw, fasten it again firmly.
- The length of the head strap is adjustable.
- You can attach the camera in either direction.

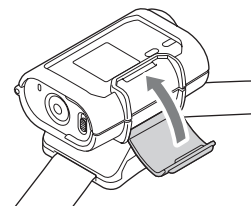

Notes

- The Headband Mount is not dust-proof, splash-proof, water-proof. Do not use in the rain or near water. The Waterproof Case cannot be attached.
- The head strap is designed for the Headband Mount only. It cannot be detached.
- Depending on how the head strap is fastened or the conditions of use, the camera may be subjected to vibration.

Shooting



About the ◀ HOLD switch

The ◀ HOLD switch can prevent accidental operation. Slide the ◀ HOLD switch in the direction of ◀ to lock. To release the lock, slide it in the opposite direction of ◀.

- Before recording, release the lock.
 - If you lock the camera while recording, the recording state will be kept*.
 - If you lock the camera after you stop recording, the stopped state will be kept*.
- * Release the lock to change the setting.

1 Turn on the power, press the NEXT button to display [MOVIE] or [INTVL], then press the REC START/STOP button.

The REC/access lamp lights up, then shooting starts.

When the power is already on, press the NEXT button to display [MOVIE], then press the REC START/STOP button to start shooting.

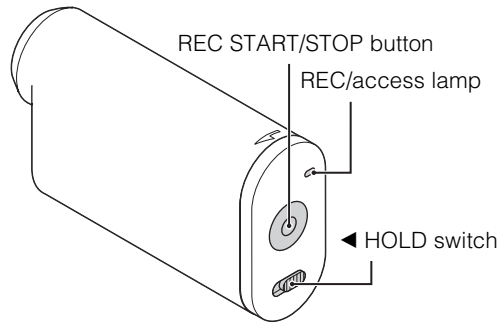

2 Press the REC START/STOP button again to stop shooting.

Note

- If the shooting mode is changed, the mode set when the camera is turned off will be resumed when the camera is turned on the next time.

💡 Notes on long-time recording

- When you continue to shoot for a long time, the temperature of the camera rises. If the temperature reaches above a certain level, shooting stops automatically. Leave the camera for 10 minutes or longer to allow the temperature inside the camera to decrease to a safe level.
- Under high ambient temperatures, the temperature of the camera rises quickly.
- When the temperature of the camera rises, the image quality may deteriorate. It is recommended that you wait until the temperature of the camera drops before continuing to shoot.
- The surface of the camera may get hot. This is not a malfunction.

Table of contents

Operation Search

Settings Search

Index

Viewing images on a TV

Display



Connect the camera to a TV which has an HDMI terminal using a micro HDMI cable (sold separately).

Refer also to the instruction manuals of the TV.

- 1 Turn off both the camera and the TV.
- 2 Open the connector cover and connect the camera to the TV with the micro HDMI cable (sold separately).

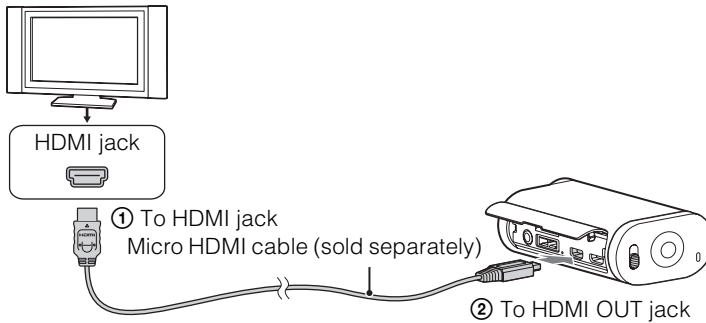

- 3 Set the input of the TV to [HDMI input].
- 4 Press the NEXT button on the camera to turn on.
- 5 Press the NEXT button to display [PLAY], then press the ENTER button.
- 6 Press the NEXT button to display [MP4] or [PHOTO], then press the ENTER button.

Select [MP4] to play back movies, or [PHOTO] to view photos.
Press the ENTER button again to stop playback.

Notes

- Connect the micro HDMI jack of the micro HDMI cable (sold separately) to the HDMI OUT jack of the camera.
- Do not connect the output terminal of the camera to that of other devices. This may result in malfunction.
- Some devices may not work properly. Image and sound may not be output.
- Use a micro HDMI cable (sold separately) with the HDMI logo.



To control a content being played back

- Viewing the previous/next image: Press the PREV/NEXT button.
- Fast-rewind/fast-forward (movies only): Press and hold the PREV/NEXT button.
- Pause (movies only): Press the PREV and NEXT buttons simultaneously. If you press and hold the PREV or NEXT button during pause, slow rewind or slow forward can be performed.
- Adjusting the volume (movies only): Press and hold the PREV and NEXT buttons simultaneously.
- Starting a slideshow (photos only): Press the PREV and NEXT buttons simultaneously.
- Ending playback: Press the ENTER button.

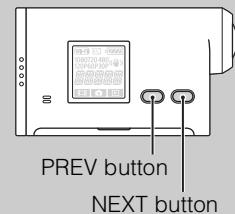

Table of contents

Operation Search

Settings Search

Index

Setting Wi-Fi (HDR-AS15 only)

Setting display



Table of contents

Operation Search

Settings Search

Index

You can operate the camera by a smartphone, or transfer and display images onto a smartphone. To operate the camera by a smartphone, see page 22 for details. To transfer and display images onto a smartphone, download the application “PlayMemories Mobile” (designed for smartphones) from the application store. You can use this camera as an access point.

Items to be prepared before setting

- Sticker attached to the Operating Guide of the camera (ID/password described)
- Your smartphone

- 1 Press the NEXT button to turn on the camera.
- 2 Press the NEXT button to display [SEND].
- 3 Press the ENTER button to display [PREP], then Wi-Fi is activated.
Wi-Fi connection status (automatic display)
[PREP] (prepare for connecting) → [AWAIT] (await connecting)
Press the ENTER button to terminate the Wi-Fi connection.

Notes

- To perform this operation, it is necessary to insert a memory card which contains movies or photos recorded on this camera.
- Wireless LAN provides the benefit of connecting freely anywhere in the service area, by sending and receiving information via radio waves. However, if you do not make security settings, you run the risk of malicious third-party unauthorized access, etc.
- Internet connection using the Wi-Fi function of the camera is not possible.

To set the smartphone

- 1 Install “PlayMemories Mobile” on your smartphone.
- 2 Set the smartphone.

When your smartphone is an iPhone

- ① Select [Settings] → [Wi-Fi Networks] → [Choose a Network] on your smartphone to select the camera.
- ② Enter the password provided on the sticker attached to the Operating Guide of the camera in [Enter Password] on your smartphone to complete the setting.
- ③ Start “PlayMemories Mobile” on the smartphone.
Your smartphone is now connected to the camera.

When your smartphone is an Android

- ① Start “PlayMemories Mobile” on the smartphone and select the camera.
- ② Enter the password described on the Operating Guide of the camera to complete the setting.
Your smartphone is now connected to the camera.



If the password is lost

- ① Connect the camera to a computer with the micro USB cable (supplied).
- ② Turn on the power.
- ③ Display [Computer] → [PMHOME] → [INFO] → [WIFI_INF.TXT] on your computer, then check the user ID and password.

Copying data to a smartphone (HDR-AS15 only)

You can copy movies and photos shot by the camera to a smartphone.

- 1 Press the NEXT button to turn on the camera.
- 2 Press the NEXT button to display [SEND].
- 3 Press the ENTER button to display [PREP], then Wi-Fi is activated.
Wi-Fi connection status (automatic display)
[PREP] (prepare for connecting) → [AWAIT] (await connecting)
When [READY] appears, data can be copied from the camera to the smartphone by operating the smartphone.

Note

- [READY] appears if you perform any of the following operations while [AWAIT] is displayed:
 - You perform an operation of “To set the smartphone” (page 39).
 - You accept a direct request from a Wi-Fi Direct* device, and press the ENTER button to permit the direct connection while [ACPT?] is displayed.
- * A standard that can connect the Wi-Fi devices each other at the no access point area.

Useful functions when connecting the camera to your computer

For Windows

The “PlayMemories Home” software allows you to import images in the camera to your computer and play them on the computer easily.

Visit the following URL to install the software.

<http://www.sony.net/pm>

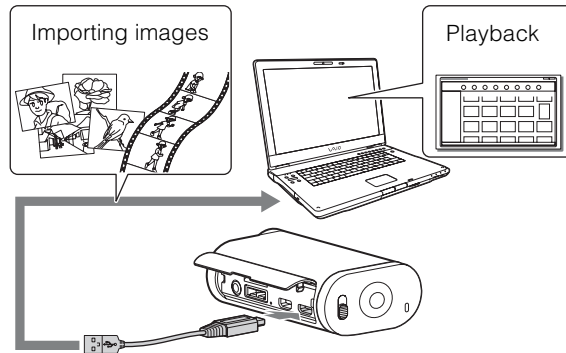

- Use the micro USB cable (supplied) when connecting the camera to your computer.

For Mac

The “PlayMemories Home” software is not compliant with Mac computers.

To import images from the camera to your Mac and play them, use the appropriate software on your Mac. For details, visit the following URL.

<http://www.sony.co.jp/imsoft/Mac/>

Preparing a computer (Windows)

Step 1 Checking the computer system

OS* ¹	Microsoft Windows XP SP3/Windows Vista SP2/Windows 7 SP1
CPU* ²	Intel Core Duo 1.66 GHz or faster, or Intel Core 2 Duo 1.66 GHz or faster
Memory	Windows XP: 512 MB or more (1 GB or more is recommended) Windows Vista/Windows 7: 1 GB or more
Hard disk	Disk space required for installation: Approximately 500 MB
Display	Minimum 1,024×768 dots
Others	USB port (this must be provided as standard, Hi-Speed USB (USB 2.0 compatible)) Either NTFS or exFAT file system is recommended as the hard disk file system.

*¹ Standard installation is required. Operation is not assured if the OS has been upgraded or in a multi-boot environment.

*² Faster processor is recommended.

Note

- Operation with all computer environments is not assured.

Step 2 Installing the “PlayMemories Home” software

1 Turn on the computer.

- Log on as an Administrator.
- Close all applications running on the computer before installing the software.

2 Connect the camera to the computer.

Visit the following URL and download the software.

<http://www.sony.net/pm>

The AutoPlay wizard is displayed.

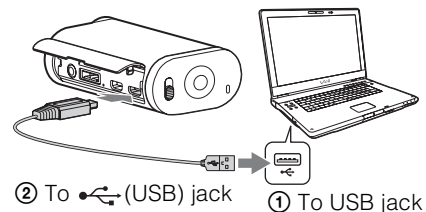

3 Follow the instructions that appear on the computer screen to continue the installation.

When the installation completes, “PlayMemories Home” starts up.

- If the “PlayMemories Home” software is already installed on your computer, connect the camera to the computer, and register the camera with the “PlayMemories Home” software. Functions that can be used with this camera will then be available.
- If the “PMB (Picture Motion Browser)” software is installed on your computer, it will be overwritten by the “PlayMemories Home” software. In this case, you cannot use some functions that were available with “PMB” with this “PlayMemories Home” software.
- For details on “PlayMemories Home” select  (“PlayMemories Home” Help Guide) on the software or visit the PlayMemories Home support page (<http://www.sony.co.jp/pmh-se/>).

To delete the USB connection

Windows7

- 1 Click  on the task tray.
- 2 Click the disconnect icon in Customize.
- 3 Click the device to remove.

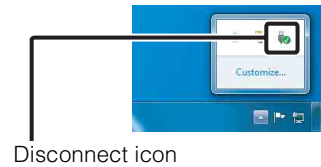

Windows Vista/Windows XP

Perform the procedures from step 1 to 3 below before:

- Disconnecting the micro USB cable (supplied).
- Turning off the camera.

- 1 Double-click the disconnect icon on the task tray.
- 2 Click  (USB Mass Storage Device) → [Stop].
- 3 Confirm the device on the confirmation window, then click [OK].

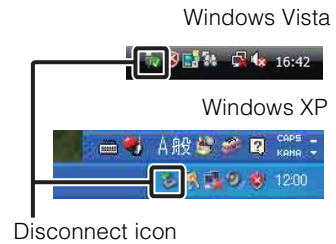

Notes

- Do not format the memory card of the camera using a computer. If you do this, the camera will not operate correctly.
- When you access the camera from the computer, use the “PlayMemories Home” software. Do not directly modify the files or folders on the camera from the computer. The image files may be damaged or may not be played back.
- Operation is not guaranteed, if you operate the data on the memory card of the camera from the computer.
- Use the “PlayMemories Home” software when you import long movies or edited images from the camera to a computer. If you use other software, the images may not be imported correctly.
- Drag and drop the drive icon to the “Trash” icon when you use a Mac computer, and the camera is disconnected from the computer.

Starting the “PlayMemories Home” software

- 1 Double-click the “PlayMemories Home” icon on the computer screen.

The “PlayMemories Home” software starts up.



- 2 Double-click the ““PlayMemories Home” Help Guide” short-cut icon on the computer screen to see how to use “PlayMemories Home.”

- If the icon is not displayed on the computer screen, click [Start] → [All Programs] → [PlayMemories Home] → the desired item.



Please register your product

- Sony asks you to register your product for enhanced support.
- Proceed to the product registration from the menu on the installation screen of PlayMemories Home.

Troubleshooting

If you experience trouble with the camera, try the following solutions.

① Check the items on pages 47 to 50.

② Turn the power off and then on again.

③ Consult your Sony dealer or local authorized Sony service facility.

Table of
contents

Operation
Search

Settings
Search

Index

Battery pack and power

Cannot turn on the camera.

- Attach a charged battery pack.
- Make sure that the battery pack is inserted correctly (page 13).

The power turns off suddenly.

- Depending on the camera and battery temperature, the power may turn off automatically to protect the camera. In this case, a message is displayed on the display panel before the power turns off.
- If you do not operate the camera for a certain period of time while the power is on, the camera turns off automatically to prevent wearing down the battery pack. Turn the camera on again.
- If you have selected [OFF] in the Auto Power Off function, the power does not turn off automatically.

Battery life is short.

- You are using the camera in an extremely hot or cold location, or the charging is insufficient. This is not a malfunction.
- If you have not used the camera for a prolonged period, the efficiency of the battery will be improved by repeatedly charging and discharging it.
- When usable battery life becomes half the usual time, even after charging the battery pack fully, the battery pack may need to be replaced. Consult your nearest Sony dealer.

Cannot charge the camera.

- Turn off the camera and make the USB connection.
- Disconnect the micro USB cable (supplied), and then reconnect it.
- Use the micro USB cable (supplied).
- Charge the battery pack in an ambient temperature of 10°C to 30°C (50°F to 86°F).
- Turn on the computer and connect the camera.
- Release the computer from sleep or hibernation status.
- Connect the camera directly to a computer using the micro USB cable (supplied).
- Connect the camera to a computer with the operating system that is supported by the camera.

The remaining charge indicator is incorrect.

- This phenomenon occurs when you use the camera in an extremely hot or cold location.
- A discrepancy arose between the remaining charge indicator and the actual remaining battery charge. Fully discharge the battery pack once, then charge it to correct the indication.
- Fully charge the battery pack again. If the problem persists, the battery pack is worn out. Replace the battery pack with a new one.

Memory card

Operations using the memory card cannot be performed.

- If you use a memory card formatted on a computer, format it again on the camera (page 27).

Shooting movies

Cannot record images.

- Check the free capacity of the memory card.

Cannot insert dates on images.

- The camera does not have a feature for superimposing dates on images.

Viewing images

Cannot play back images.

- The folder/file name has been changed on your computer.
- Connect a micro HDMI cable (sold separately).

The image does not appear on the TV.

- Check whether the connection is correct (page 38).

Computers

Your computer does not recognize the camera.

- When the battery level is low, charge the camera.
- Turn on the camera and connect to a computer.
- Use the micro USB cable (supplied).
- Disconnect the micro USB cable (supplied) from both the computer and the camera, and connect it again firmly.
- Disconnect all equipment other than the camera, the keyboard and the mouse from the USB connectors of your computer.
- Connect the camera directly to your computer without passing through a USB hub or other device.

Cannot import images.

- Connect the camera and your computer correctly making a USB connection (page 43).

“PlayMemories Home” cannot be installed.

- Check the computer environment or installation procedure required to install “PlayMemories Home.”

“PlayMemories Home” does not work correctly.

- Quit “PlayMemories Home” and restart your computer.

Cannot play back images on your computer.

- Consult the computer or software manufacturer.

Wi-Fi

It takes too much time to transfer an image.

- Microwave ovens or Bluetooth-enabled devices use the 2.4 GHz wavelength and could hinder the communication. If such devices are in the vicinity, move the camera away from those devices or shut those devices down.

Others

The lens gets fogged.

- Moisture condensation has occurred. Turn off the camera and wait about an hour for the moisture to evaporate.
-

The camera becomes warm when you use it for a long time.

- This is not a malfunction.
-

The date or time is incorrect.

- Set the date and time again (page 24).

Warning indicators and messages

If the following messages appear, follow the instructions.



- The battery level is low. Charge the battery pack immediately.

ERROR

- Turn the power off and then on again.

HEAT

- The camera temperature has risen. The power may turn off automatically, or you may be unable to record images. Leave the camera in a cool location until the temperature goes down.
- If you record images for an extended period, the camera temperature rises. In this case, stop recording images.

NoIMG

- The memory card does not contain playable images.

LowPw

- There is no remaining battery charge.

BATT

- Battery charge is insufficient for operation.
- The battery pack is delivering current exceeding the maximum discharge current (beyond which proper operation of the camera cannot be assured when an external microphone, etc., is connected).
- A different battery pack is detected when the camera is powered on.
- Battery pack deterioration is detected.

FULL

- Remaining capacity of the memory card is insufficient for recording.

MAX

- The maximum number of files that can be recorded has been reached.

MEDIA

- The memory card is not inserted properly.
- The memory card is damaged.
- The memory card format is incompatible with this camera.

NoCRD

- There is no memory card inserted.

NoDSP

- The camera is not connected to a TV when playback is started.

Recordable time

Estimated duration of recording and playback for each battery pack

Recording time

Approximate time available when you use a fully charged battery pack.

(Units: minutes)

Battery pack	Continuous recording time		Typical recording time	
	HQ	VGA	HQ	VGA
NP-BX1 (supplied)	140	185	80	110
NP-BG1/FG1	105	145	60	85

- Times measured when using the camera at 25°C (77°F). It is recommended that you use the camera from 10°C to 30°C (50°F to 86°F).
- The recording and playback time will be shorter when you use the camera in low temperatures.
- The recording and playback time may be shorter, depending on the recording conditions.

Playing time

Approximate time available when you use a fully charged battery pack.

Approximate time when images are played back on a TV connected with a micro HDMI cable (sold separately).

(Units: minutes)

Battery pack	Playing time	
	HQ	VGA
NP-BX1 (supplied)	205	210
NP-BG1/FG1	155	160

Estimated recording time of movies

MP4AVC 2ch Average

(Units: minutes)

Recording Mode	8GB	16GB	32GB
HQ	60	125	250
SSLOW	40	80	165
SLOW	80	165	330
STD	160	325	650
VGA	295	600	1205

- In the SLOW/SSLOW setting, the recordable time when shooting differs from when playing back.
- When using a Sony memory card.

Notes

- The recordable time may vary depending on the recording conditions, subjects, and the Recording Mode (page 18).
- Continuous movie shooting time is approximately 13 hours.
 - In [SLOW] mode, it is approximately 6.5 hours.
 - In [SSLOW] mode, it is approximately 3 hours.

Table of contents

Operation Search

Settings Search

Index

Estimated number of recordable photos

(unit: image)

	8GB	16GB	32GB
2M (16:9)	10500	21000	40000

- When using a Sony memory card.
- The number of recordable photos for the memory card shown is for the maximum image size for your camera. The actual number of recordable photos is displayed on the LCD screen during shooting.
- The number of recordable photos for a memory card may vary depending on the shooting conditions.

Note

- The unique pixel array of the Sony ClearVid CMOS Sensor, and the image processing system BIONZ, allow the still image resolution equivalent to the sizes described.

Battery pack

On charging the battery pack

- Charge the battery pack before using the camera for the first time.
- We recommend charging the battery pack in an ambient temperature of between 10°C to 30°C (50°F to 86°F) until the CHG (Charge) lamp turns off. The battery pack may not be effectively charged in temperatures outside this range.
- The CHG (Charge) lamp may lights up in the following situation:
 - Battery pack is not attached correctly.
 - Battery pack is damaged.
- When the battery pack temperature is low, detach the battery pack and place it in warm surroundings.
- When the battery pack temperature is high, detach the battery pack and place it in cool surroundings.

Effective use of the battery pack

- Battery pack performance decreases in low temperature surroundings (less than 10°C (50°F)). So in cold places, the operational time of the battery pack is shorter. We recommend the following to ensure longer battery pack use: Put the battery pack in a pocket close to your body to warm it up, and insert it in the camera immediately before you start shooting.
- The battery pack will run out quickly if you use the playback, fast-forward, and fast-rewind frequently.
- Turn off the camera every time you do not shoot or playback on the camera. Battery pack is wearing out when the shooting is in standby.
- We recommend having spare battery packs handy for two times or three times the expected shooting time, and making trial shots before taking the actual shots.
- You may not be able to turn on the camera or the battery pack may not be effectively charged if the terminal section of the battery pack is dirty. In this case, wipe any dust with a soft cloth lightly to clean the battery pack.
- Do not expose the battery pack to water. The battery pack is not water-resistant.

About the remaining battery charge

- If the battery pack runs out so fast although the remaining charge indicator is high, fully charge the battery pack again. Remaining charge indicator will be displayed correctly. Note that it may not be displayed correctly in the following situations:
 - Using the camera for a long time in high temperature
 - Leaving the camera with fully charged battery pack
 - Using a heavily used battery pack

How to store the battery pack

- Fully discharge the battery pack before storing and store it in a cool, dry place. To maintain the battery pack's function, fully charge the battery pack and then fully discharge it on the camera at least once a year while storing.
- To prevent staining the terminal, short-circuiting, etc., be sure to use a plastic bag to keep away from metal materials when carrying or storing.

On battery pack life

- The battery pack life is limited. Battery capacity decreases over time and through repeated use. If decreased usage time between charges becomes significant, it is probably time to replace it with a new one.
- The battery pack life varies according to how a battery pack is used.

Using the camera abroad

On TV color systems

To view images shot by the camera on a TV, you need a TV (or monitor) with an HDMI jack and a micro HDMI cable (sold separately).

World time difference

Time-zone differences	Area setting
GMT	Lisbon, London
+01:00	Berlin, Paris
+02:00	Helsinki, Cairo, Istanbul
+03:00	Nairobi
+03:30	Tehran
+04:00	Abu Dhabi, Baku, Moscow
+04:30	Kabul
+05:00	Karachi, Islamabad
+05:30	Calcutta, New Delhi
+06:00	Almaty, Dhaka
+06:30	Yangon
+07:00	Bangkok, Jakarta
+08:00	Hong Kong, Singapore, Beijing
+09:00	Seoul, Tokyo
+09:30	Adelaide, Darwin

Time-zone differences	Area setting
+10:00	Melbourne, Sydney
+11:00	Solomon Is
+12:00	Fiji, Wellington, Eniwetok, Kwajalein
-11:00	Samoa
-10:00	Hawaii
-9:00	Alaska
-8:00	Los Angeles, Tijuana
-7:00	Denver, Arizona
-6:00	Chicago, Mexico City
-5:00	New York, Bogota
-4:00	Santiago
-3:30	St.John's
-3:00	Brasilia, Montevideo
-2:00	Fernando de Noronha
-1:00	Azores, Cape Verde Is.

Precautions

Do not use/store the camera in the following places

- In an extremely hot, cold or humid place
In places such as in a car parked in the sun, the camera body may become deformed and this may cause a malfunction.
- Under direct sunlight or near a heater
The camera body may become discolored or deformed, and this may cause a malfunction.
- In a location subject to strong vibration
- Near strong magnetic fields
- In sandy or dusty places
Be careful not to let sand or dust get into the camera. This may cause the camera to malfunction, and in some cases may be irreparable.

On carrying

Do not sit down in a chair or other place with the camera in the back pocket of your trousers or skirt, as this may cause malfunction or damage the camera.

Care and storage of the lens

- Wipe the surface of the lens clean with a soft cloth in the following instances:
 - When there are fingerprints on the lens surface.
 - In hot or humid locations
 - When the lens is exposed to salty air such as at the seaside.
- Store in a well-ventilated location subject to little dirt or dust.
- To prevent mold, periodically clean the lens as described above.

On cleaning

Clean the camera surface with a soft cloth slightly moistened with water, then wipe the surface with a dry cloth. Do not use any of the following as they may damage the finish or the casing.

- Chemical products such as thinner, benzine, alcohol, disposable cloths, insect repellent, sunscreen or insecticide, etc.
- Do not touch the camera with any of the above on your hand.
- Do not leave the camera in contact with rubber or vinyl for a long time.

On operating temperatures

The camera is designed for use in temperatures between 0°C and 40°C (32°F and 104°F). Shooting in extremely cold or hot places that exceed this range is not recommended.

On moisture condensation

If the camera is brought directly from a cold to a warm location, moisture may condense inside or outside the camera. This moisture condensation may cause a malfunction of the camera.

If moisture condensation occurs

Turn off the camera and wait about 1 hour for the moisture to evaporate.

Note on moisture condensation

Moisture may condense when you bring the camera from a cold place into a warm place (or vice versa) or when you use the camera in a humid place as shown below.

- When you bring the camera from a ski slope into a warm place.
- When you bring the camera from an air conditioned car or room into a hot place outside.
- When you use the camera after a squall or a shower.
- When you use the camera in a hot and humid place.

How to avoid moisture condensation

When you bring the camera from a cold place into a warm place, put the camera in a plastic bag and seal it tightly. Remove the bag when the air temperature inside the plastic bag has reached the ambient temperature (after about 1 hour).

Notes on optional accessories

- Genuine Sony accessories may not be available in some countries/regions.

Note on disposal/transfer of the memory card

Even if you delete data in the memory card or format the memory card on the camera or a computer, you may not delete data from the memory card completely. When you give the memory card to somebody, it is recommended that you delete data completely using data deletion software on a computer. Also, when you dispose of the memory card, it is recommended that you destroy the actual body of the memory card.

Specifications

Camera

[System]

Video signal

- NTSC color, EIA standards
- HDTV 1080/60i, 1080/60p specification

Image device:

- 7.77 mm (1/2.3 type)
- Exmor R CMOS sensor

Recording pixels (still, 16:9):

- Max. 20 000 000 pixels equivalent

Gross: Approx. 16 800 000 pixels

Effective (movie, 16:9):

- Approx. 11 900 000 pixels

Effective (still, 16:9): Approx. 11 900 000 pixels

Lens: Carl Zeiss Tessar Lens

- F2.8
- f = 2.5 mm (1/8 in.)
- When converted to a 35 mm still camera
- For movies: 15.3 mm (5/8 in.) (16:9)*

Exposure control: Automatic exposure

File format:

- Still images: JPEG (DCF Ver. 2.0, Exif Ver. 2.3, MPF Baseline) compliant
- Movies: MPEG-4 AVC/H.264 (MP4)
- Audio: MPEG AAC

Recording media:

- “Memory Stick Micro” (Mark2) media
- microSD card (Class4 or faster)
- microSDHC memory card (Class4 or faster)

Minimum illumination: 6lx (lux)

* SteadyShot set to [OFF]

[Input and Output connectors]

HDMI OUT jack: HDMI micro connector

USB jack: micro-B/USB2.0 Hi-Speed (mass-storage)

[Power, general]

Power requirements:

- Rechargeable battery pack 3.6 V (NP-BX1 (supplied)),
- Rechargeable battery pack 3.6 V (NP-BG1/FG1)
- USB 5.0 V

USB charging: DC 5.0 V, 500 mA/600 mA

Charging time:

Via a computer

- NP-BX1 (supplied): Approx. 245 min
- NP-BG1/NP-FG1: Approx. 185 min

Via a AC-UD20 (sold separately)

- NP-BX1 (supplied): Approx. 175 min
- NP-BG1/NP-FG1: Approx. 140 min

Power consumption: 1.7 W (when the movie image size is [1920×1080 30P])

Operating temperature: 0°C to 40°C (32°F to 104°F)

Storage temperature: -20°C to +60°C (-4°F to +140°F)

Dimensions: Approx. 24.5 mm × 47.0 mm × 82.0 mm (31/32 inches × 1 7/8 inches × 3 1/4 in.) (W/H/D, excluding protrusions)

Mass: Approx. 65 g (2.3 oz) (camera only)

Mass (when shooting):

- Approx. 90 g (3.2 oz) (including NP-BX1 (supplied))
- Approx. 92 g (3.2 oz) (including NP-BG1/FG1)

Microphone: Stereo

Speaker: Monaural

Rechargeable battery pack:

NP-BX1 (supplied)

- Maximum output voltage: DC 4.2 V
- Output voltage: DC 3.6 V
- Capacity:

Minimum: 4.5 Wh (1,240 mAh)

Type: Li-ion

NP-BG1/FG1

- Maximum output voltage: DC 4.2 V
- Output voltage: DC 3.6 V
- Maximum charge voltage: DC 4.2 V
- Maximum charge current: 1.44 A
- Capacity:

Minimum: 3.3 Wh (910 mAh)

Type: Li-ion

[Wireless LAN]

Corresponding standard: IEEE 802.11/b/g/n/

[Accessories]

Waterproof Case (SPK-AS1)

- Dimensions: Approx. 35.5 mm × 71.0 mm × 105.5 mm (1 7/16 in. × 2 7/8 in. × 4 1/4 in.) (W/H/D, excluding protrusions)

Mass: Approx. 85 g (3.0 oz)

Pressure-resistance: To a depth of up to 60 m (197 feet) underwater*

*When the camera is inserted.

Adhesive Mount (VCT-AM1)

Attachment Buckle

- Dimensions: Approx. 43.5 mm × 14.0 mm × 58.5 mm (1 3/4 in. × 9/16 in. × 2 3/8 in.) (W/H/D, excluding protrusions)

Mass: Approx. 15 g (0.5 oz)

Flat Adhesive Mount

- Dimensions: Approx. 50.0 mm × 12.5 mm × 58.5 mm (2 in. × 1/2 in. × 2 3/8 in.) (W/H/D, excluding protrusions)

Mass: Approx. 14 g (0.5 oz)

Curved Adhesive Mount

Dimensions: Approx. 50.0 mm × 16.0 mm × 58.5 mm (2 in. × 21/32 in. × 2 3/8 in.) (W/H/D, excluding protrusions)

Mass: Approx. 16 g (0.6 oz)

Waterproof Head Mount Kit (VCT-GM1) (sold separately)

Goggle Mount

Dimensions: Approx. 53.0 mm × 81.5 mm × 63.5 mm (2 1/8 in. × 3 1/4 in. × 2 1/2 in.) (W/H/D, not including a Headband)

Mass: Approx. 69 g (2.4 oz) (not including a Headband)

Headband

Length: Approx. 400 mm - 600 mm (15 3/4 in. - 23 5/8 in.) (adjustable)*

*Head size Approx. 450 mm - 650 mm (17 3/4 in. - 25 5/8 in.) is recommended.

Width: Approx. 38 mm (1 1/2 in.)

Mass: Approx. 40 g (excluding the goggle mount)

Headband Mount (BLT-HB1) (sold separately)

Dimensions: Approx. 56.0 mm × 58.0 mm × 77.5 mm (2 1/4 in. × 2 3/8 in. × 3 1/8 in.) (W/H/D, excluding protrusions, not including a head strap)

Mass: Approx. 91 g (3.2 oz) (including a head strap)

Head strap

Length: Approx. 400 mm - 600 mm (15 3/4 in. - 23 5/8 in.) (adjustable)*

*Head size Approx. 450 mm - 650 mm (17 3/4 in. - 25 5/8 in.) is recommended.

Width: Approx. 25 mm (1 in.)

Design and specifications are subject to change without notice.

Trademarks

- “Memory Stick,” “,” “Memory Stick Duo,” “MEMORY STICK DUO,” “Memory Stick PRO Duo,” “MEMORY STICK PRO DUO,” “Memory Stick PRO-HG Duo,” “MEMORY STICK PRO-HG DUO,” “Memory Stick Micro,” “MagicGate,” “MAGICGATE,” “MagicGate Memory Stick” and “MagicGate Memory Stick Duo” are trademarks or registered trademarks of Sony Corporation.
- HDMI, the HDMI logo and High-Definition Multimedia Interface are trademarks or registered trademarks of HDMI Licensing LLC in the United States and other countries.
- Microsoft, Windows, Windows Vista, and DirectX are either registered trademarks or trademarks of Microsoft Corporation in the United States and/or other countries.
- Mac and Mac OS are registered trademarks of Apple Inc. in the U.S. and other countries.
- Intel, Intel Core, and Pentium are trademarks or registered trademarks of Intel Corporation or its subsidiaries in the United States and other countries.
- Adobe, the Adobe logo, and Adobe Acrobat are either registered trademarks or trademarks of Adobe Systems Incorporated in the United States and/or other countries.
- microSD logo and microSDHC logo are trademarks of SD-3C, LLC.

In addition, system and product names used in this manual are, in general, trademarks or registered trademarks of their respective developers or manufacturers. However, the TM or ® marks are not used in all cases in this manual.

On GNU GPL/LGPL applied software

The software that is eligible for the following GNU General Public License (hereinafter referred to as “GPL”) or GNU Lesser General Public License (hereinafter referred to as “LGPL”) are included in the camera.

This informs you that you have a right to have access to, modify, and redistribute source code for these software programs under the conditions of the supplied GPL/LGPL.

Source code is provided on the web. Use the following URL to download it. When downloading the source code, select HDR-AS10 as the model for your camera.

<http://www.sony.net/Products/Linux/>

We would prefer you do not contact us about the contents of source code.

Copies of the licenses (in English) are stored in the internal memory of your camera.

Establish a Mass Storage connection between your camera and a computer, and read the files in the “LICENSE” folder in “PMHOME.”

Index

A	
A.OFF.....	23
ANGLE.....	20
B	
Battery pack.....	53
C	
Charging.....	14
CHG (Charge) lamp.....	14
D	
DATE.....	24
E	
ENTER (Menu execute) button.....	10
F	
FORMT.....	27
H	
HDMI OUT jack.....	38
HOLD switch.....	37
I	
Identifying parts.....	11
Interval Photo Recording.....	21
L	
LAPSE.....	21
N	
NEXT button.....	10
Number of recordable photos.....	52
P	
PLAY.....	38
PREV button.....	10
R	
REC START/STOP button.....	37
REC/access lamp.....	37
Recordable time of movies.....	51
RESET.....	26
RMOTE.....	22
S	
SEND.....	39
Settings.....	10
Shooting	
Movies.....	37
Still image.....	37
STEDY.....	19
T	
Troubleshooting.....	46
U	
USB.....	14
USB jack.....	43
USBPw.....	25
V	
VIDEO.....	18
View	
Movies.....	38
Still image.....	38
W	
Warning messages.....	50