

FEATURES:

Induro Tripods are available in two categories and four collections:

Aluminum Alloy Tripods

Alloy 6M

The INDURO Alloy 6M A-Series tripods are made from high quality aluminum alloy and precisely machined to offer the quality and strength demanded by professionals. Each leg is extruded 6000 series Aluminum with a wall thickness of 1.5mm. Each leg lock has a specially design anti-dust and moisture seal, along with removable rubber or stainless steel spikes (excluding A012, A013, A014 and A114).

AlloyFlex 6M

The INDURO ALLOYFLEX 6M AX-Series aluminum tripods offers a quick switch from vertical to horizontal center column positions. They are made from high quality aluminum alloy and precisely machined to offer the quality and strength demanded by professionals. Each leg is extruded 6000 series Aluminum with a wall thickness of 1.5mm.Each leg lock has a specially design anti-dust and moisture seal, along with removable rubber or stainless steel spikes (excluding Ax114).

Carbon Fiber Tripods

Carbon 8X

The INDURO CARBON 8X C-Series carbon fiber tripods offers the ultimate in strength, lightweight, fast action and reliable performance. They are made of the latest generation of high quality 8-layer carbon fiber tubing. The C-Series is 60% stronger overall than conventional carbon fiber tripods. Each leg lock has a specially design anti-dust and moisture seal, along with removable rubber or stainless steel spikes.

CarbonFlex 8X

The INDURO CARBONFLEX 8X CX-Series carbon fiber tripods offers a quick switch from vertical to horizontal center column positions. They are made of the latest generation of high quality 8-layer carbon fiber tubing. CarbonFlex 8X tripods are 60% stronger than conventional carbon fiber tripods. Each leg lock has a specially design anti-dust and moisture seal, along with removable rubber or stainless steel spikes.

IDENTIFYING TRIPOD MODEL NUMBERS:

Tripod Model Number Example:

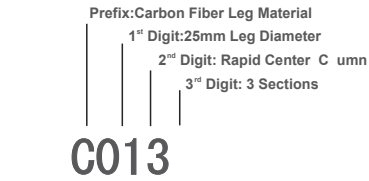

Letter	Letter	1 st Digit	2 nd Digit	3 rd Digit
Leg Material	Special Feature	Leg Diameter	Column Type	Number of leg sections
A = Aluminum	X = Flexible Positioning Column	Aluminum	1 = Rapid Column	3 = 3 section
C = Carbon Fiber		0 = 25mm	2 = Geared Column	4 = 4 section
		1 = 29mm		
		2 = 33mm		
		3 = 37mm		
		4 = 41mm		
		Carbon Fiber		
		0 = 27mm		
		1 = 30mm		
		2 = 33mm		
		3 = 37mm		
		4 = 41mm		

USER NOTICE:

- Your Induro Tripod has been designed for years of maintenance free use. Please follow the guidelines below to ensure the best performance, reliability and durability expected from Induro Gear.
- Do not exceed the maximum specified load capacity (see product specification chart) !
 - Always ensure that leg locks are tightly engaged before mounting a camera on the tripod !
 - Do not use the tripod below temperatures of -4°F or above +158°F (-20°C / +70°C) !
 - Always clean and dry the tripod after it has been exposed to wet, dusty, sandy or salty conditions. Your tripod is not recommended for use in salt water. Clean the tripod with a mild soap and soft cloth. Remove any dust, dirt or sand from all leg locks, leg lock threads, leg sections and all moving parts. !
 - Do not leave the product in the sun for prolonged periods and avoid high temperature exposure(For example in the trunk of a car or exposed to sun behind a glass window for hours) !
 - Avoid leaving the tripod unattended in areas where people could trip over the tripod and get hurt !
 - It is recommended that any equipment (camera's etc) be removed from the tripod when transporting the tripod.
 - For you safety, don't let your Induro tripod come in contact with any electrical power source !

SETUP:

Before using your tripod, adjust each leg section to the desired height and leg angle setting. Ensure that the tripod is firmly resting on a level surface and mount your camera securely on the tripod head. Always engage any safety locks on the tripod head to prevent any accidental dismounting.

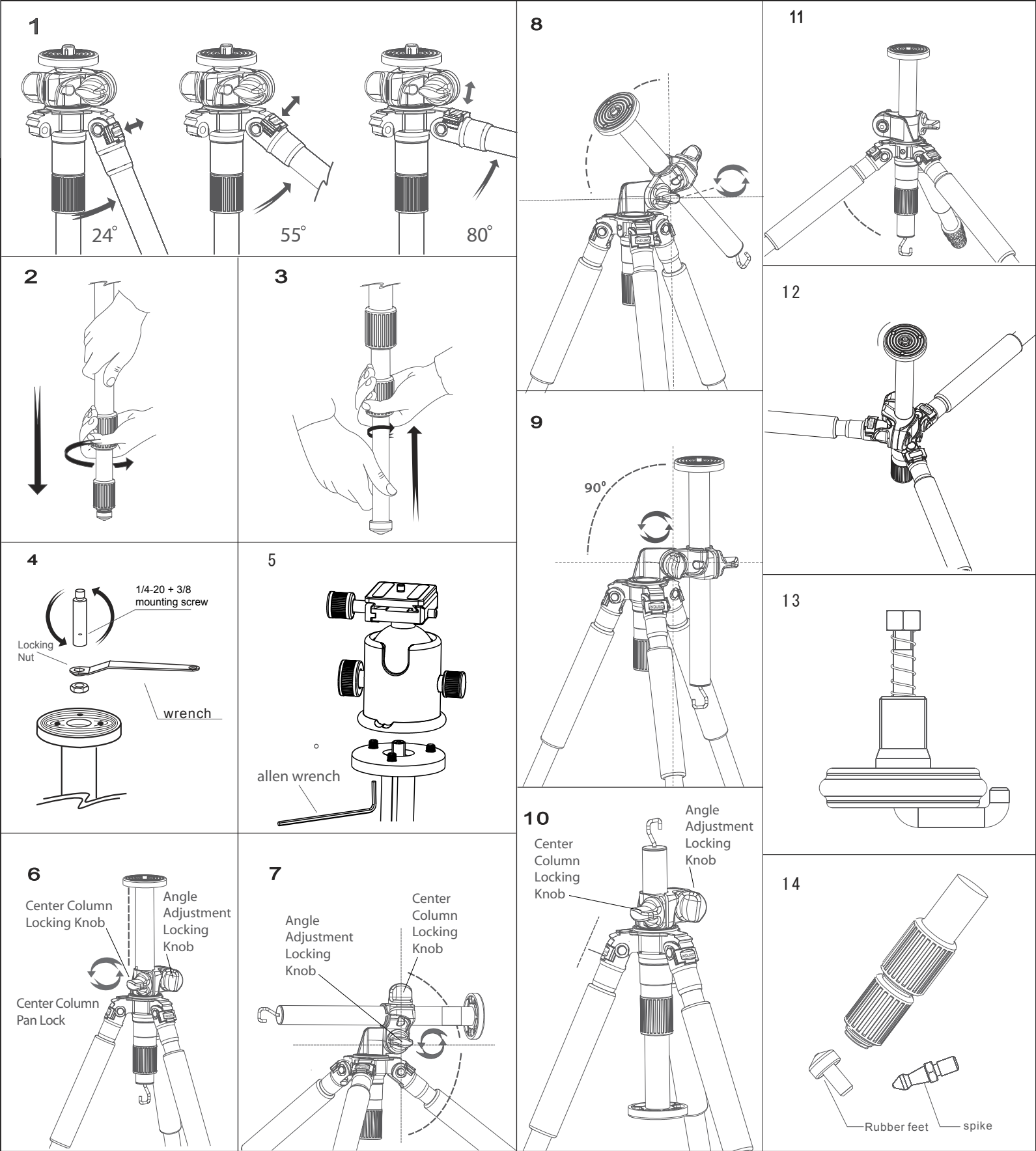

Alloyflex 6m Aluminium Tripods

	Model NO	Sections	Max. D (mm)	Min. D (mm)	Max.H (mm)	Normal H (mm)	Min.H1 (mm)	Folded1 (mm)	Weight (kg)	MaxLoad (kg)
1	AX-113	3	ø 24	ø 16	1585	1280	200	575	1.82	4.5
	AX-114	4	ø 24	ø 12	1605	1300	200	500	1.73	4.5
2	AX-213	3	ø 28	ø 20	1765	1460	200	660	2.43	8
	AX-214	4	ø 28	ø 16	1770	1465	200	555	2.26	8

Carbonflex 8x Carbon Fiber Tripods

	Model NO	Sections	Max. D (mm)	Min. D (mm)	Max.H (mm)	Normal H (mm)	Min.H1 (mm)	Folded1 (mm)	Weight (kg)	MaxLoad (kg)
1	CX-113	3	ø 25	ø 16	1595	1290	200	595	1.52	4.5
	CX-114	4	ø 25	ø 12	1610	1305	200	515	1.55	4.5
2	CX-213	3	ø 28	ø 20	1715	1410	200	650	1.85	8
	CX-214	4	ø 28	ø 16	1645	1340	200	535	1.88	8

Leg Angle Adjustment: (See figure 1) To accommodate uneven terrain, awkward shooting situations or for low angle shooting, your Induro tripod includes a 3-position leg angle adjustment sliding lock. Each leg can be independently adjusted by pulling the sliding leg angle lock out and selecting one of the three step positions (24, 55 or 80 degrees). Ensure that the leg angle lock is securely pushed back into the lock position after you have selected the desired leg angle.

Leg Section Adjustment: (See figure 2 & 3) Each leg section can be independently adjust to the desired length by turning the proper leg lock grip counter-clockwise until the leg is free to slide in or out. Once the desire length is achieved turn the leg lock grip clock-wise until the leg section is securely locked. Repeat this step for each leg and each section until the tripod is set to the desired height.
Please note: To prevent any accidental damage to your gear, always remove any mounted equipment (camera, etc) from the tripod before adjusting the leg sections.

Reversible 3/8" or 1/2-20" mounting screw: (See figure 4) Your Induro tripod incorporates a reversible mounting screw that accommodates any tripod head mounting thread (3/8" or 1/2-20"). The tripod is factory shipped in the 3/8" mounting thread exposed. If it becomes necessary to reverse the mounting screw to the 1/2-20" side, loosen the locking nut counter-clockwise (using the included wrench) until it becomes loose and unscrew the mounting screw until it can be complete removed. Reverse the screw, so that the 1/2-20" heads are in position and screw it back into place, secure with the locking nut and wrench.
Please note: Allow enough of the screw threads to be available for maximum security when the tripod head is mounted onto the tripod. It's recommended that at least 5 to 6 threads be exposed for before locking the mounting screw in place.

Mounting plate set screws: (See figure 5) Some tripod manufactures require additional mounting security and provide openings on the bottom of the tripod head mounting plate to accommodate setscrews. Your Induro tripod includes setscrews to securely mount these types of tripod heads. Once the tripod head is screwed onto the center mounting screw (3/8" or 1/2-20") tighten each of the three set screws with the provided Allen wrench until there are tightly secured.

Raising and Lowering the Center Column: (See figure 6) To raise or lower the center column, turn the center locking knob counter-clockwise and set the column to the desired position. While holding the column in position, turn the column locking knob clockwise to secure the column in place. Don't over tighten the center column lock, as this could damage the threads.
Please note: Take special care when raising or lowering the center column, if a camera or equipment is mounted on the tripod. Never loose the center column lock without holding the center column. Failure to follow these instructions could result in damaged equipment.

Reversible Center Column: (See figure 10) Your tripod offers the ability to reverse the center column for close-up photography, copy work and for difficult to reach object. To reverse the center column loosen the center column locking knob and pull the center column out. Insert the center column with the mounting plate upside down (see figure 10) and retighten the center column locking knob securely.

Please note: Do not reverse the center column when a camera or equipment is mounted.

Interchangeable Spiked and Rubber Feet: (See figure 14) All Induro tripods (excluding A012, A013, A014, A114 and AX114) include interchangeable stainless steel spiked or rubber feet. They provide the right contact depending on the surface or terrain that the tripod will be use in. To remove the rubber feet simple unscrew each rubber foot counter-clockwise and replace with the provided spiked foot (see the tool kit) and secure using the included wrench. Both the rubber and spiked feet can be stored in the tool kit pouch. The tool pouch can be clipped onto the tripod strap ring or attached to the tripod leg with the Velcro strap on the back of the tool kit pouch.

Anti-Twist Leg Sections: For quick and easy setup each leg section(excluding the last section) incorporates a key and groove within the leg to prevent the leg from rotating.

Retractable Weight Hook: (See figure 13) When additional weight is necessary to add to the tripod for stability during windy conditions, the retractable weight hook can be used to hold a sandbag, camera bag or any similar item. Take care not to overload the tripod with weight as this could have a reverse effect on increasing the tripods stability

5-Position FLEX Column: (See figure 7,8,9) The FLEX column offers vertical and horizontal center column positioning. In a rapid and convenient motion, the center column canbe converted from a standard vertical column to a horizontal cross bar. In the horizontal position, a mounted camera can have a clear view (without the tripod legs getting in the way), to achieve challenging and creative angles. The Flex column is ideal for flat artwork, close-up macro photography and for shoots that require total flexibility in camera position. When the column is returned to the standard vertical position, it unique design positions it back in the center of the main casting ensuring prefect center gravity and balance.

1.Vertical column positioning (See figure 6,9) Unlock center column locking knob (counter-clockwise) to raise or lower center column to desired position and than turn (clockwise) to re-lock.

2.Horizontal column positioning (See figure 7) Unlock the center column locking knob and raise the center column up until it clears the main casting. Unlock the Horizontal locking knob and position the column in the desired position. Once the center column is at the desired angle and position lock both the vertical and horizontal locking knobs.

3.Center column panning (See figure 6) Unlock the column panning locking knob to pan the entire FLEX column assembly and re-lock when the desired position is attended.

4.Center column angular positioning (See figure 8) Unlocking the horizontal locking knob provides full angular adjustment of the column, while it is in the horizontal position.

5.Center column rotation (See figure 7) Unlocking the center columns vertical locking knob provides full rotational adjustment of the column, while it is in the horizontal position.

Please Note: When adjusting the position of the center column, it is recommended that the mounted equipment or camera be removed to avoid accidental damage. In the horizontal column position, it is recommended that a weight (sand bad, camera bag, or similar item) be used at the opposite end of the mounted equipment or camera. This weight will act as a counter balance and avoid the tripod from falling over because of unequal weight distribution.