

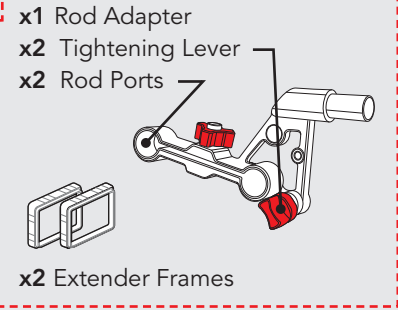

Sony FS5 EVF & Z-Finder Recoil Kits

The Sony FS5 Recoil shoulder-mounted rig includes our VCT Universal baseplate, the FS5 Grip Relocator for the Sony FS5 handgrip, a 13.5" LANC extension cable, the FS5 Top Plate, and our Axis Mini for Sony FS5 which can be used with either the Gratical HD or the Sony LCD monitor with Zacuto Z-Finder.

Parts & Features

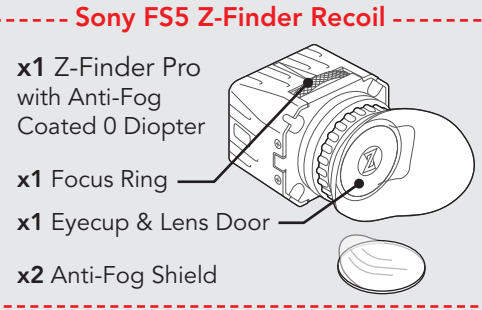
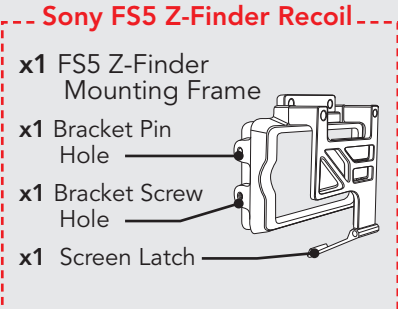
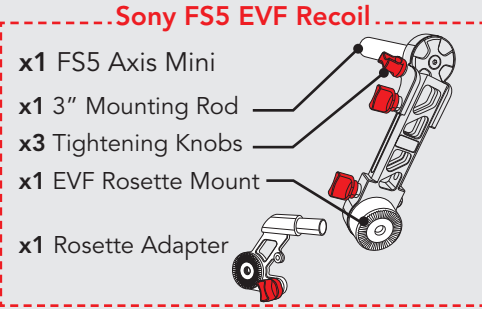
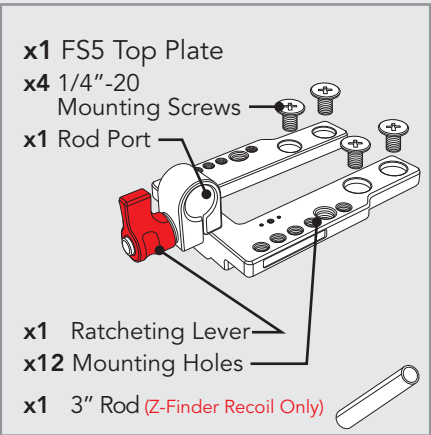
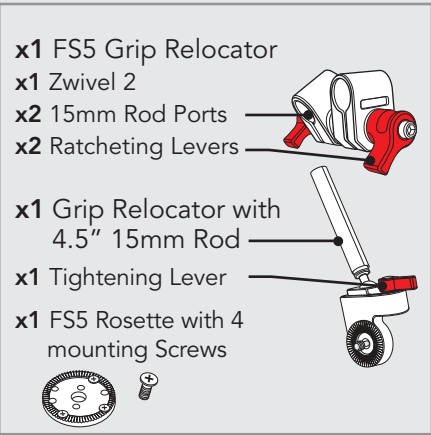
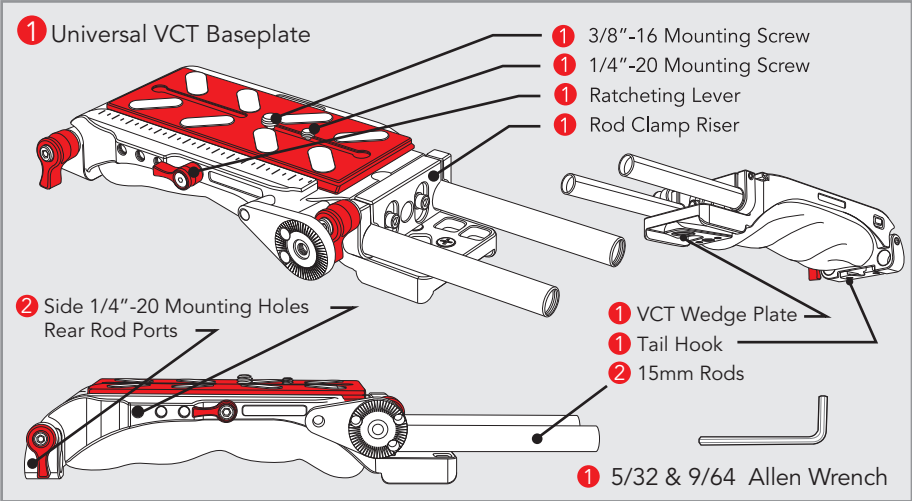

For additional assembly and individual component features, see numerical figures.

Sony FS5 EVF Recoil

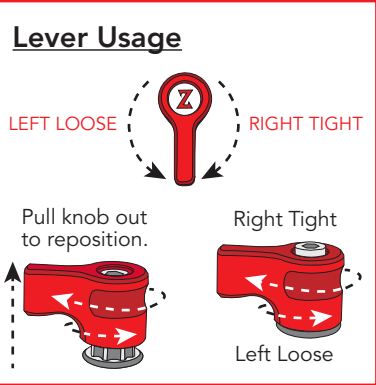
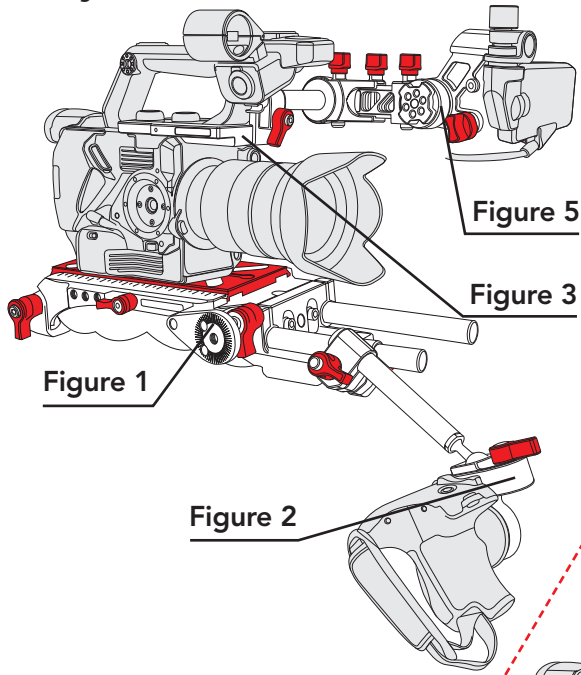

Sony FS5 Z-Finder Recoil

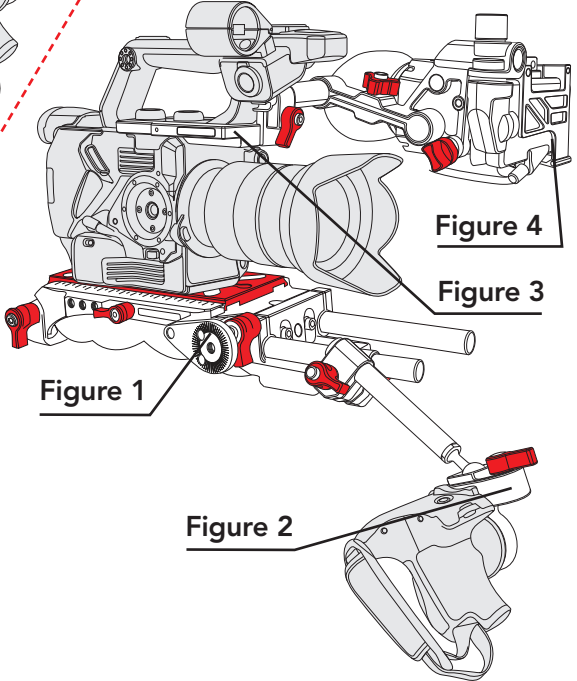

Figure 1:a Mounting Camera (EVF & Z-Finder Recoil)

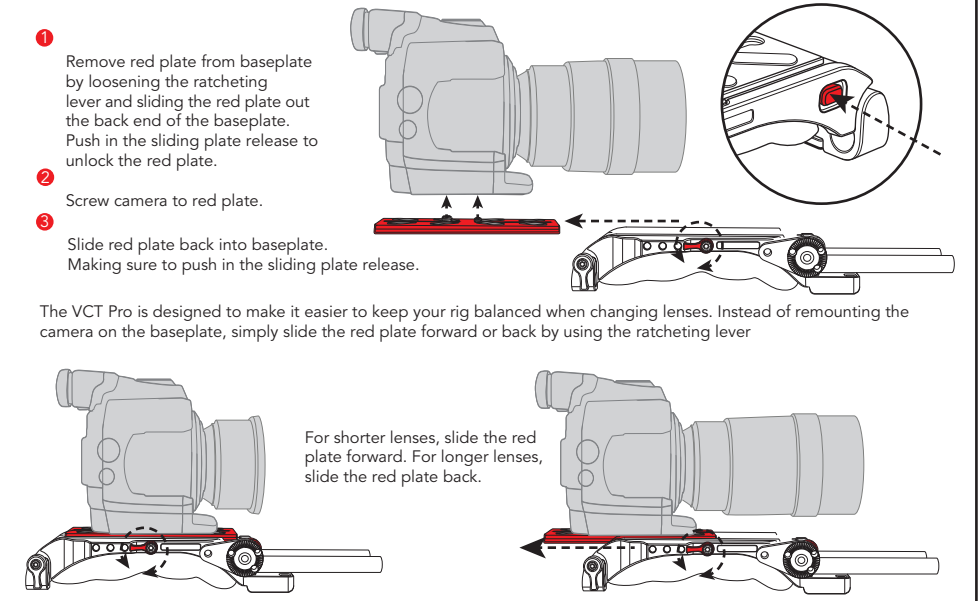

Figure 1:b Adjusting Rods

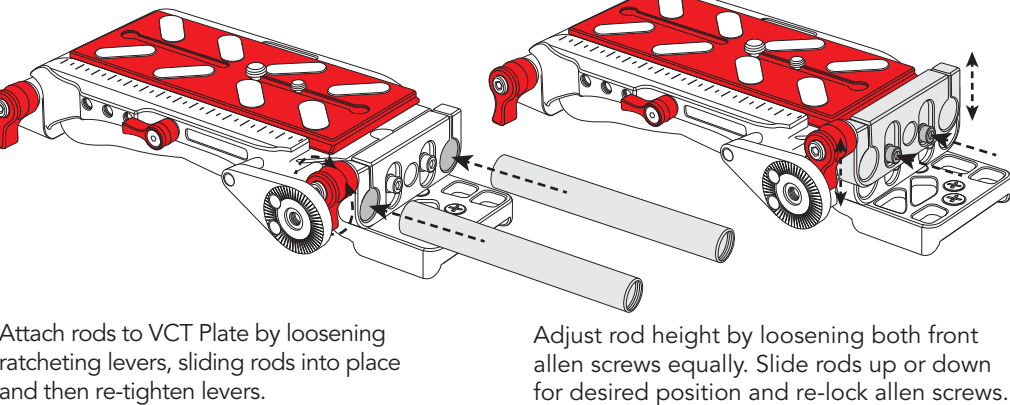
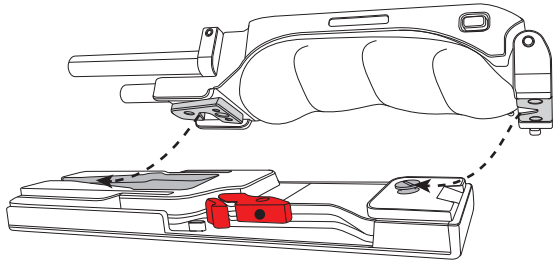
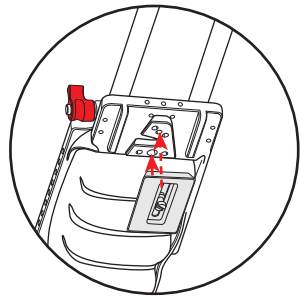

Figure 1:c Mounting VCT Plate to VCT-14 Tripod Quick Release Plate (VCT-14 Sold Separately)

Mounting VCT Pro to VCT-14 (VCT-14 Sold Separately)

Mount VCT Plate to VCT-14 by sliding the front wedge into front slot of the VCT-14 and the tail hook around the rear knob of VCT-14. The VCT-14 will click when the VCT Plate is locked into place



Pull red lever on VCT-14 to release your Universal VCT Plate.

Tripod Quick Release Plate

An alternative mounting method when using a tripod without a VCT-14, is to mount your tripod's quick release wedge plate to the wedge on the bottom of the VCT Pro.

Figure 1:d Adjusting Rods

For Red Epic/Scarlet flip the rod clamp riser.

- 1 Remove both allen screws and separate front jeep with rods from VCT body.
- 2 Flip front rods over from original position.
- 3 Align and remount allen screws to VCT body. Adjust to desired height and re-lock allen screws.

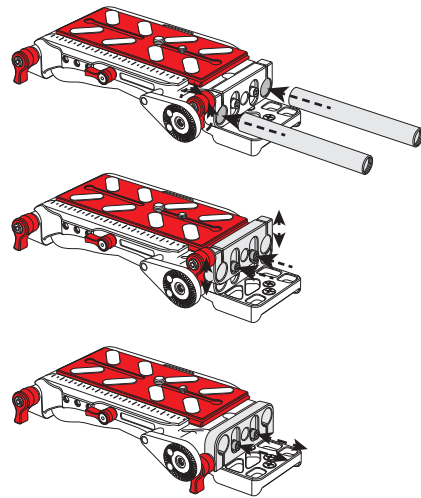

Figure 2:a Assembling & Operating Sony FS5 Grip Relocator

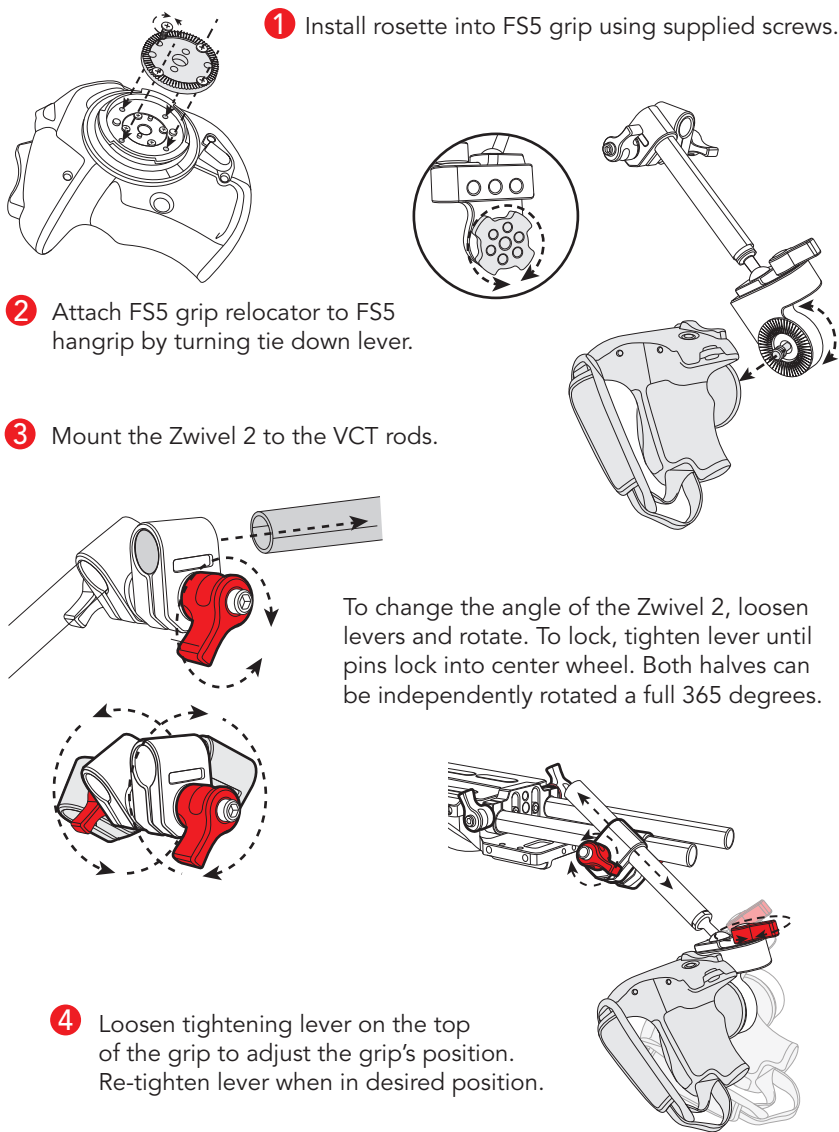

Figure 3:a Assembling Sony FS5 Top Plate

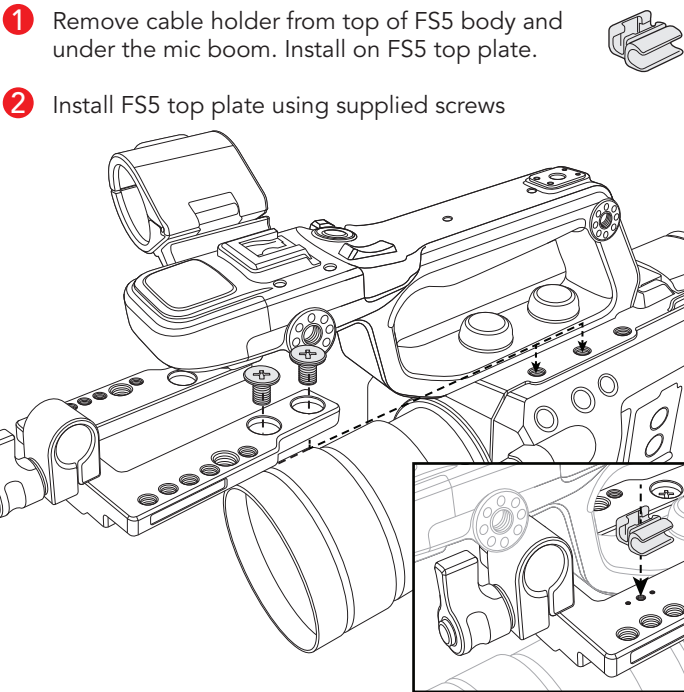

Figure 4:a Assembling the FS5 Z-Finder

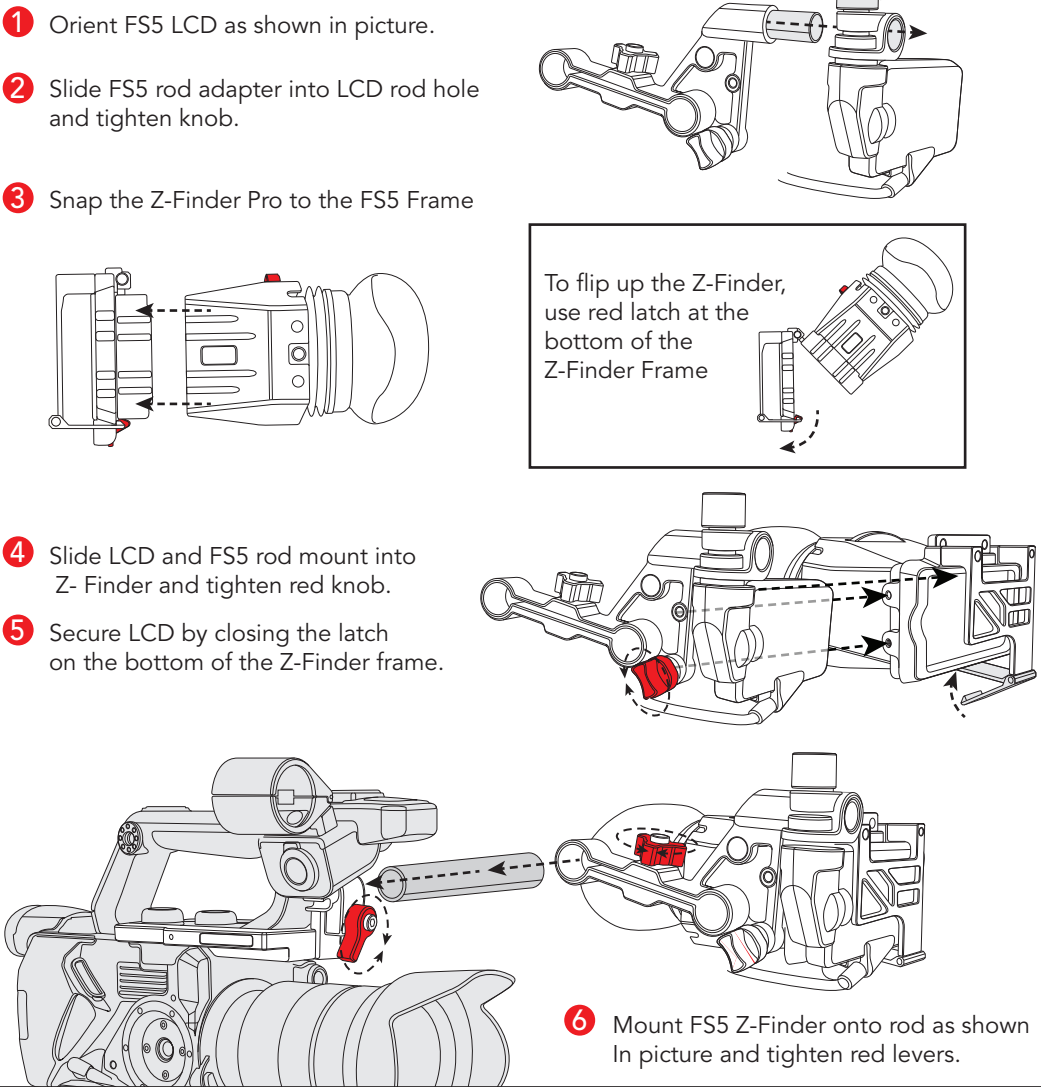

Figure 4:b Operating FS5 Z-Finder

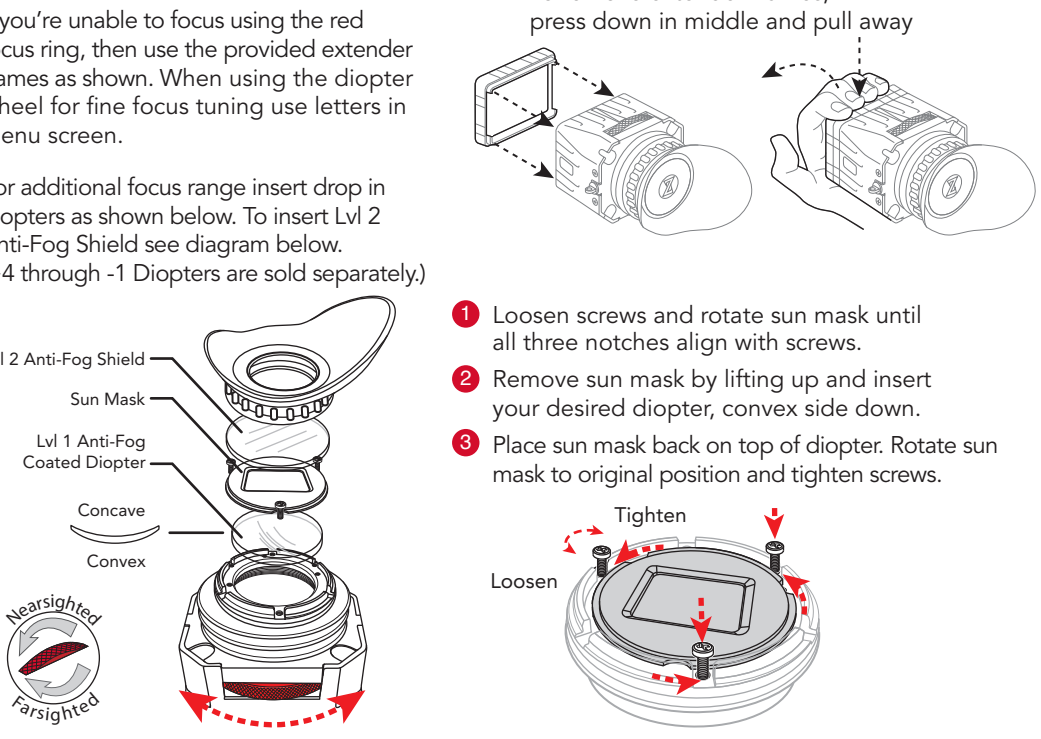

Figure 5:a Operating Axis Mini

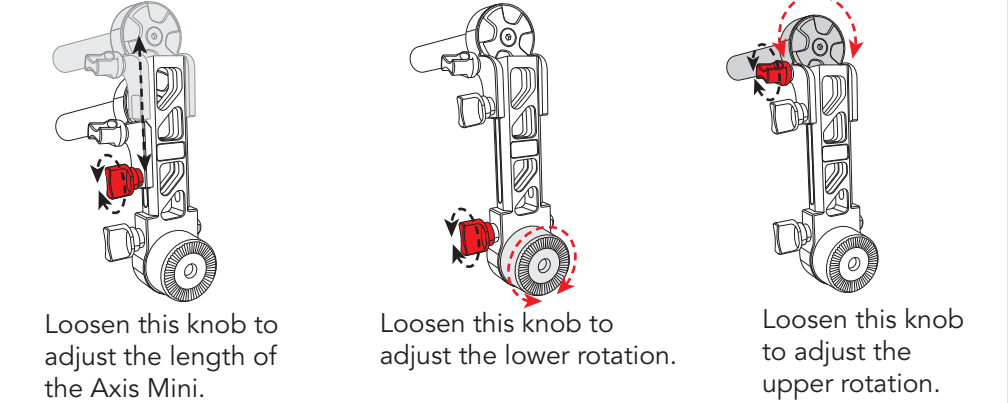

Figure 5:b Assembling FS5 Axis Mini to FS5 Top Plate and Sony LCD

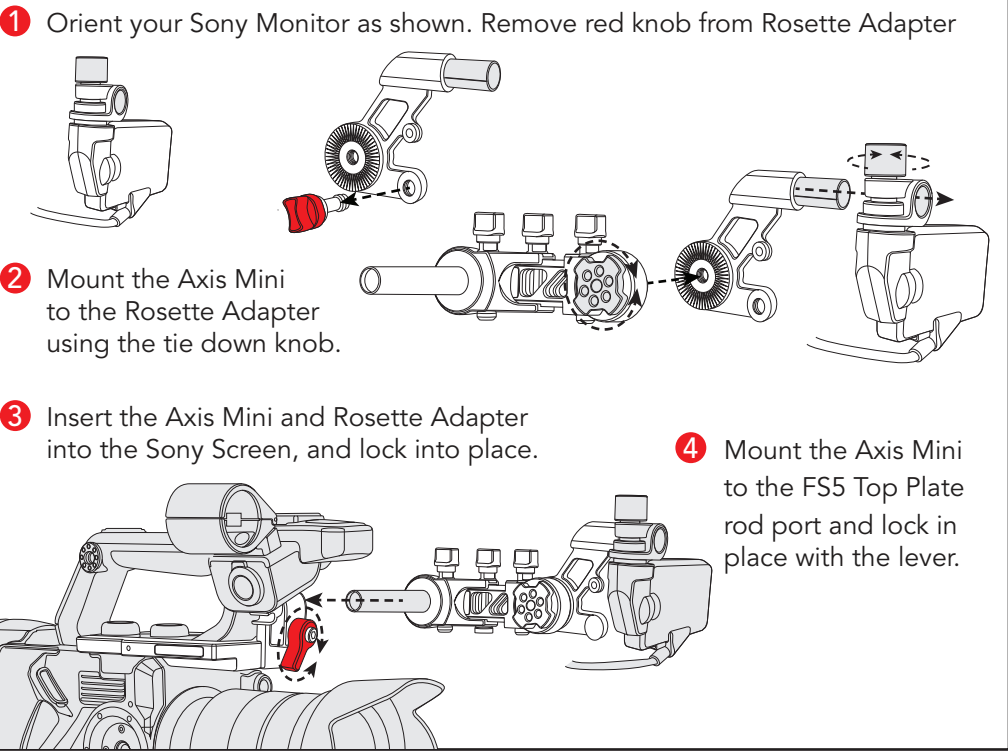
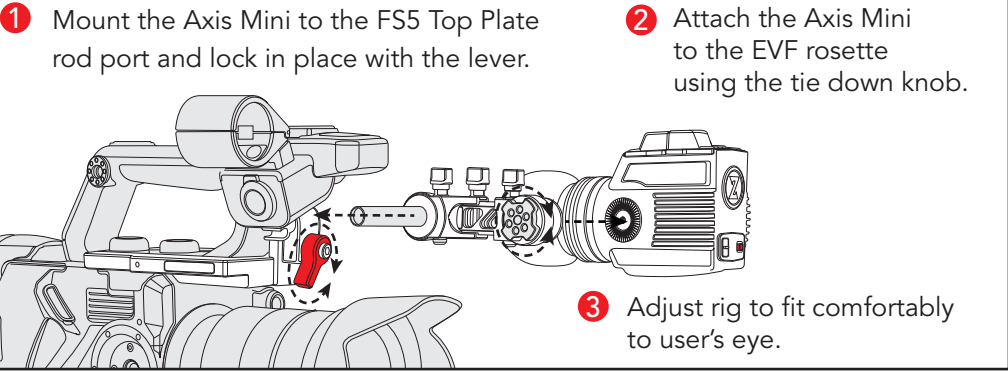

Figure 5:c Assembling FS5 Axis Mini to FS5 Top Plate and EVF



See front figure for full correct Assembly
Check out our tutorial videos at [zacuto.com](https://www.zacuto.com)
For additional accessories visit store.zacuto.com
Version 1.0 022316