

1

Syrp



# Quick Start Guide

2

## Genie Mini

An extremely easy-to-use device for creating smooth panning motion time-lapse or real-time video. Wirelessly connect to the Genie Mini using the Syrp Genie App for quick setup and simple motion control.

This Quick Start Guide will take you through the basics to get you started using your Genie Mini for the first time.

A full user manual can be found on the support page at [www.syrp.co.nz](http://www.syrp.co.nz)

3

## Whats in the Box

- Genie Mini



- 1/4" to 3/8" Thread adapter (screwed into the base)

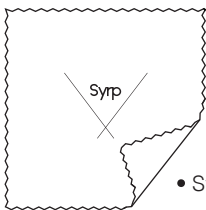

- Syrp Micro Fiber cloth

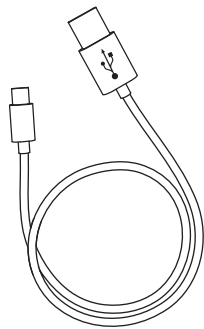

- USB charging cable

4

## Genie Mini Interface

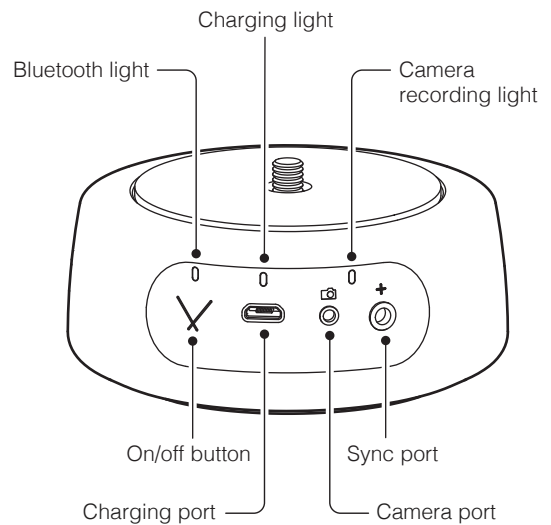

5

## Charging

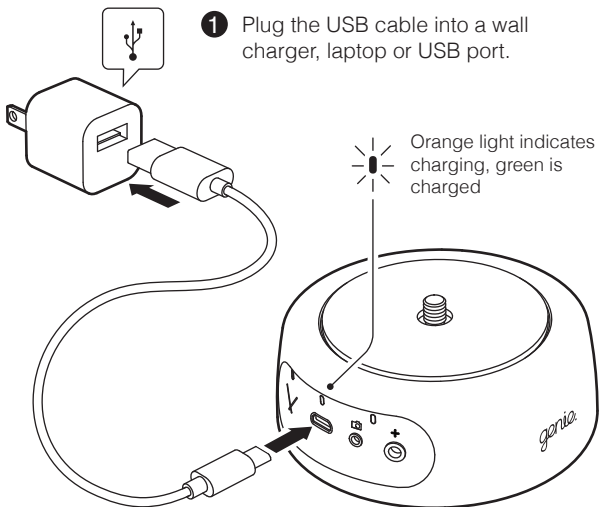

- 1 Plug the USB cable into a wall charger, laptop or USB port.

- 2 Plug the Micro-USB plug into the Genie Mini charging port.

6

## Mount the Genie Mini

- 1 Screw the Genie Mini to a tripod head or tripod legs. The thread adapter in the base can be used for smaller threads.
- 2 Screw your camera to the top of the Genie Mini.

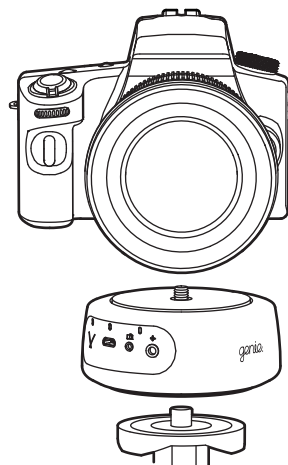

Try a ballhead between the camera & Genie Mini to easily frame your shots

7

### Link Cable

- 1 Plug the 2.5mm end into the camera port on the Genie Mini marked with a green camera icon.
- 2 Plug the other end into the remote port on your camera. Consult your camera manual to find the correct port.

The link cable is not required for video recording

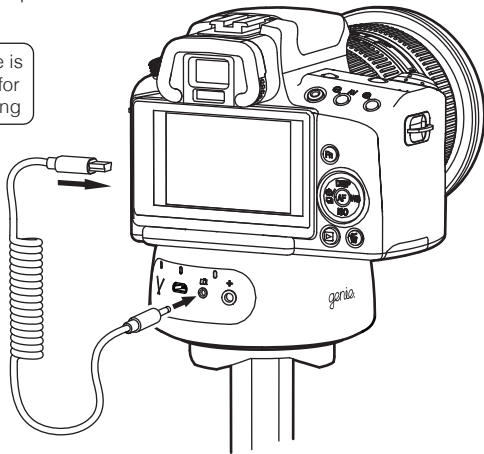

8

### Genie Mini Connect

- 1 Turn bluetooth ON in the settings menu on your device.
- 2 Download the Syrp Genie App and open.
- 3 Press the Syrp cross on the Genie Mini once to turn it on. (Don't hold the Syrp button down)

Flashing LED indicates ready to pair and solid green indicates paired

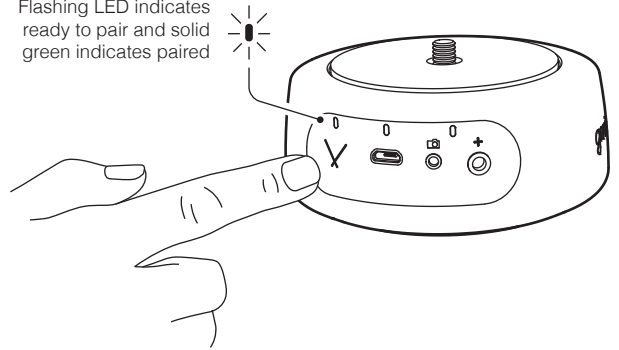

9

### App Connect

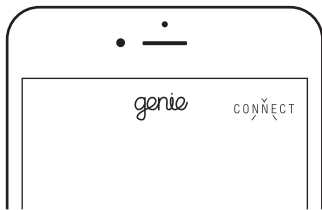

- 1 Tap the CONNECT icon

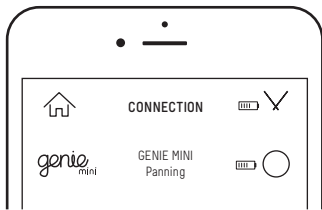

- 2 Select your Genie Mini

10

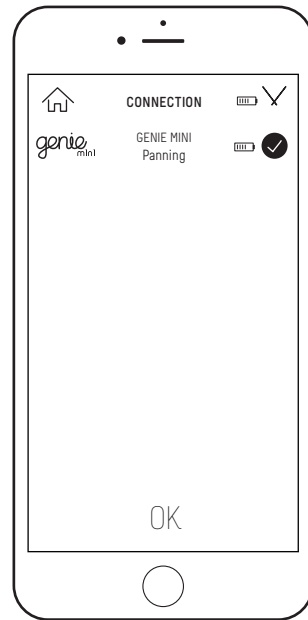

- 3 Tick confirms connection

- 4 Press "OK"

11

### Home Screen

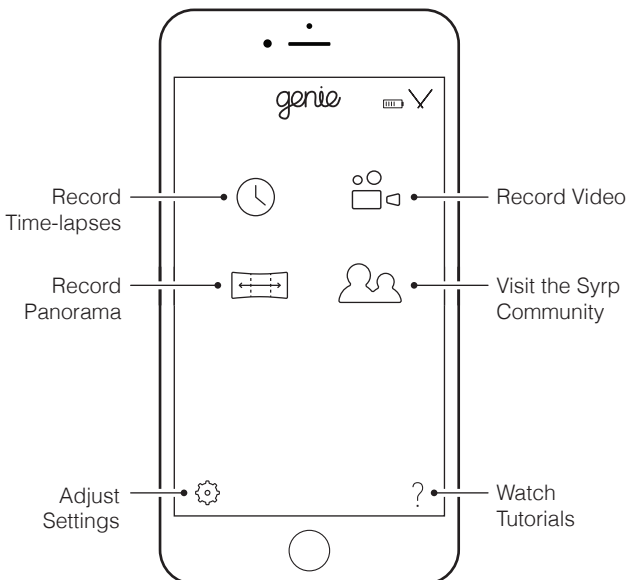

12

### Genie Mini Quick Tips

- Always set your camera and lens to manual focus (MF), if set to Auto Focus (AF) the camera can mis fire leading to missed frames.
- Turn image review OFF on your camera. On some cameras image review can cause missed frames in your time-lapse.
- Once you begin a recording you can leave the App and disconnect, your move will continue to run as normal.
- Press the Syrp button once to turn the Genie Mini on/off. Holding the Syrp button down for longer forces a hardware / firmware reset on the Genie Mini.
- To turn the Genie Mini off you must first disconnect in the connection window on the Syrp Genie App before pressing the Syrp button once.

### Learn More

For tutorials on operating the Genie Mini and navigating the App tap the question mark ? in the bottom right of the App or subscribe to our Youtube Channel.

 [youtube.com/syrp](https://youtube.com/syrp)

 [instagram.com/syrp\\_](https://instagram.com/syrp_)

 [facebook.com/syrp.co.nz](https://facebook.com/syrp.co.nz)

 [twitter.com/syrp\\_](https://twitter.com/syrp_)

 [syrp@syrp.co.nz](mailto:syrp@syrp.co.nz)

 [www.syrp.co.nz](http://www.syrp.co.nz)

### Firmware Tips

The App will automatically alert you if a new firmware update is available and will be installed from within the App. If you have trouble updating the Firmware try these tips:

- Try to update on a different device, if it works you can go back to using your original device.
- Turn WIFI off on your device.
- Do not connect to other bluetooth devices while updating, it's best to turn off other nearby bluetooth devices completely, or the update may fail.
- Try the update from a different location, in some situations unknown interference can cause a failed update.
- If the update fails with a flashing red LED, hold the Syrp button down for 10 sec to reset the Genie Mini. Then quit and reopen the App and reconnect your Genie Mini.